

BASIC WALL LIGHT BRACKET

BASIC WALL CONTAINER

BASIC WALL HEAVY BRACKET

BASIC WALL SCREEN

BASIC WALL BOTTOM SCREEN



BASIC WALL[®]

ABOVE THE GROUND / CONCRETE WALL
BAC-10

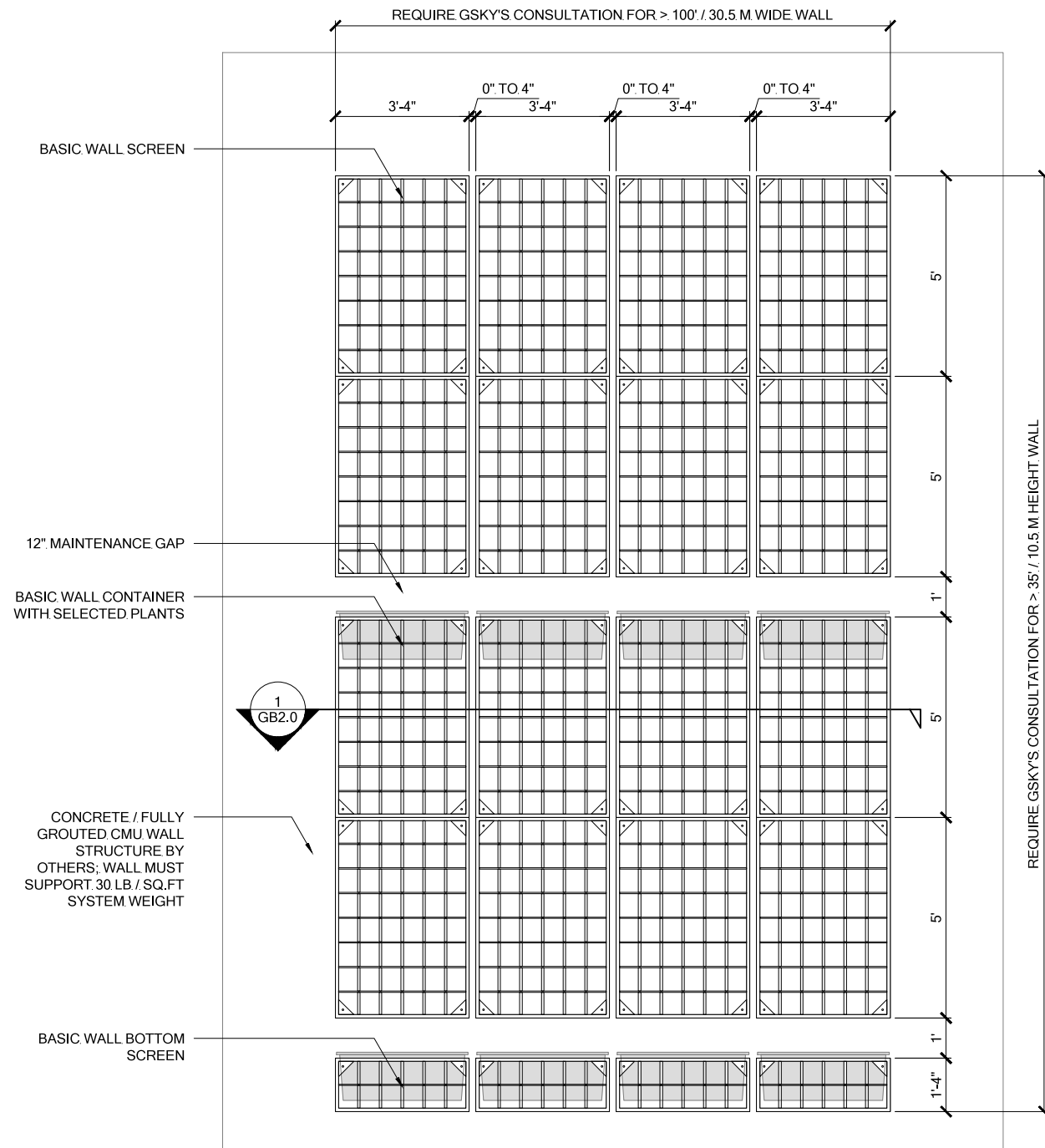

1 ELEVATION
SCALE 1/4" = 1'-0"

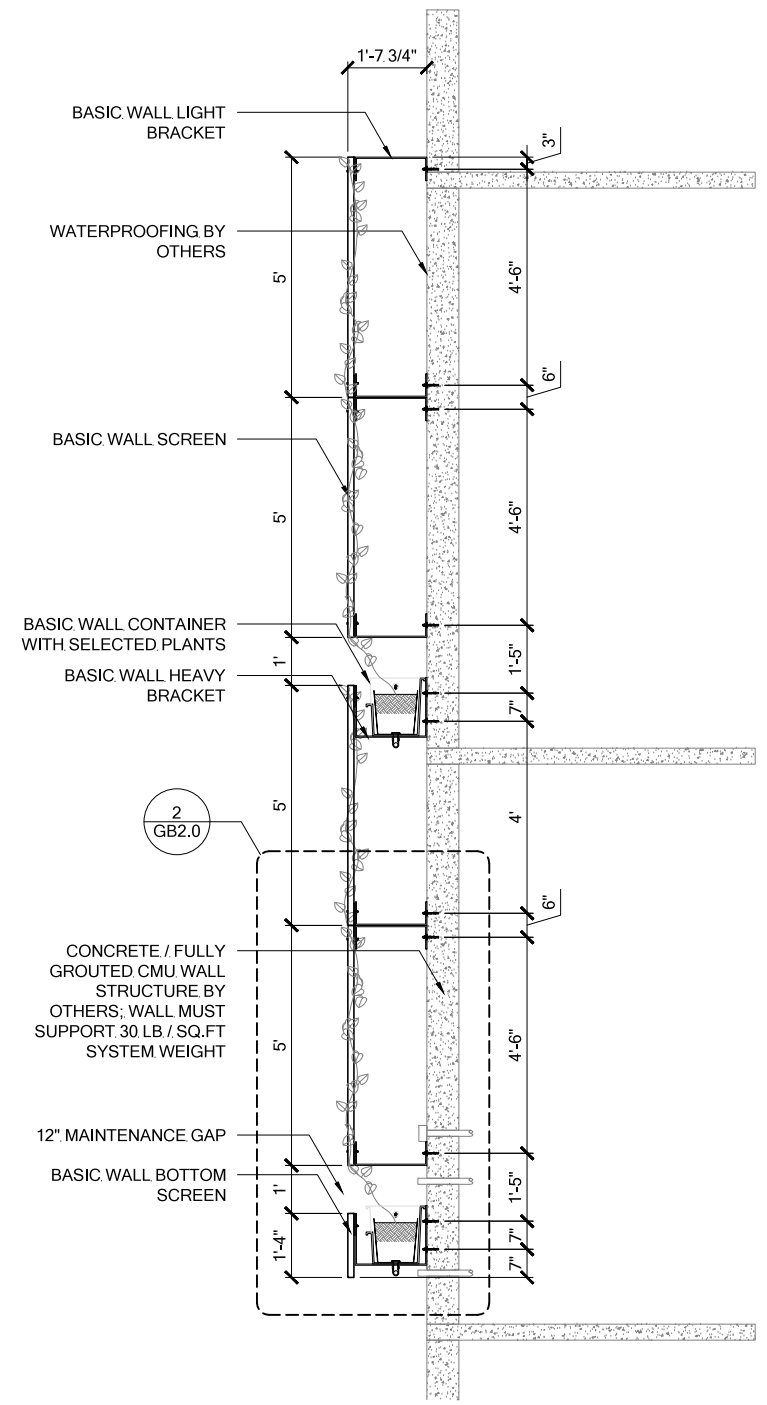

2 SECTION
SCALE 1/4" = 1'-0"



BASIC WALL®
BAC-10 GENERAL OVERVIEW
MAY 9, 2016 11x17" (A3)

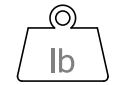

SYSTEM WEIGHT
Basic wall system weight = 30 lb/sq.ft / 1.3 kg/sq.m.



REMOTE ICU

SERVICE			
AUTOMATED	At ICU + WALL	At ICU + WALL	At ICU + WALL

IRRIGATION
Require GSKY's consultation for > 35' / 10.5 m height wall or > 100' / 30.5 m wide wall.

< 8'	OK			
< 13'	OK	OK		
> 13'	OK	OK	OK	OK

MAINT. ACCESS
Walls over 40' / 12m need additional considerations. See GSKY maintenance manual.

GB1.0

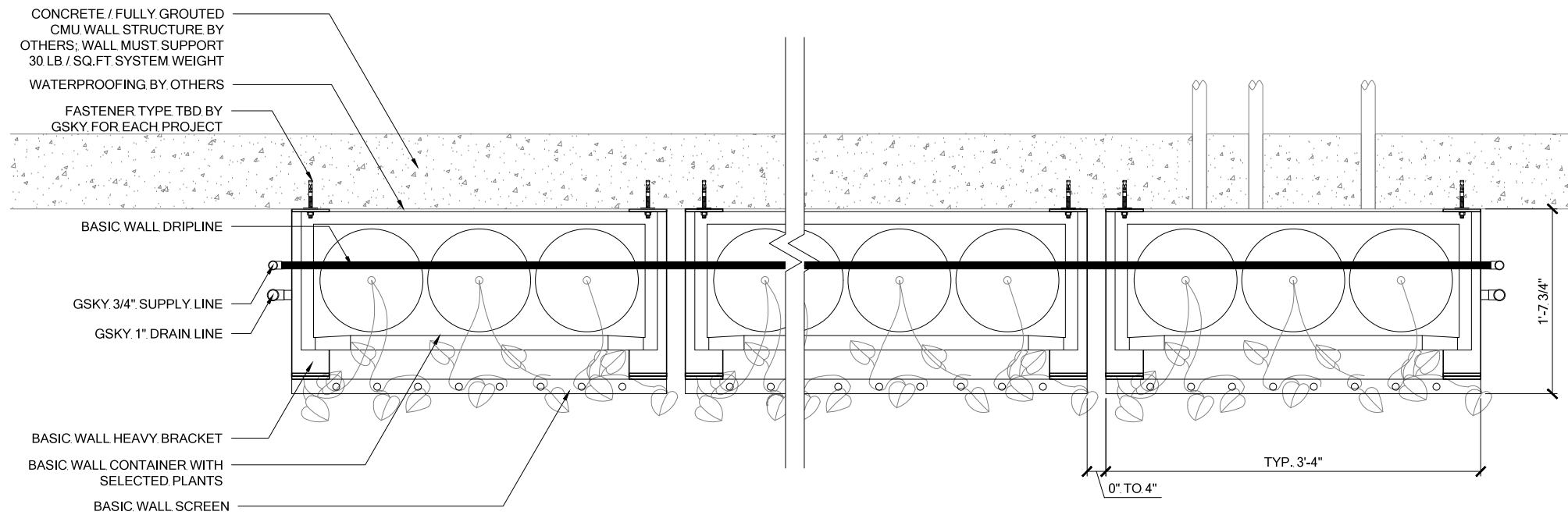

1 PLAN
SCALE 3/4" = 1'-0"

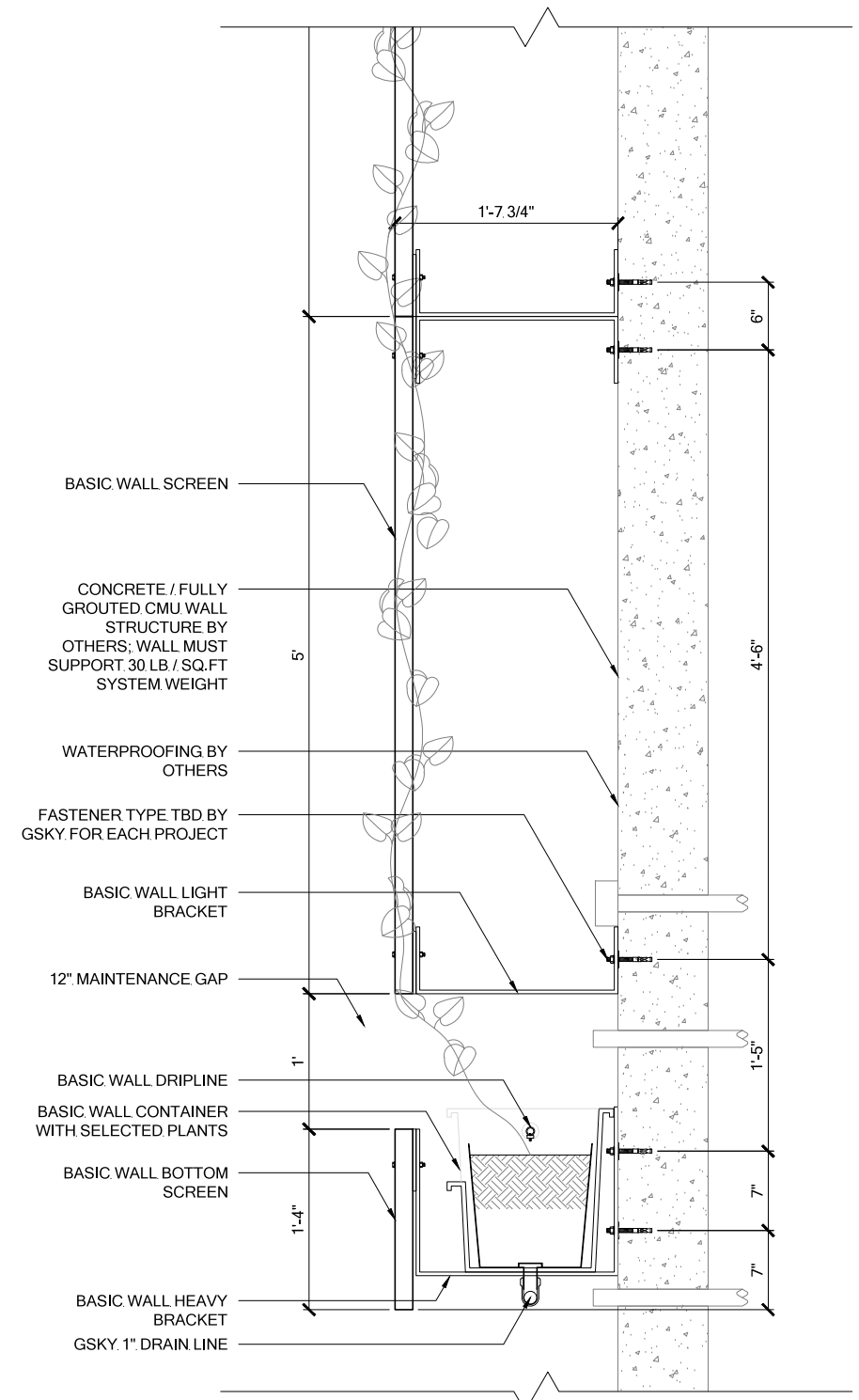

2 SECTION
SCALE 3/4" = 1'-0"



BASIC WALL®

BAC-10 DETAILS

MAY 9, 2016 11x17" (A3)



SYSTEM WEIGHT

Basic wall system weight = 30 lb/sq.ft / 1.3 kg/sq.m.



REMOTE ICU

SERVICE			
AUTOMATED	At ICU + WALL	At ICU + WALL	At ICU + WALL

IRRIGATION

Require GSKy's consultation for: > 35' / 10.5 m height wall or > 100' / 30.5 m wide wall.

< 8'	OK			
< 13'	OK	OK		
> 13'	OK	OK	OK	OK

MAINT. ACCESS

Walls over 40' / 12m need additional considerations. See GSKy maintenance manual.

GB2.0

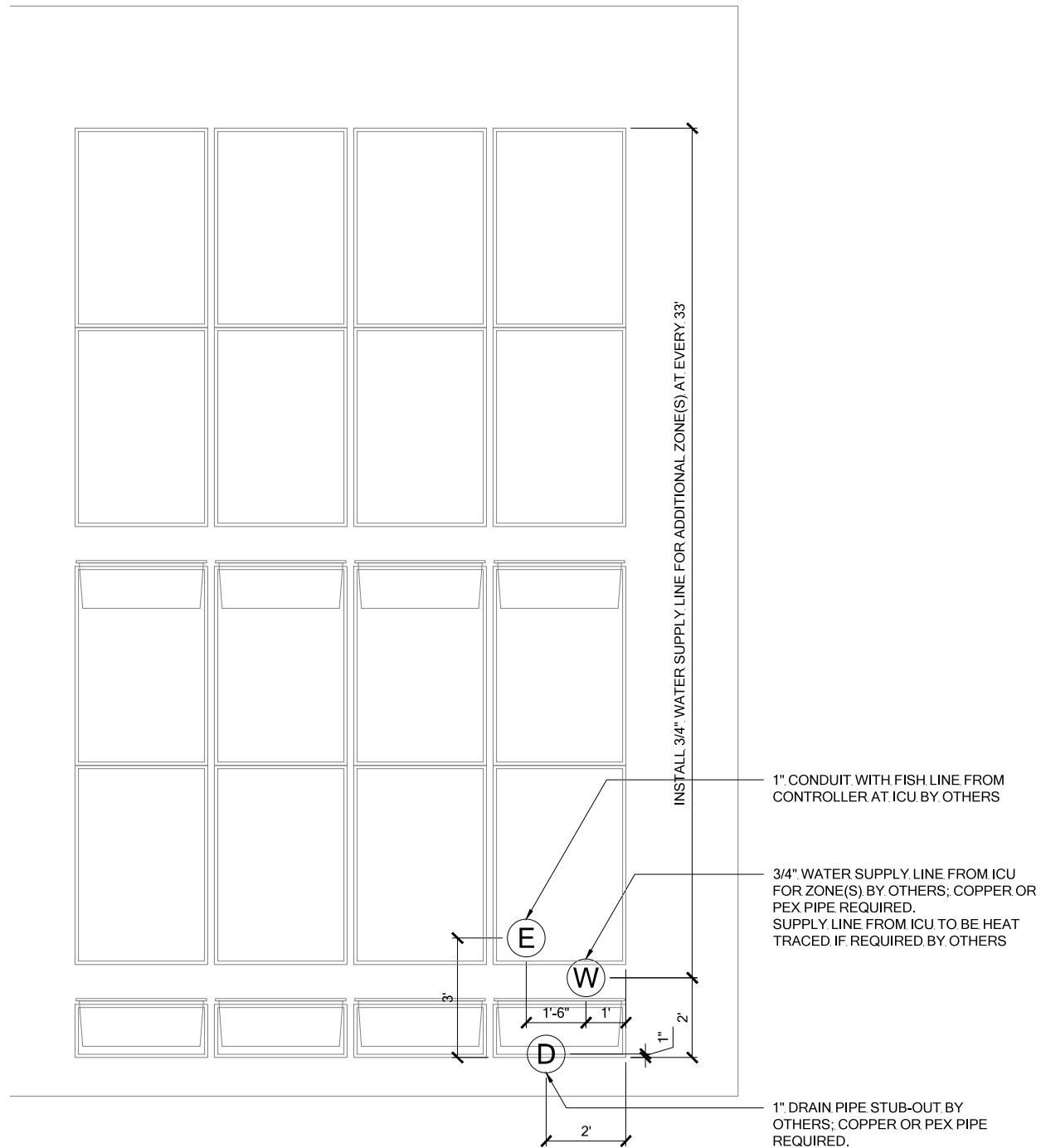

1 ELEVATION
SCALE 1/4" = 1'-0"

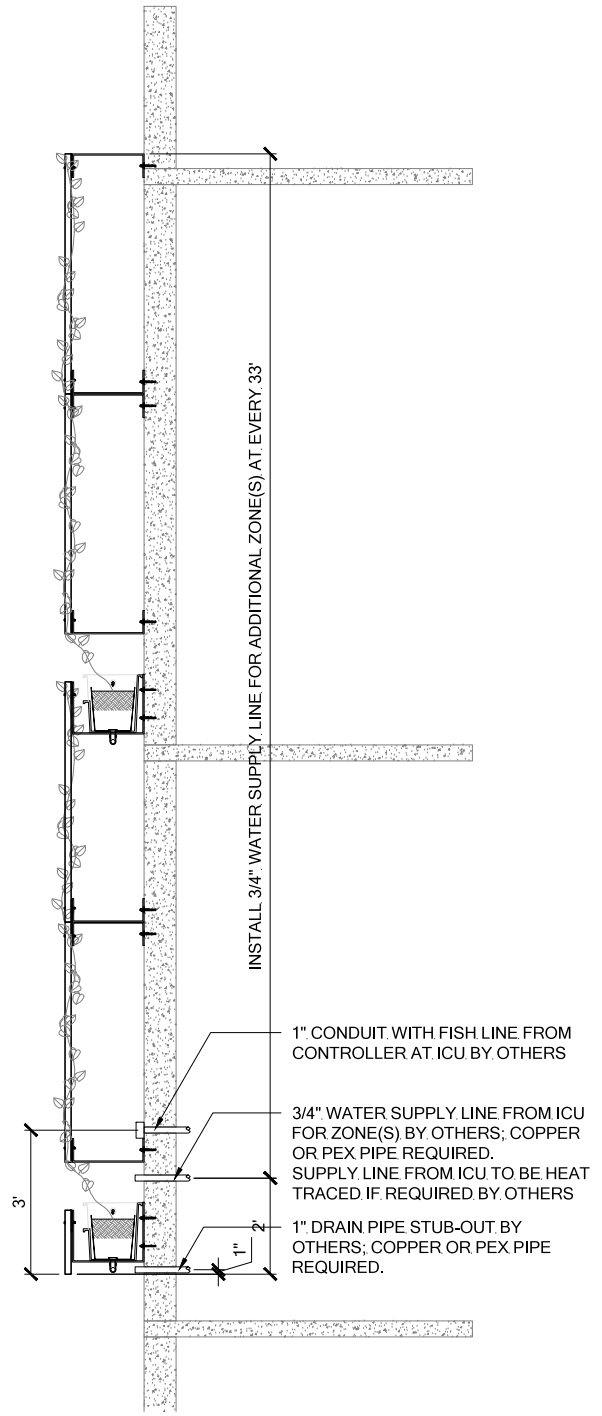

2 SECTION
SCALE 1/4" = 1'-0"

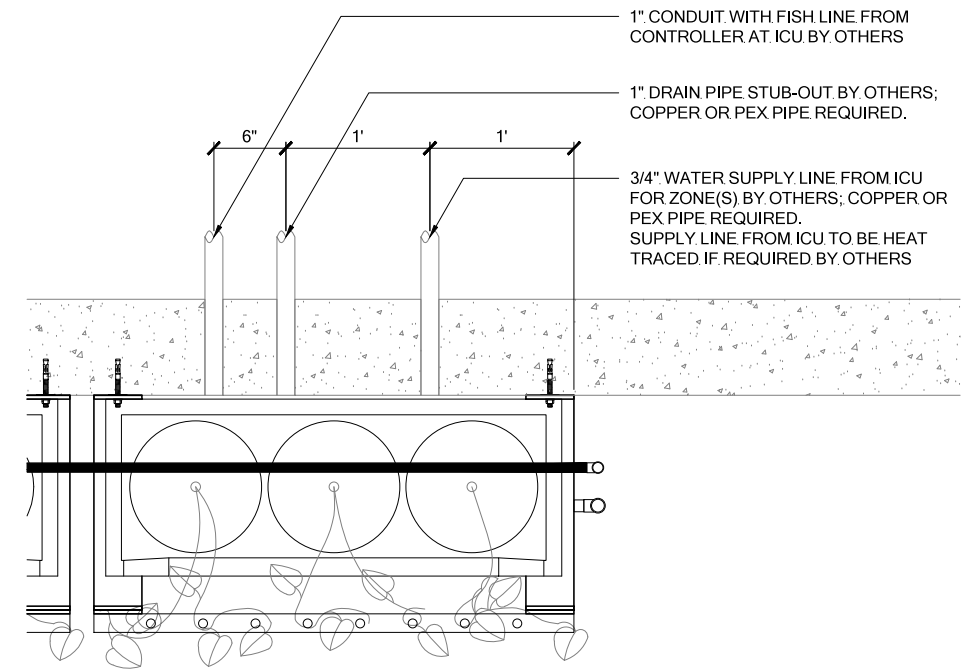

3 PLAN
SCALE 3/4" = 1'-0"



BASIC WALL®
BAC-10 IRRIGATION OVERVIEW
MAY 9, 2016 11x17" (A3)

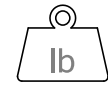

SYSTEM WEIGHT
Basic wall system weight
= 30 lb/sq.ft / 1.3 kg/sq.m.



REMOTE ICU

SERVICE			
AUTOMATED	At ICU + WALL	At ICU + WALL	At ICU + WALL

IRRIGATION
Require GSky's consultation
for > 35' / 10.5 m height wall
or > 100' / 30.5 m wide wall.

< 8'	OK			
< 13'	OK	OK		
> 13'	OK	OK	OK	OK

MAINT. ACCESS
Walls over 40' / 12m need additional
considerations. See GSky
maintenance manual.

GB3.0

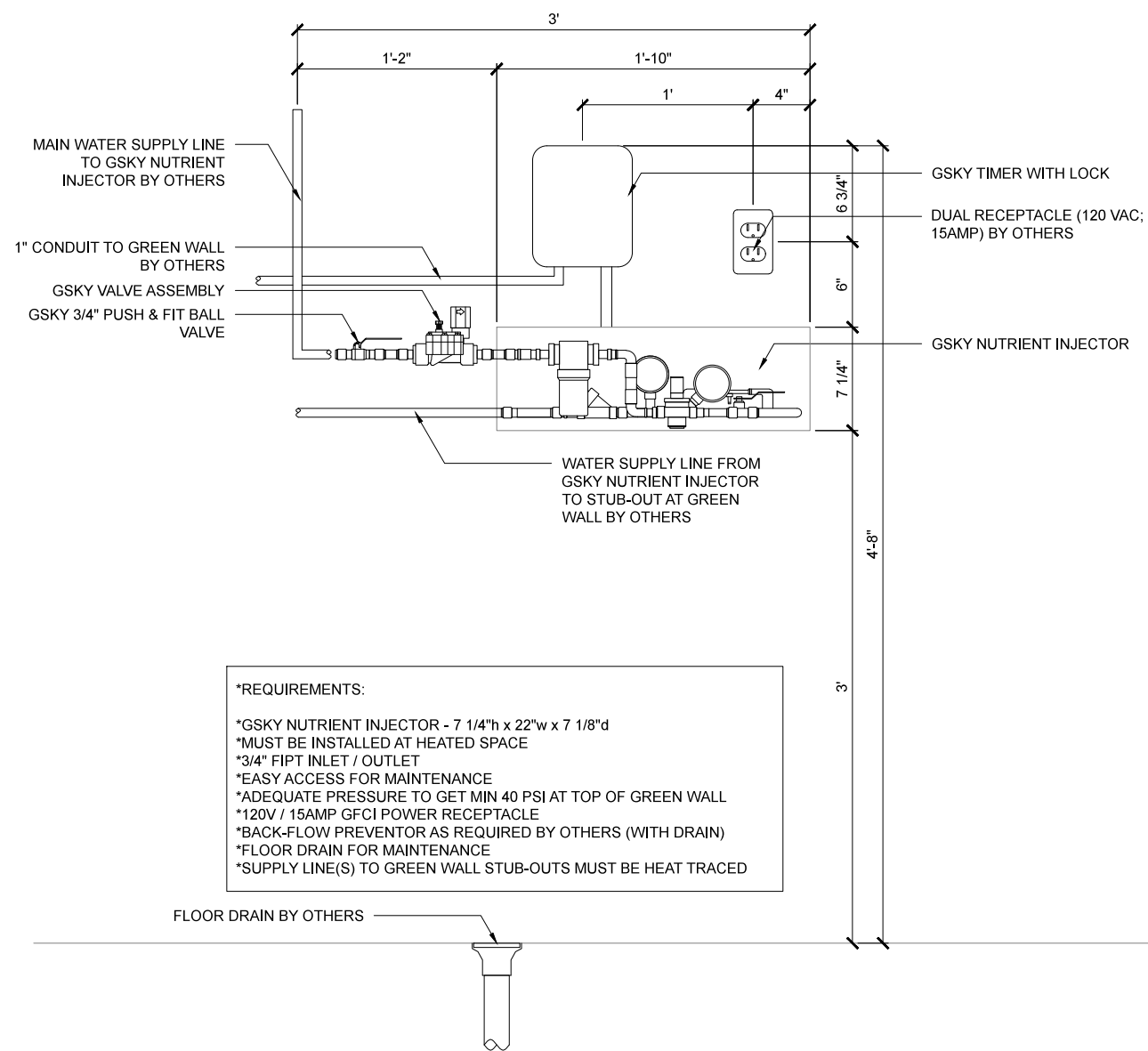

***REQUIREMENTS:**
 *GSKY NUTRIENT INJECTOR - 7 1/4"h x 22"w x 7 1/8"d
 *MUST BE INSTALLED AT HEATED SPACE
 *3/4" FIPT INLET / OUTLET
 *EASY ACCESS FOR MAINTENANCE
 *ADEQUATE PRESSURE TO GET MIN 40 PSI AT TOP OF GREEN WALL
 *120V / 15AMP GFCI POWER RECEPTACLE
 *BACK-FLOW PREVENTOR AS REQUIRED BY OTHERS (WITH DRAIN)
 *FLOOR DRAIN FOR MAINTENANCE
 *SUPPLY LINE(S) TO GREEN WALL STUB-OUTS MUST BE HEAT TRACED

1 SINGLE ZONE - ELEVATION
 SCALE 1" = 1'-0"

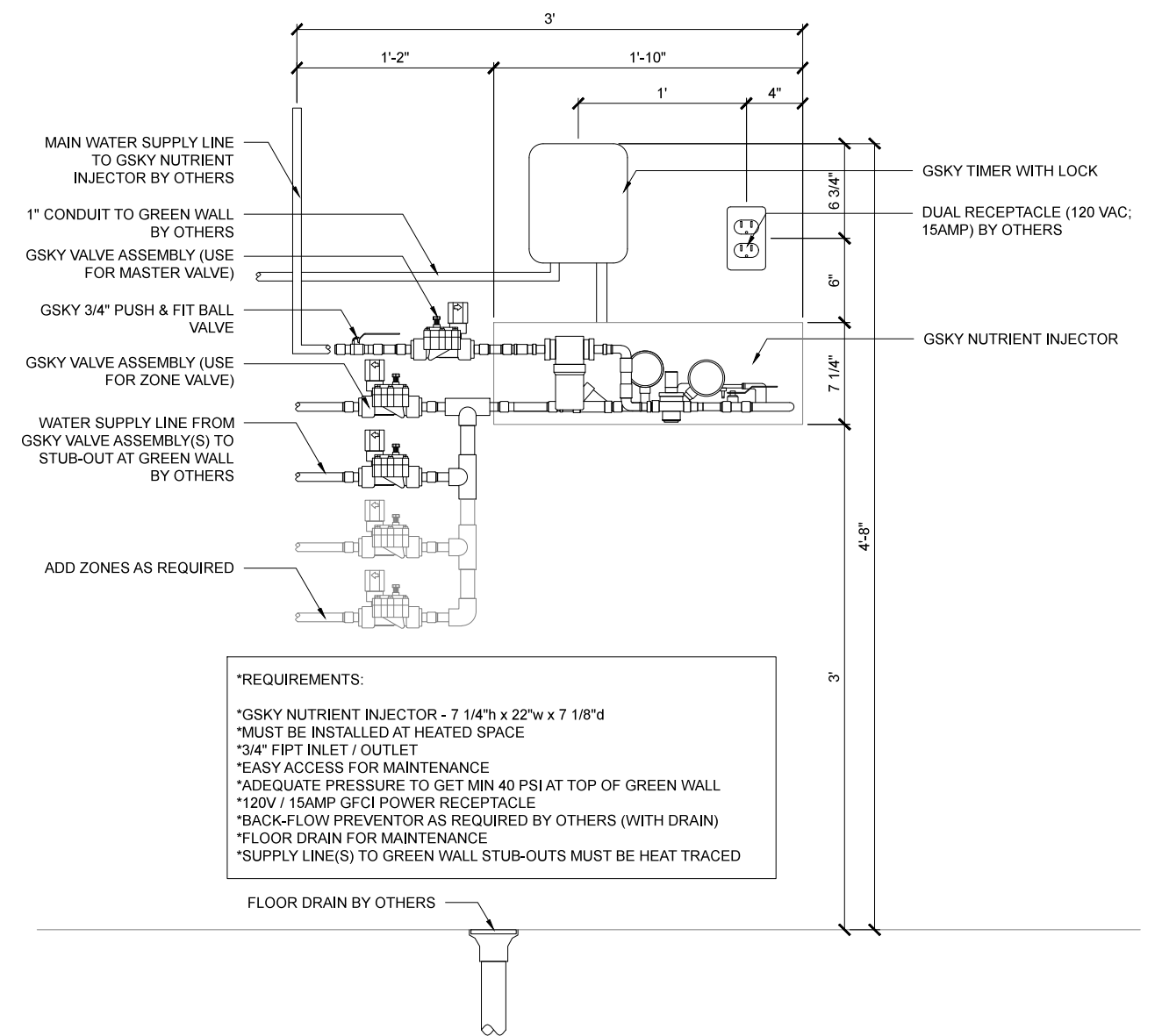

***REQUIREMENTS:**
 *GSKY NUTRIENT INJECTOR - 7 1/4"h x 22"w x 7 1/8"d
 *MUST BE INSTALLED AT HEATED SPACE
 *3/4" FIPT INLET / OUTLET
 *EASY ACCESS FOR MAINTENANCE
 *ADEQUATE PRESSURE TO GET MIN 40 PSI AT TOP OF GREEN WALL
 *120V / 15AMP GFCI POWER RECEPTACLE
 *BACK-FLOW PREVENTOR AS REQUIRED BY OTHERS (WITH DRAIN)
 *FLOOR DRAIN FOR MAINTENANCE
 *SUPPLY LINE(S) TO GREEN WALL STUB-OUTS MUST BE HEAT TRACED

2 MULTI-ZONE - ELEVATION
 SCALE 1" = 1'-0"



BASIC WALL®
 BAC-10 IRRIGATION SYSTEM
 MAY 9, 2016 11x17" (A3)

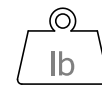

SYSTEM WEIGHT
 Basic wall system weight
 = 30 lb/sq.ft / 1.3 kg/sq.m.



REMOTE ICU

SERVICE			
AUTOMATED	At ICU + WALL	At ICU + WALL	At ICU + WALL

IRRIGATION
 Require Gsky's consultation for
 for > 35' / 10.5 m height wall
 or > 100' / 30.5 m wide wall.

< 8'	OK			
< 13'	OK	OK		
> 13'	OK	OK	OK	OK

MAINT. ACCESS
 Walls over 40' / 12m need additional
 considerations. See Gsky
 maintenance manual.

GB3.1