

RECESSED WALL BY OTHERS

WATERPROOFING BY OTHERS

3/4" BACKING BY OTHERS

VERSA DRIPLINE

GSKY 3/4" SUPPLY LINE

GSKY VERSA XT TRAYS

GSKY NUTRIENT INJECTOR

DRAINAGE AREA



VERSA WALL® XT™

TO THE GROUND / BACKING OPTION
XTB-NN

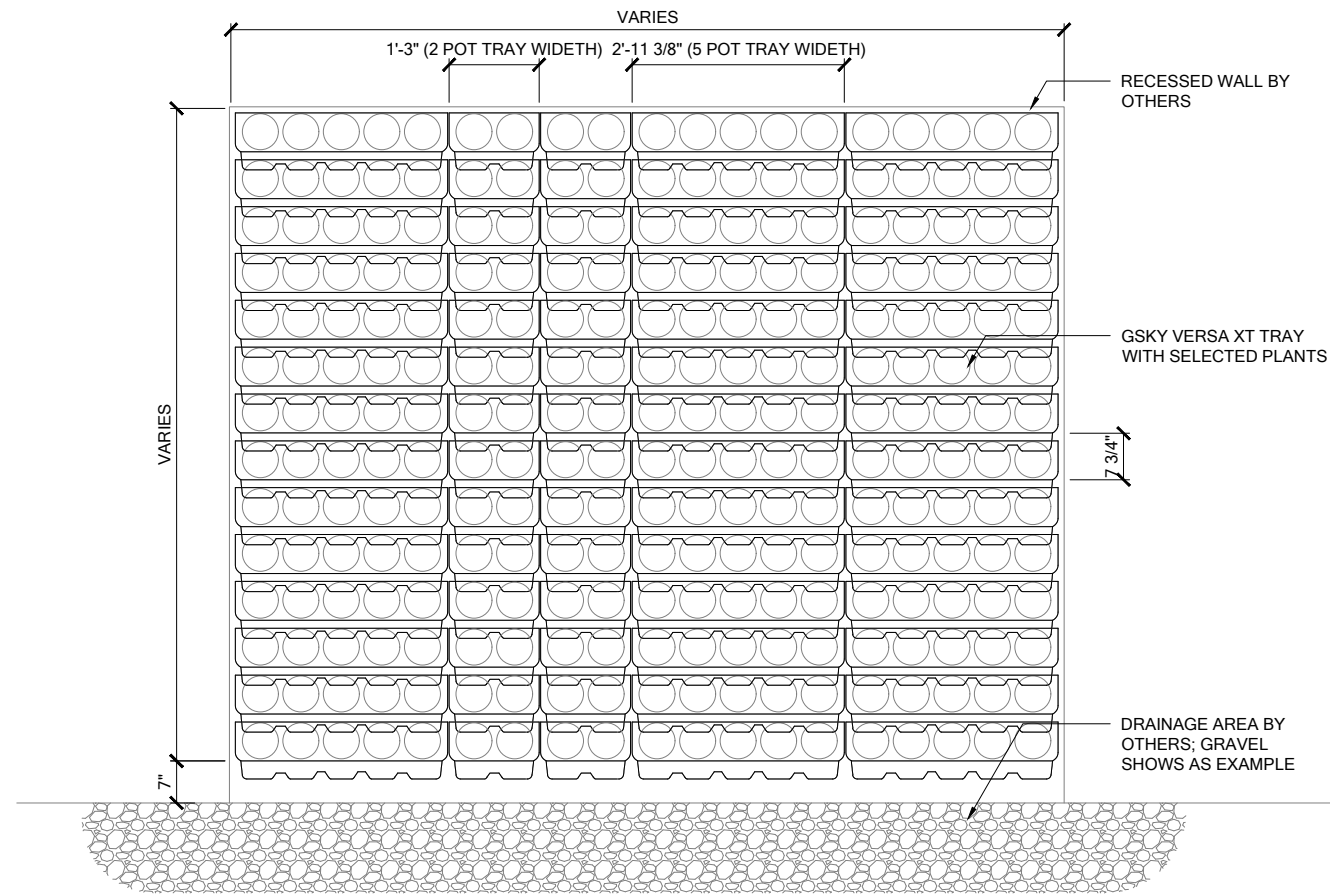

1 ELEVATION
SCALE 3/8" = 1'-0"

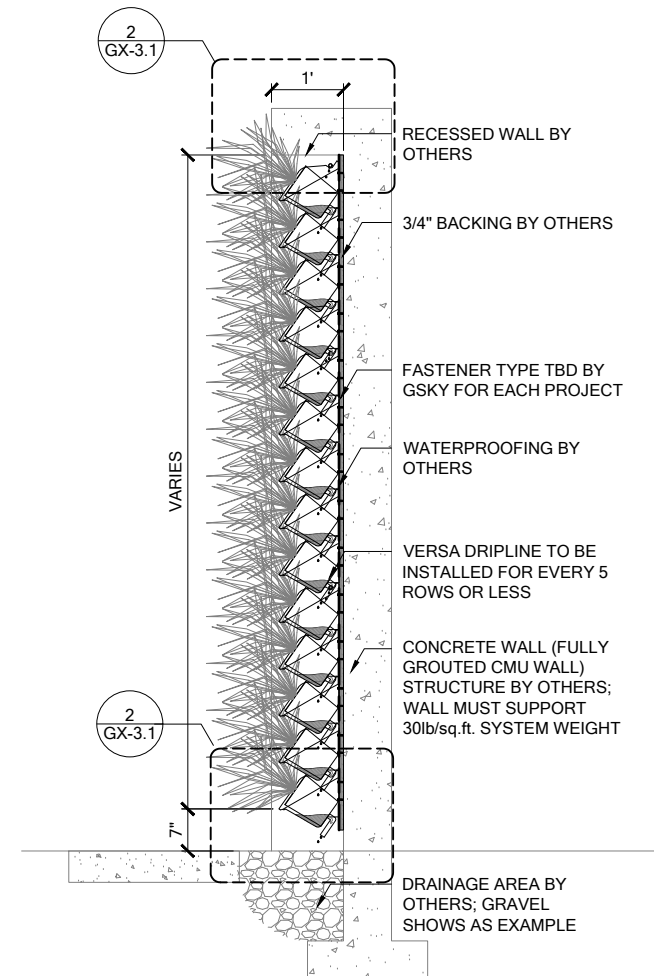

3 SECTION
SCALE 3/8" = 1'-0"

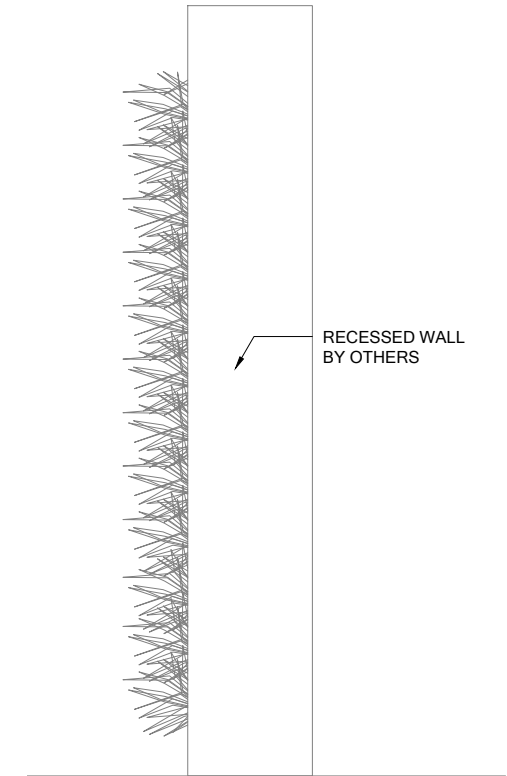

4 SIDE
SCALE 3/8" = 1'-0"

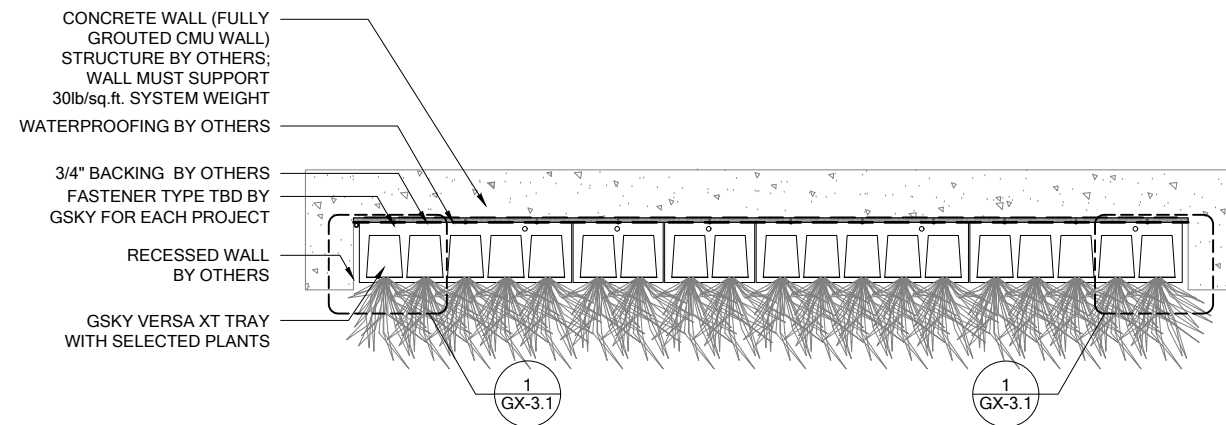

2 PLAN
SCALE 3/8" = 1'-0"



VERSA WALL[®] XT[™]

XTB-NN GENERAL OVERVIEW

VER. 1.1

11x17" (A3)



SYSTEM WEIGHT

Versa XT wall system weight
= 30 lb/sq.ft / 1.3 kg/sq.m.

n/a	SIDE/TOP
n/a	BOTTOM

TRIM

SS brushed finish or powder coated aluminum
See gsky.com for details.



REMOTE ICU

SERVICE			
AUTOMATED	At ICU + WALL	At ICU + WALL	At ICU + WALL

IRRIGATION

Require GSKY's consultation for > 35' / 10.5 m height wall or > 100' / 30.5 m wide wall.

< 8'	OK			
< 13'	OK	OK		
> 13'		OK	OK	OK

MAINT. ACCESS

Walls over 40' / 12m need additional considerations. See GSKY maintenance manual.

GX1.0

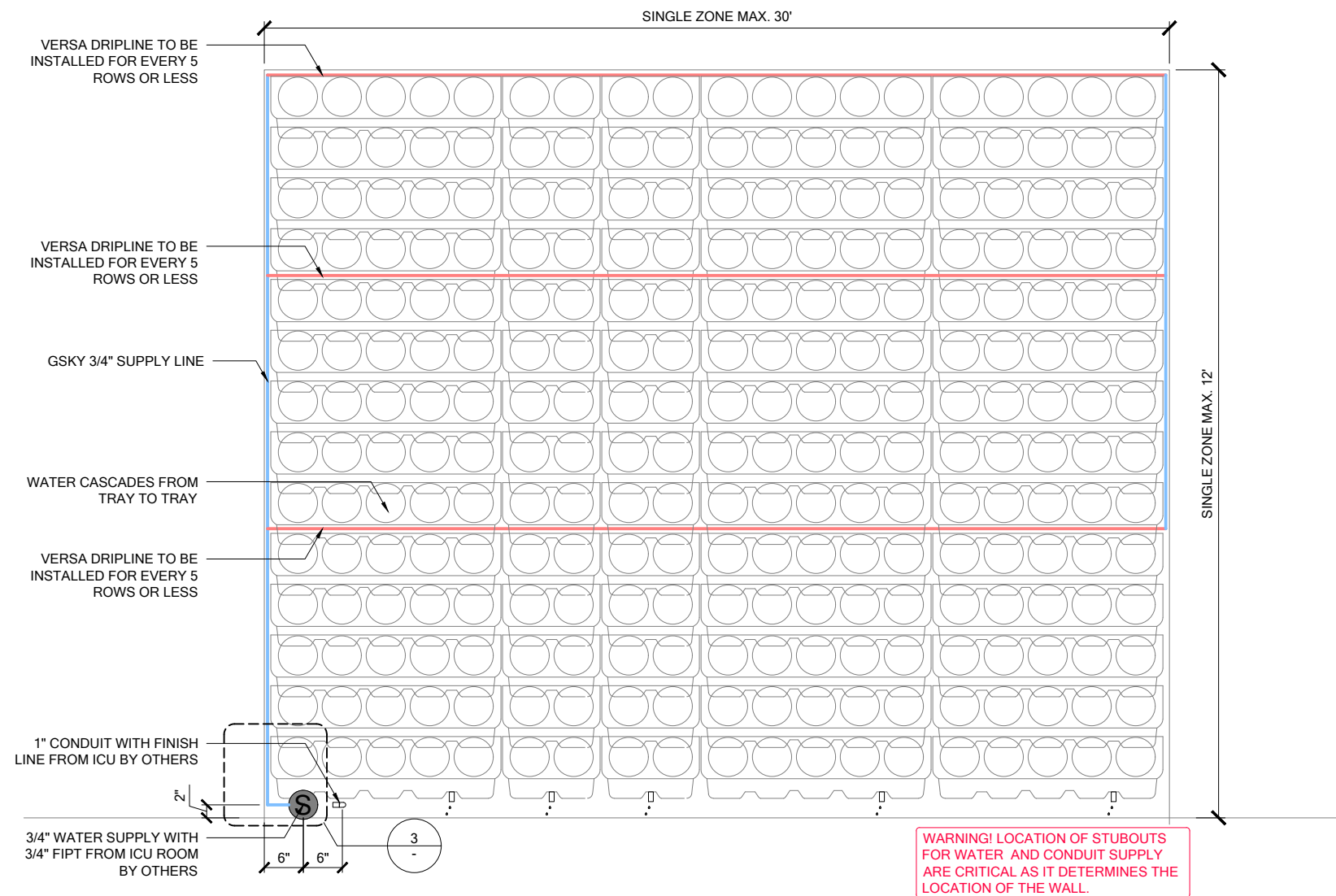

1 ELEVATION
SCALE 1/2" = 1'-0"

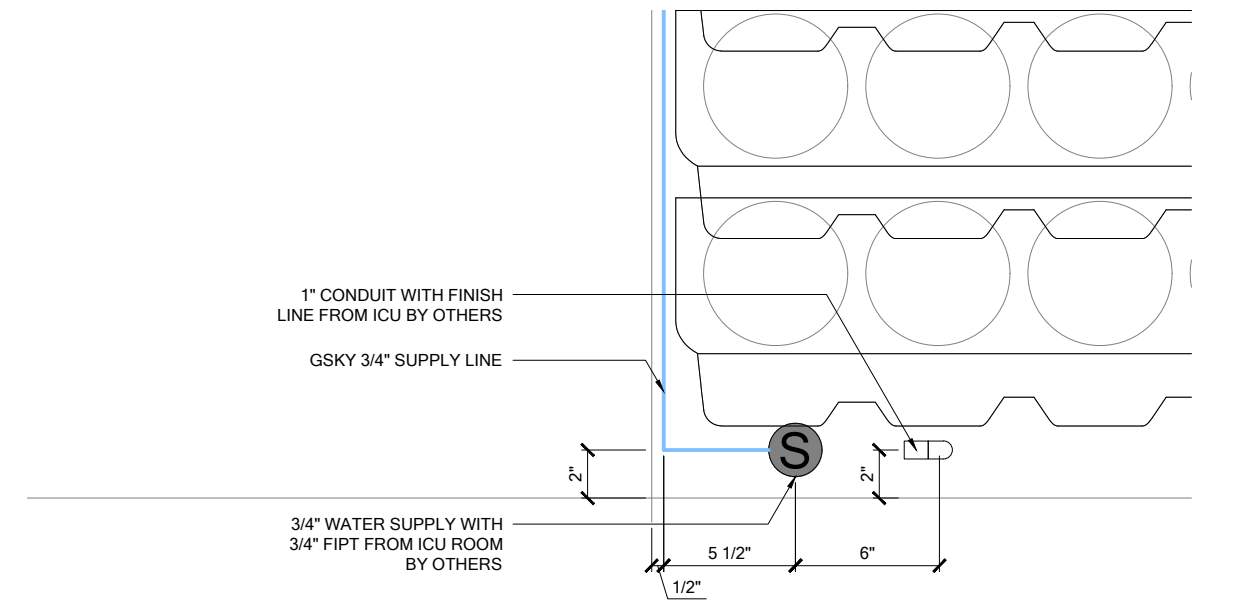

3 ELEVATION DETAIL
SCALE 1 1/2" = 1'-0"

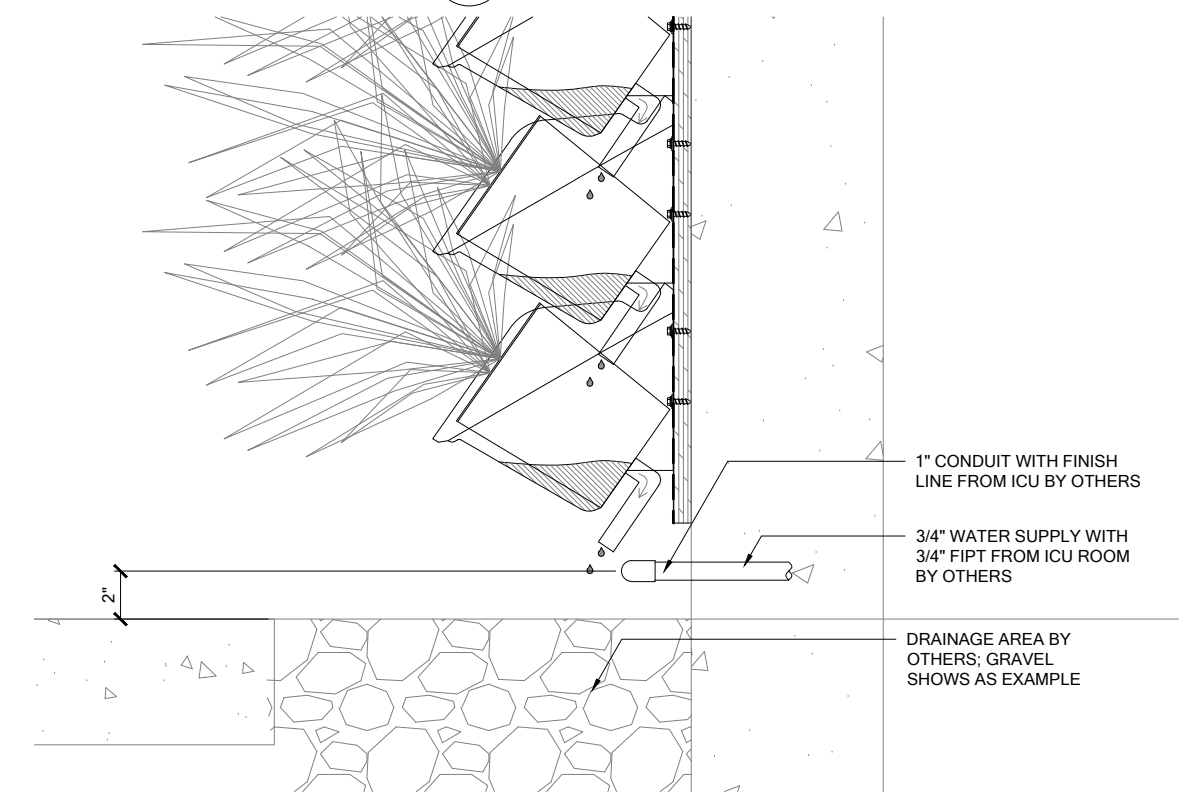

2 SECTION
SCALE 1 1/2" = 1'-0"

WARNING! LOCATION OF STUBOUTS FOR WATER AND CONDUIT SUPPLY ARE CRITICAL AS IT DETERMINES THE LOCATION OF THE WALL.



VERSA WALL[®] XT[™]

XTB-NN IRRIGATION OVERVIEW

VER. 1.1 11x17" (A3)

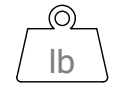

SYSTEM WEIGHT

Versa XT wall system weight = 30 lb/sq.ft / 1.3 kg/sq.m.

n/a	SIDE/TOP
n/a	BOTTOM

TRIM

SS brushed finish or powder coated aluminum
See gsky.com for details.



REMOTE ICU

SERVICE			
AUTOMATED	At ICU + WALL	At ICU + WALL	At ICU + WALL

IRRIGATION

Require GSKy's consultation for > 35' / 10.5 m height wall or > 100' / 30.5 m wide wall.

HEIGHT				
< 8'	OK			
< 13'	OK	OK		
> 13'	OK	OK	OK	

MAINT. ACCESS

Walls over 40' / 12m need additional considerations. See GSKy maintenance manual.

GX2.0

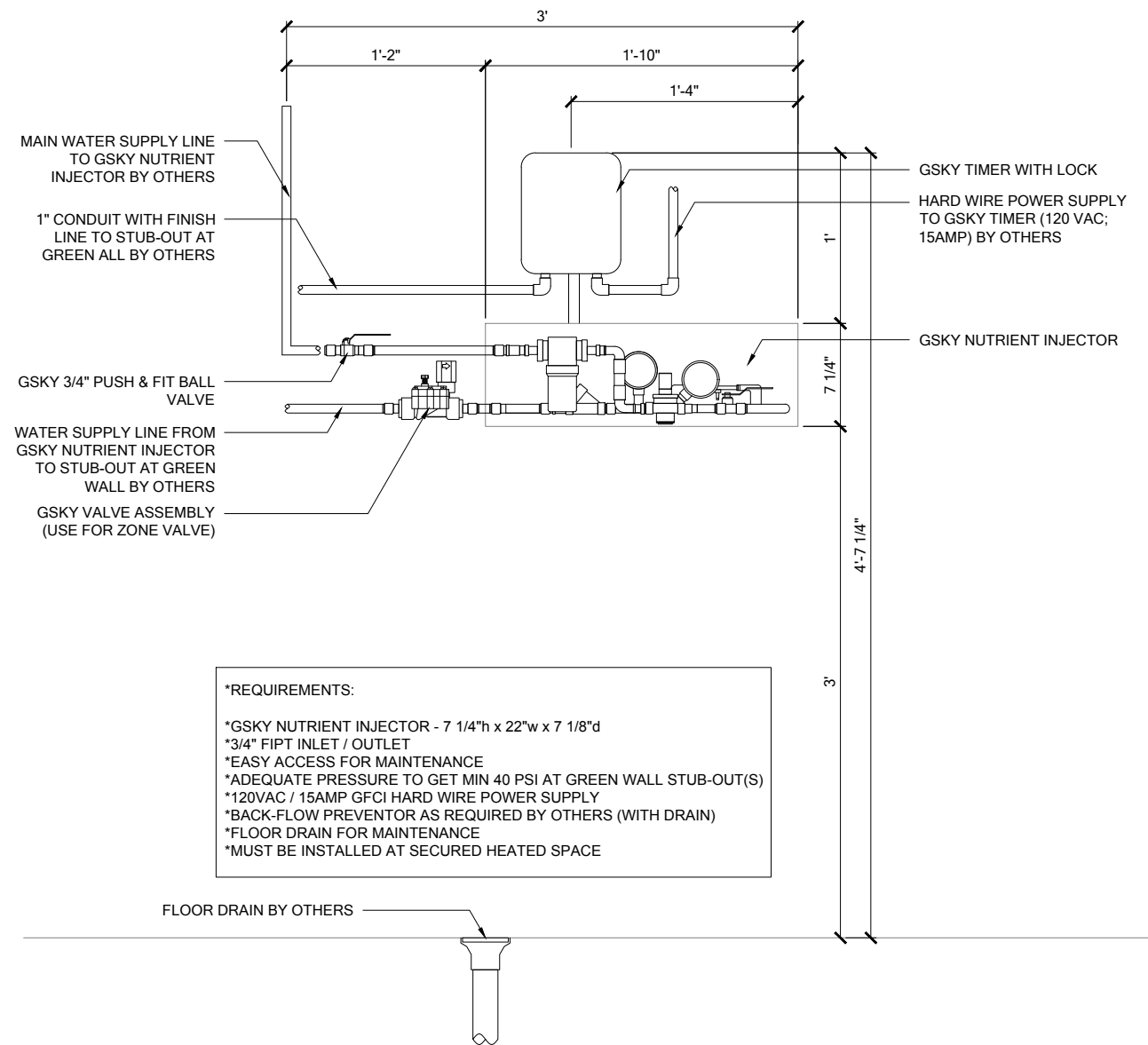

***REQUIREMENTS:**
 *GSKY NUTRIENT INJECTOR - 7 1/4"h x 22"w x 7 1/8"d
 *3/4" FIPT INLET / OUTLET
 *EASY ACCESS FOR MAINTENANCE
 *ADEQUATE PRESSURE TO GET MIN 40 PSI AT GREEN WALL STUB-OUT(S)
 *120VAC / 15AMP GFCI HARD WIRE POWER SUPPLY
 *BACK-FLOW PREVENTOR AS REQUIRED BY OTHERS (WITH DRAIN)
 *FLOOR DRAIN FOR MAINTENANCE
 *MUST BE INSTALLED AT SECURED HEATED SPACE

1 SINGLE ZONE - ELEVATION
 SCALE 1 1/2" = 1'-0"

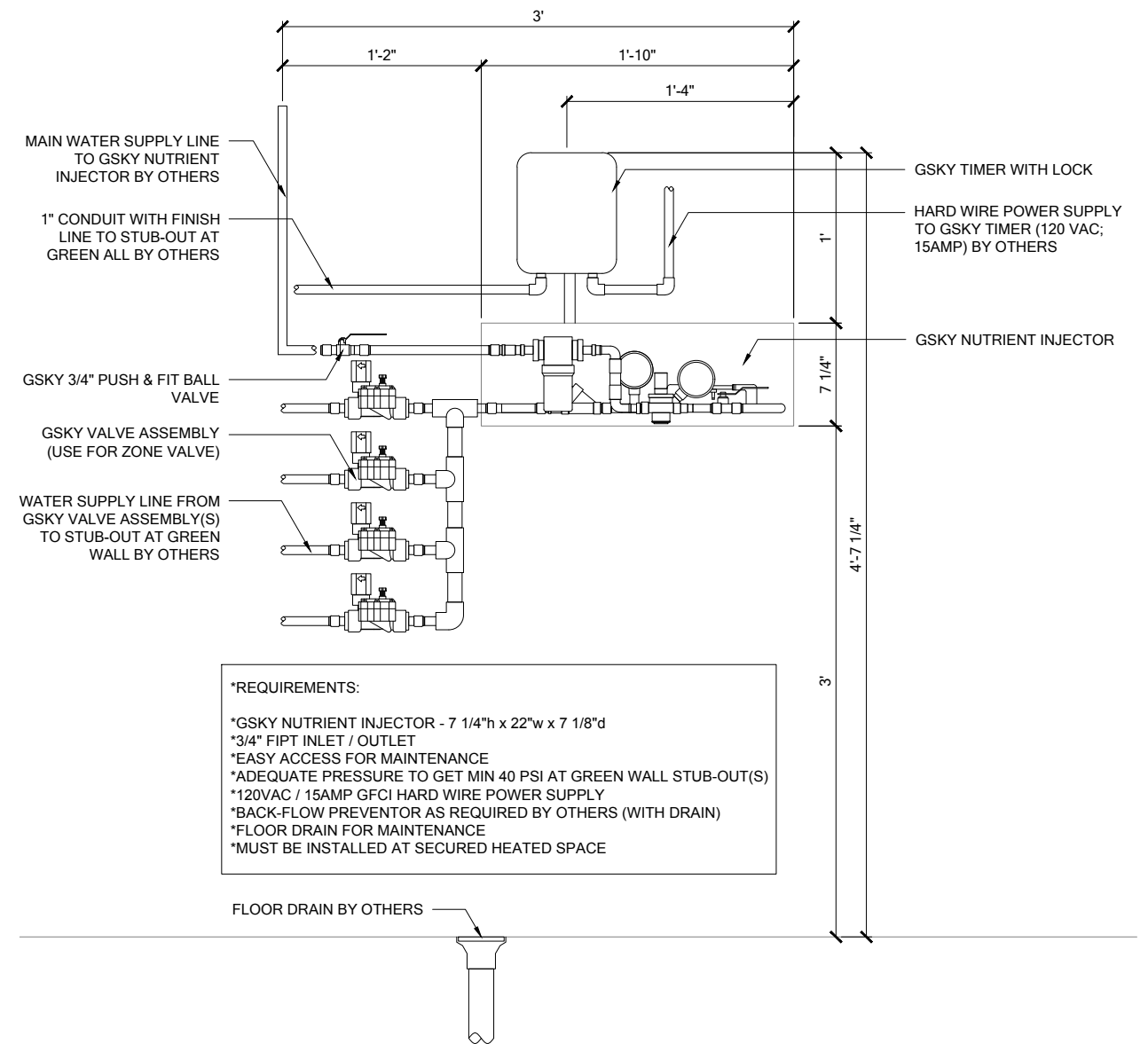

***REQUIREMENTS:**
 *GSKY NUTRIENT INJECTOR - 7 1/4"h x 22"w x 7 1/8"d
 *3/4" FIPT INLET / OUTLET
 *EASY ACCESS FOR MAINTENANCE
 *ADEQUATE PRESSURE TO GET MIN 40 PSI AT GREEN WALL STUB-OUT(S)
 *120VAC / 15AMP GFCI HARD WIRE POWER SUPPLY
 *BACK-FLOW PREVENTOR AS REQUIRED BY OTHERS (WITH DRAIN)
 *FLOOR DRAIN FOR MAINTENANCE
 *MUST BE INSTALLED AT SECURED HEATED SPACE

2 MULTI-ZONE - ELEVATION
 SCALE 1 1/2" = 1'-0"



VERSA WALL[®] XT[™]

XTB-NN IRRIGATION SYSTEM

VER. 1.1

11x17" (A3)



SYSTEM WEIGHT

Versa XT wall system weight
 = 30 lb/sq.ft / 1.3 kg/sq.m.

n/a SIDE/TOP

n/a BOTTOM

TRIM

SS brushed finish or
 powder coated aluminum
 See gsky.com for details.



REMOTE ICU

SERVICE			
AUTOMATED	At ICU + WALL	At ICU + WALL	At ICU + WALL

IRRIGATION

Require GSKy's consultation for
 > 35' / 10.5 m height wall
 or > 100' / 30.5 m wide wall.

< 8'	OK			
< 13'	OK	OK		
> 13'		OK	OK	OK

MAINT. ACCESS

Walls over 40' / 12m need additional
 considerations. See GSKy
 maintenance manual.

GX2.1

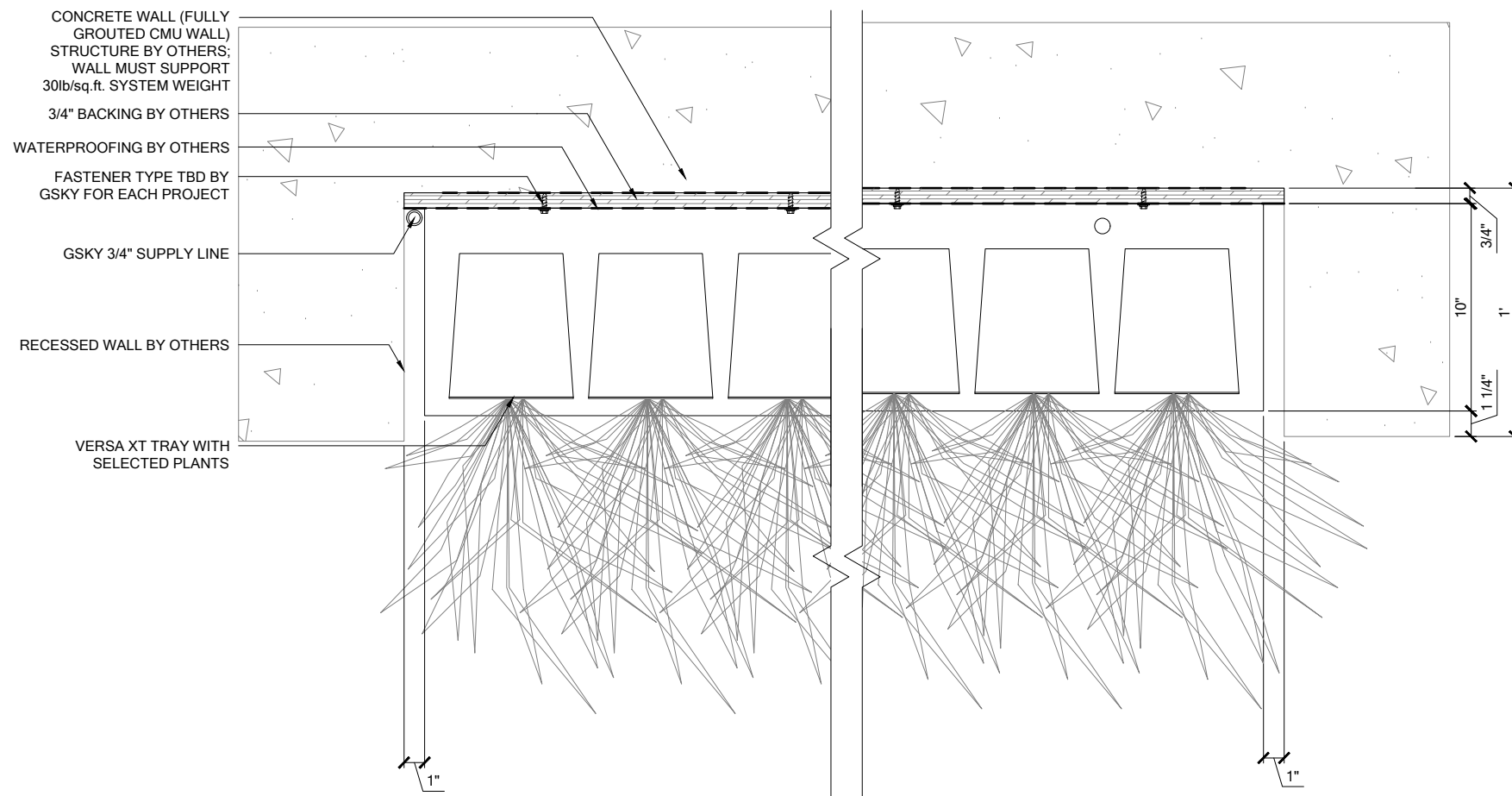

1 PLAN DETAIL
SCALE 1 1/2" = 1'-0"

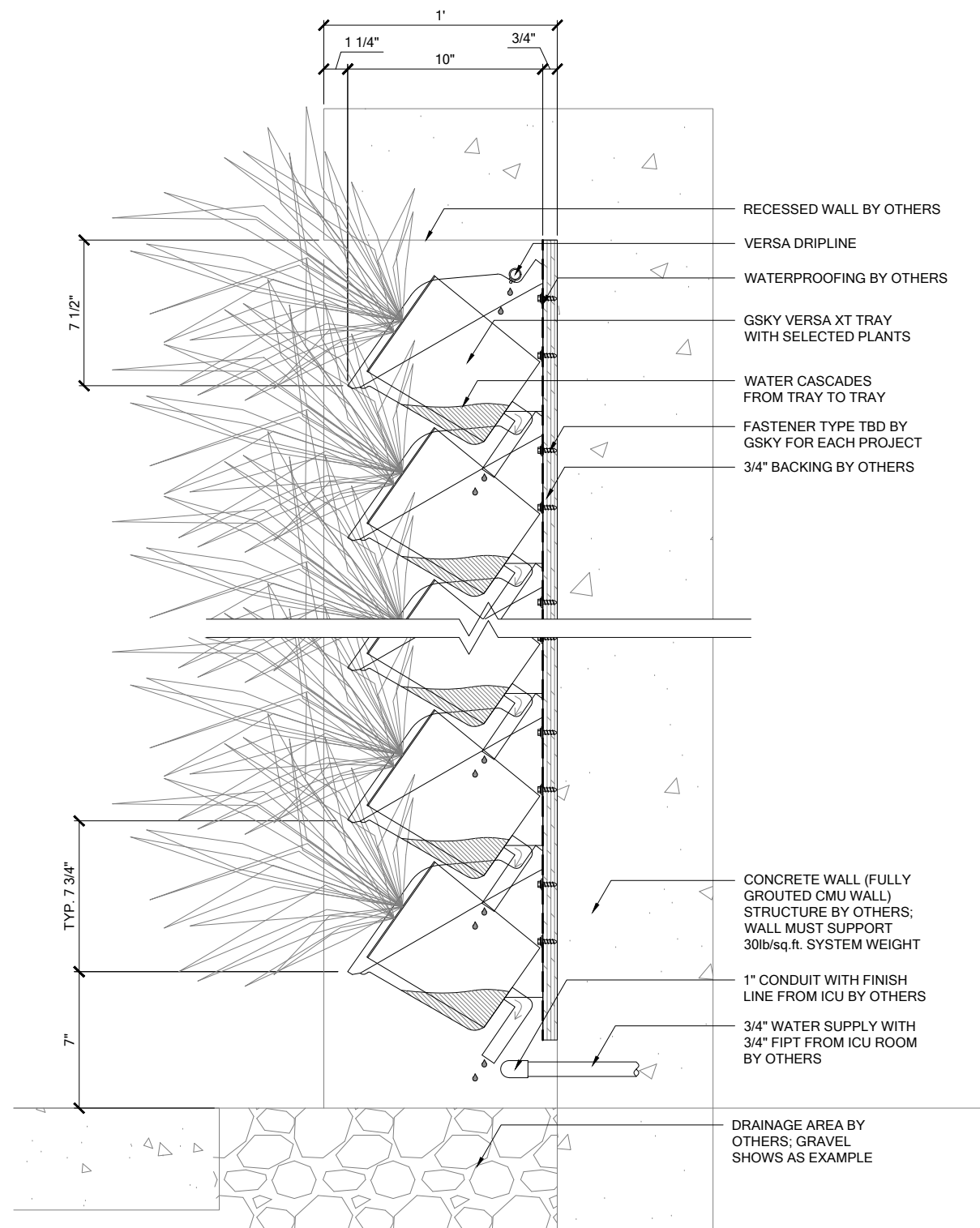

2 SECTION DETAIL
SCALE 1 1/2" = 1'-0"



VERSA WALL[®] XT[™]

XTB-NN DETAILS

VER. 1.1 11x17" (A3)

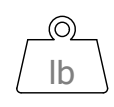

SYSTEM WEIGHT
Versa XT wall system weight
= 30 lb/sq.ft / 1.3 kg/sq.m.

n/a	SIDE/TOP
n/a	BOTTOM

TRIM
SS brushed finish or
powder coated aluminum
See gsky.com for details.

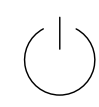

REMOTE ICU

SERVICE			
AUTOMATED	At ICU + WALL	At ICU + WALL	At ICU + WALL

IRRIGATION
Require GSKy's consultation for
> 35' / 10.5 m height wall
or > 100' / 30.5 m wide wall.

< 8'	OK			
< 13'	OK	OK		
> 13'		OK	OK	OK

MAINT. ACCESS
Walls over 40' / 12m need additional
considerations. See GSKy
maintenance manual.

GX3.0