

VERSA WALL®
 TO THE FLOOR / HOSE WATER
 VTM-72

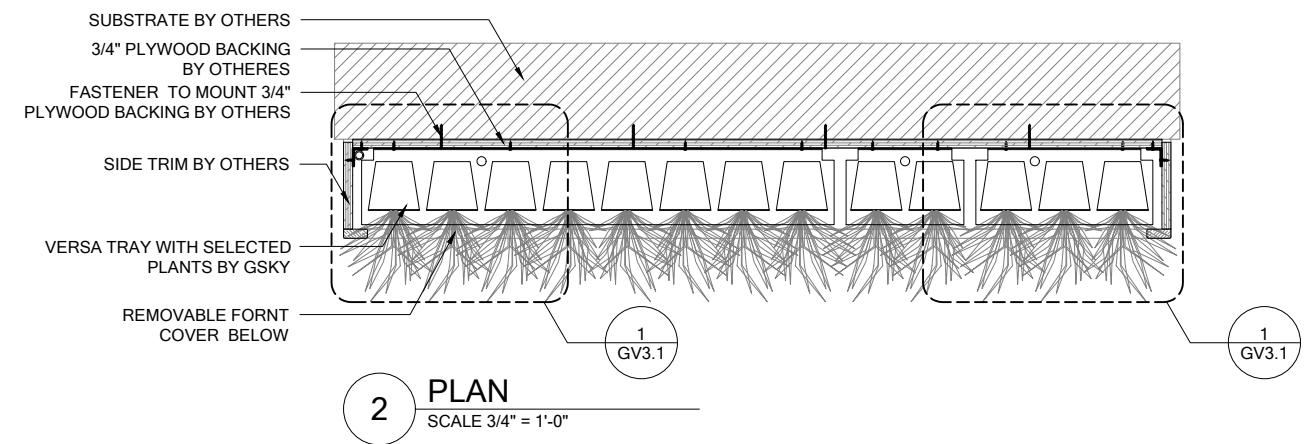

VERSA WALL[®]
VTM-72 GENERAL OVERVIEW
VER. 1.1 11x17" (A3)

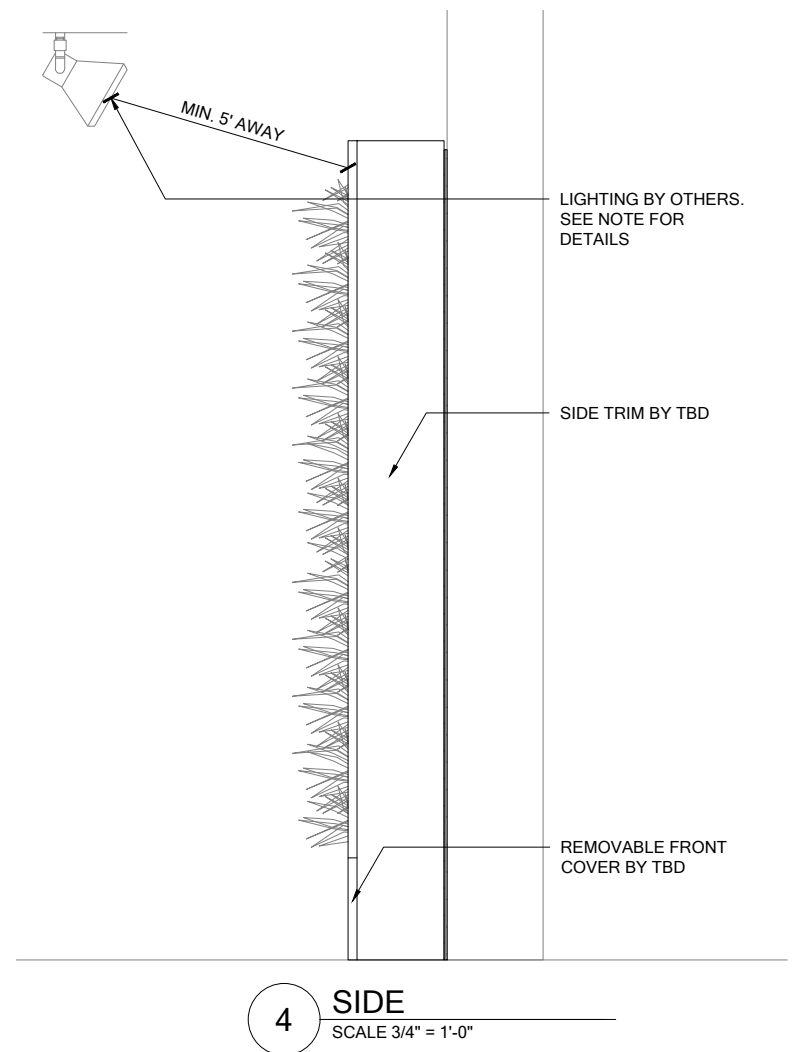
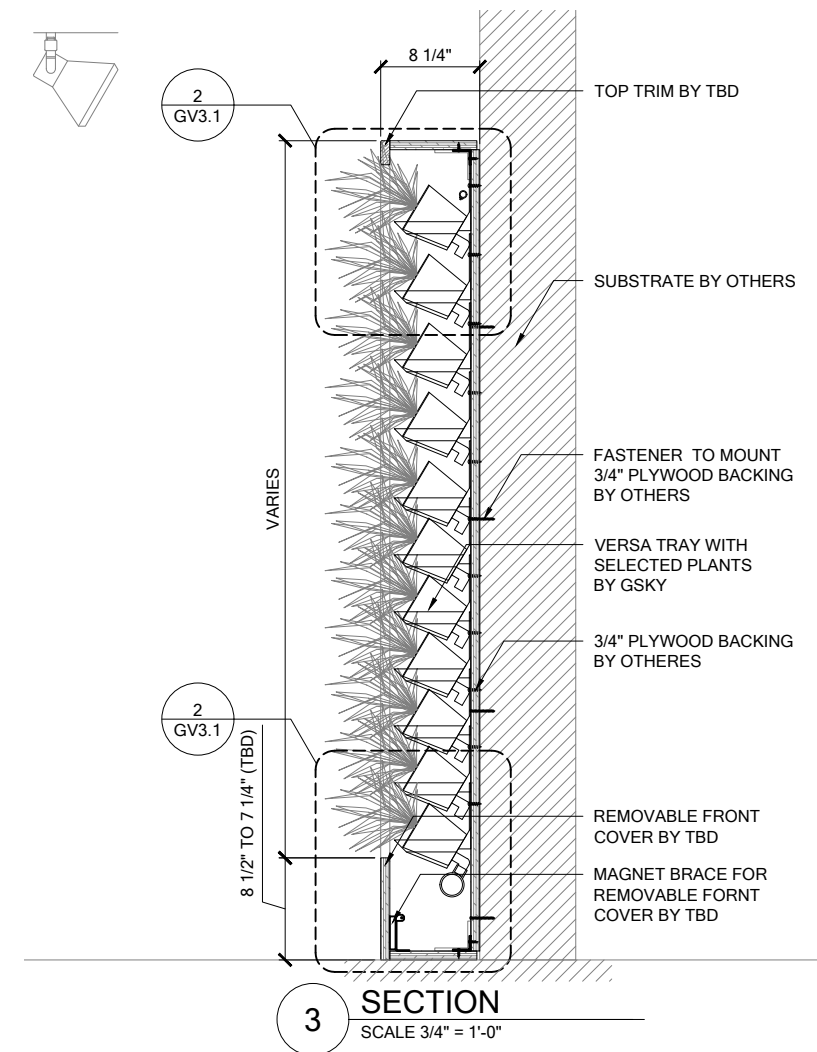
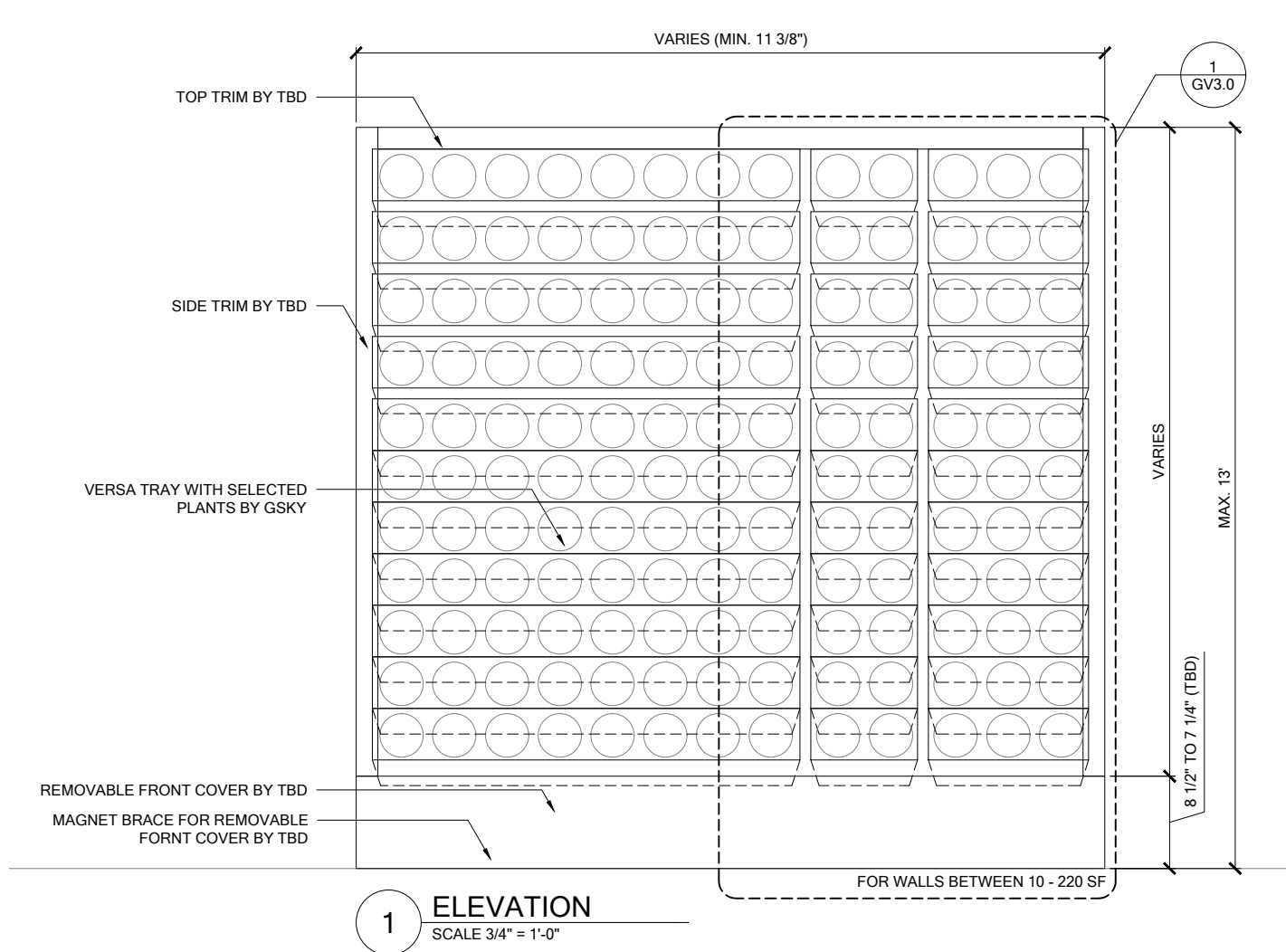
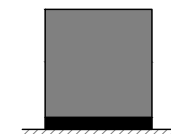

TO FLOOR
Weight is 10lbs/ft² / 50kg/m²

2" SIDE/TOP
8 1/2" BOTTOM

TRIM
Pre-finished or unfinished
See gsky.com for details.



HOSE WATER
For 50 - 220 ft² / 5 - 20 m²
Min width 11 1/4" / 29cm

SERVICE			
MANUAL	In Building	Not Req'd	Optional
AUTOMATED	N/A	N/A	N/A

IRRIGATION
It is recommended to install a drain whenever possible. Requires 2.0GPM with min. 30psi.



LIGHTING
LED or Metal Halide Lights recommended

Duration	10-12 hrs/day
Color Temp	4000-4500K
Intensity	150fc / 1500 lux (Even Flood)

< 8'	OK			
< 13'	OK	OK		
> 13'				

MAINT. ACCESS
Wall height should not exceed 13'.
See GSky maintenance manual.

GV1.0

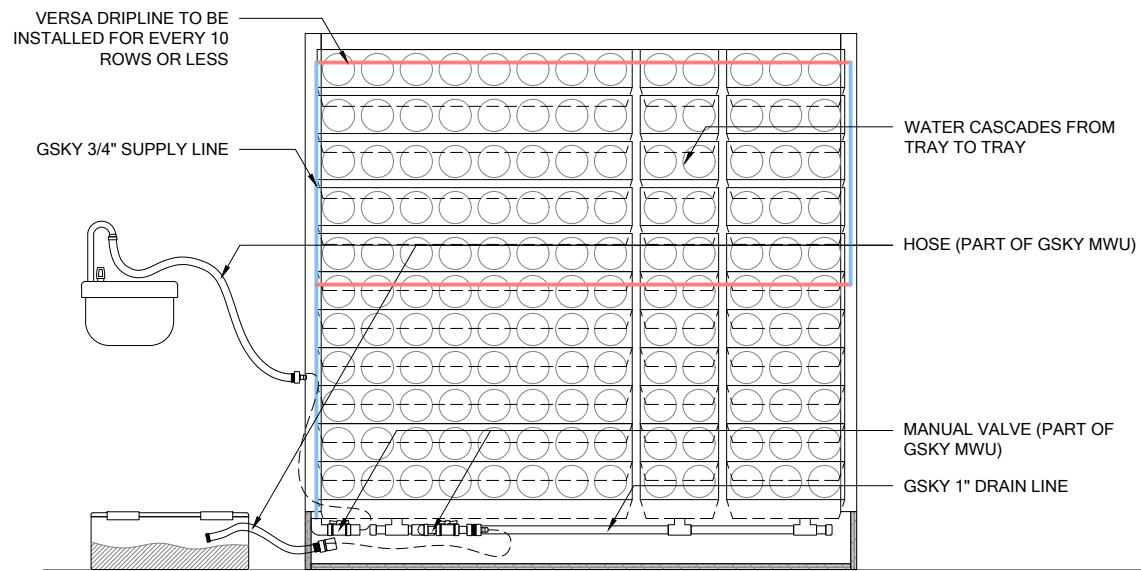

WARNING! MUST BE PRESENT WHEN WATERING.

1 ELEVATION - IRRIGATION
SCALE 3/4" = 1'-0"

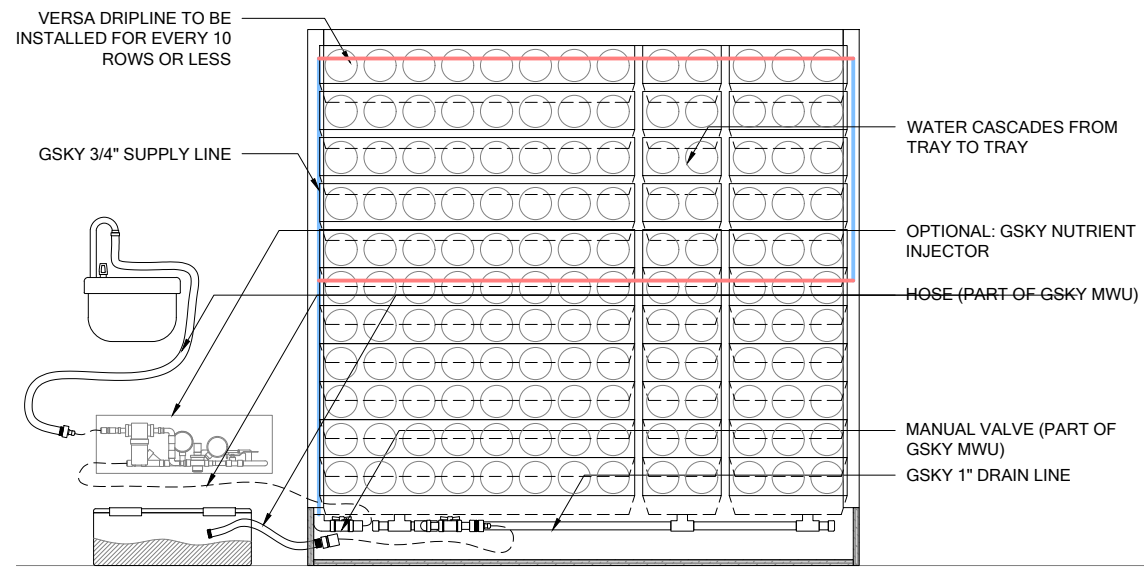

WARNING! FREQUENCY AND DOSAGE OF FERTILIZER AS PER MAINTENANCE MANUAL OR AS PER CONSULTATION WITH GSKY'S MAINTENANCE TEAM.

2 OPTIONAL: ELEVATION - FERTILIZATION
SCALE 3/4" = 1'-0"

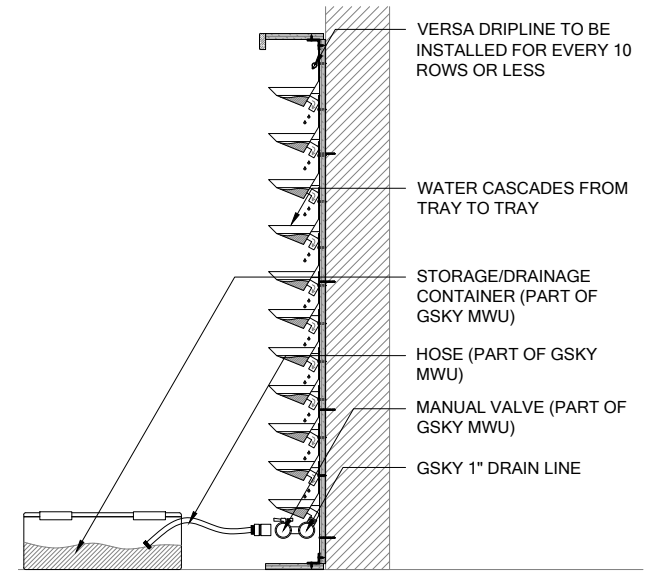

WARNING! GSKY HIGHLY RECOMMENDS AN OVERFLOW DRAINAGE AT THE WALL.

3 SECTION - DRAIN
SCALE 3/4" = 1'-0"



VERSAs WALL[®]
VTM-72 IRRIGATION OVERVIEW
VER. 1.1 11x17" (A3)

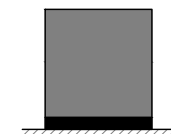

TO FLOOR
Weight is 10lbs/ft² 50kg/m²

2" SIDE/TOP
8 1/2" BOTTOM

TRIM
Pre-finished or unfinished
See gsky.com for details.



HOSE WATER
For 50 - 220 ft² / 5 - 20 m²
Min width 1 1/4" / 29cm

SERVICE			
MANUAL	In Building	Not Req'd	Optional
AUTOMATED	N/A	N/A	N/A

IRRIGATION
It is recommended to install a drain whenever possible. Requires 2.0GPM with min. 30psi.



LIGHTING
LED or Metal Halide Lights recommended

	Duration	Color Temp	Intensity
	10-12 hrs/day	4000-4500K	150fc / 1500 lux (Even Flood)

< 8'	OK		
< 13'	OK	OK	
> 13'			

MAINT. ACCESS
Wall height should not exceed 13'. See Gsky maintenance manual.

GV2.0

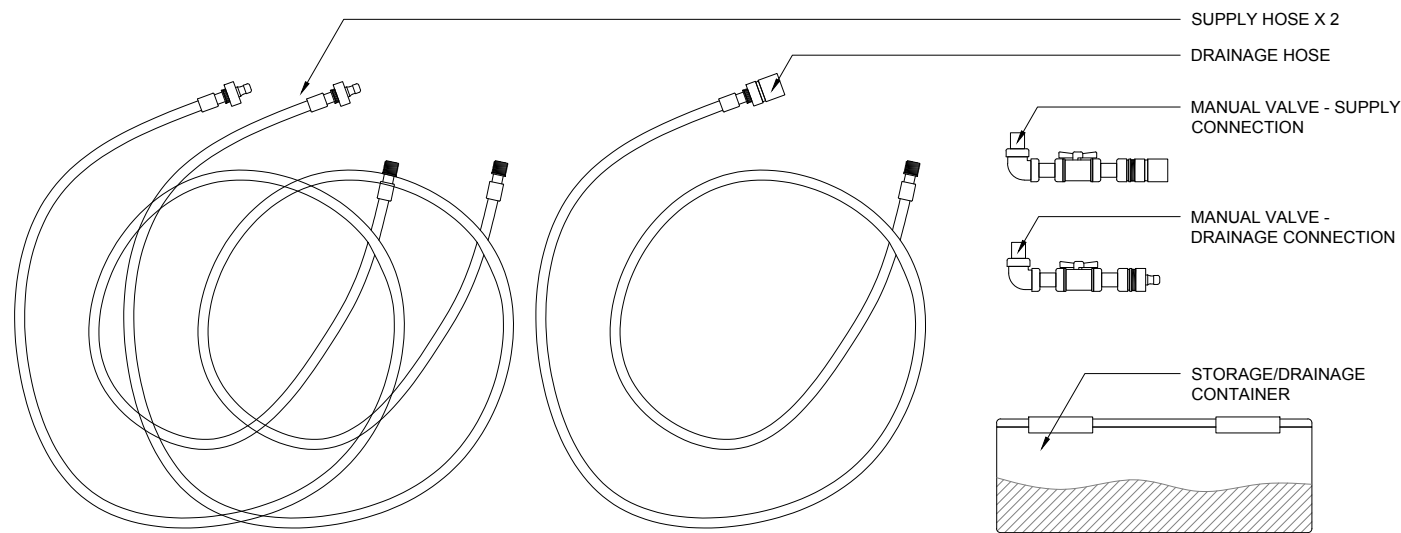

GSKY MWU ITEMS TO BE CONNECTED TO WATER SUPPLY AND DRAIN LINE DURING EVERY MAINTENANCE SESSION.

3 HOSES
2 MANUAL VALVES
1 STORAGE/DRAINAGE CONTAINER

1 GSKY MANUAL WATERING UNIT (MWU)
SCALE 1" = 1'-0"

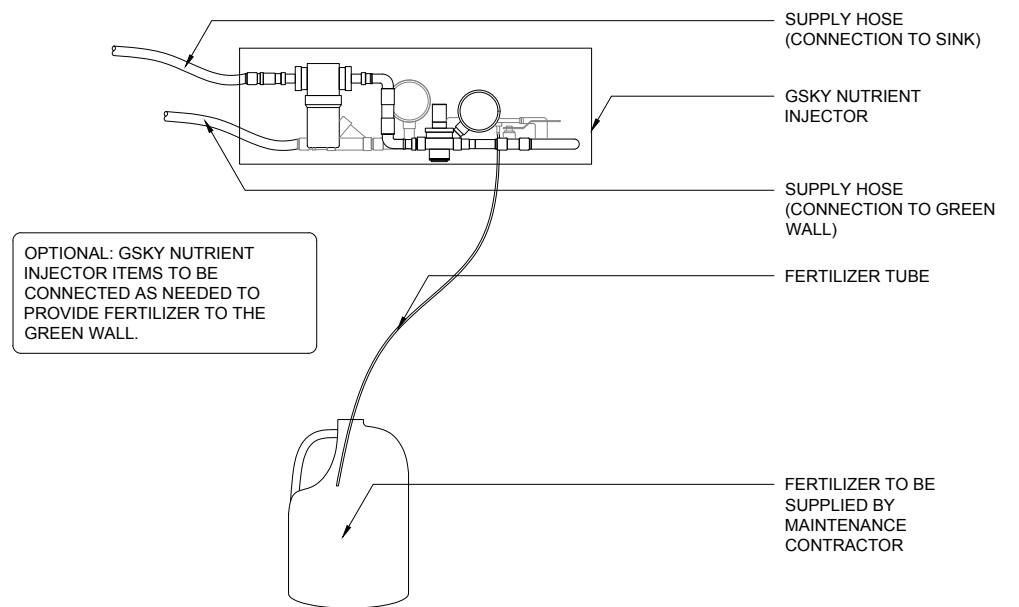

2 OPTIONAL: GSKY NUTRIENT INJECTOR
SCALE 1" = 1'-0"



VERSA WALL[®]
VTM-72 IRRIGATION SYSTEM
VER. 1.1 11x17" (A3)

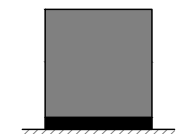

TO FLOOR
Weight is 10lbs/ft² 50kg/m²

2" SIDE/TOP
8 1/2" BOTTOM

TRIM
Pre-finished or unfinished
See gsky.com for details.



HOSE WATER
For 50 - 220 ft² / 5 - 20 m²
Min width 11 1/4" / 29cm

SERVICE			
MANUAL	In Building	Not Req'd	Optional
AUTOMATED	N/A	N/A	N/A

IRRIGATION
It is recommended to install a drain whenever possible. Requires 2.0GPM with min. 30psi.



LIGHTING
LED or Metal Halide Lights recommended

Duration
10-12 hrs/day
Color Temp
4000-4500K
Intensity
150fc / 1500 lux (Even Flood)

< 8'	OK		
< 13'	OK	OK	
> 13'			

MAINT. ACCESS
Wall height should not exceed 13'. See GSKY maintenance manual.

GV2.1

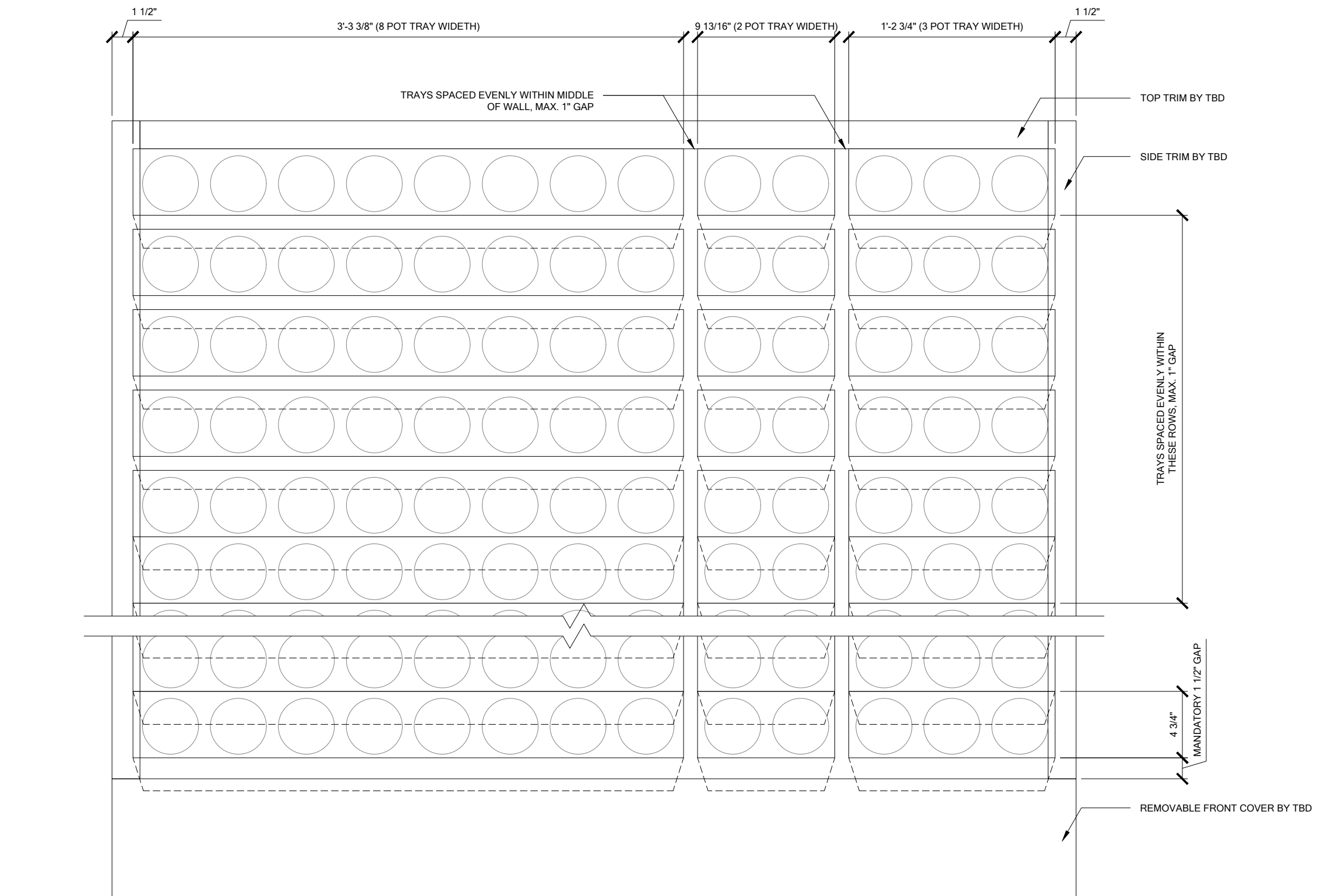

1 TRAY LAYOUT
SCALE 1 1/2" = 1'-0"



VERSA WALL®

VTM-72 TRAY LAYOUT

VER. 1.1

11x17" (A3)

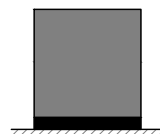

TO FLOOR

Weight is 10lbs/ft² 50kg/m²

2"	SIDE/TOP
8 1/2"	BOTTOM

TRIM

Pre-finished or unfinished
See gsky.com for details.



HOSE WATER

For 50 - 220 ft² / 5 - 20 m²
Min width 11 1/4" / 29cm

SERVICE			
MANUAL	In Building	Not Req'd	Optional
AUTOMATED	N/A	N/A	N/A

IRRIGATION

It is recommended to install a drain whenever possible. Requires 2.0GPM with min. 30psi.

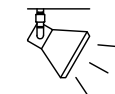

LIGHTING

LED or Metal Halide Lights recommended

Duration	10-12 hrs/day
Color Temp	4000-4500K
Intensity	150fc / 1500 lux (Even Flood)

< 8'	OK		
< 13'	OK	OK	
> 13'			

MAINT. ACCESS

Wall height should not exceed 13'.
See GSky maintenance manual.

GV3.0

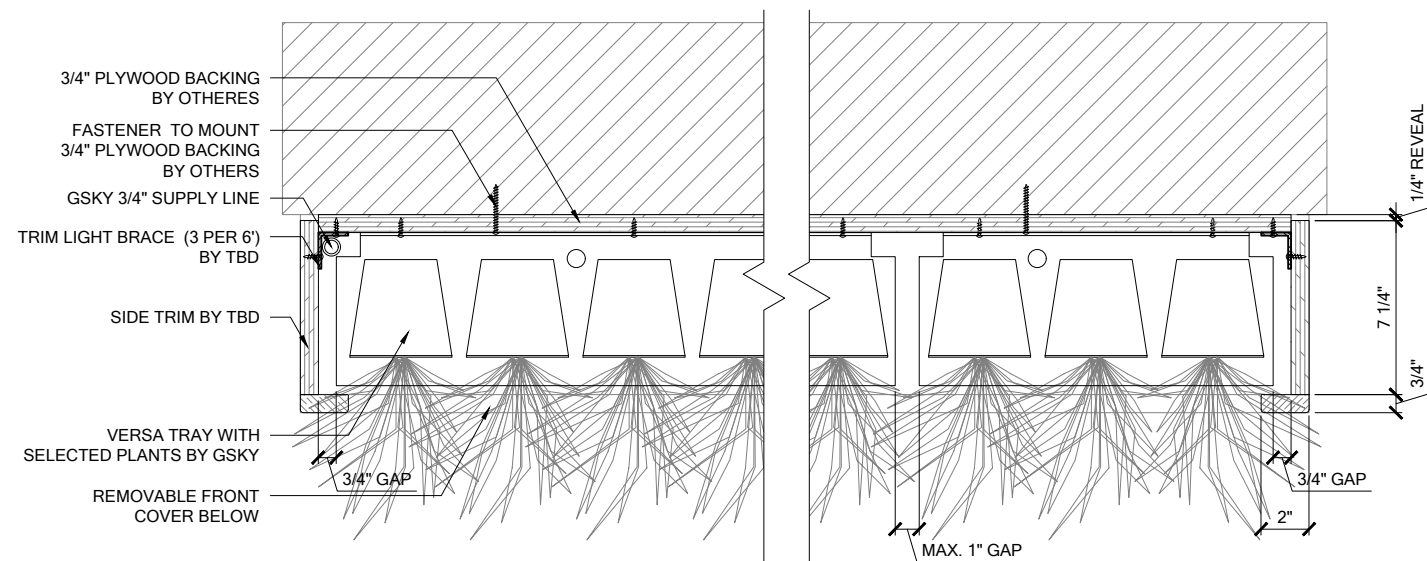

1 PLAN
SCALE 1 1/2" = 1'-0"

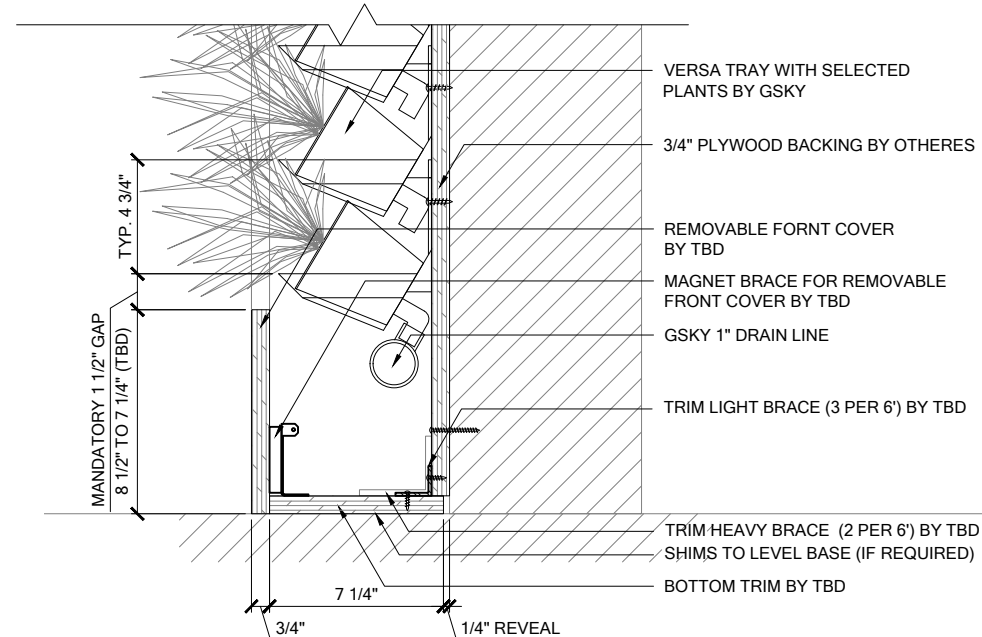
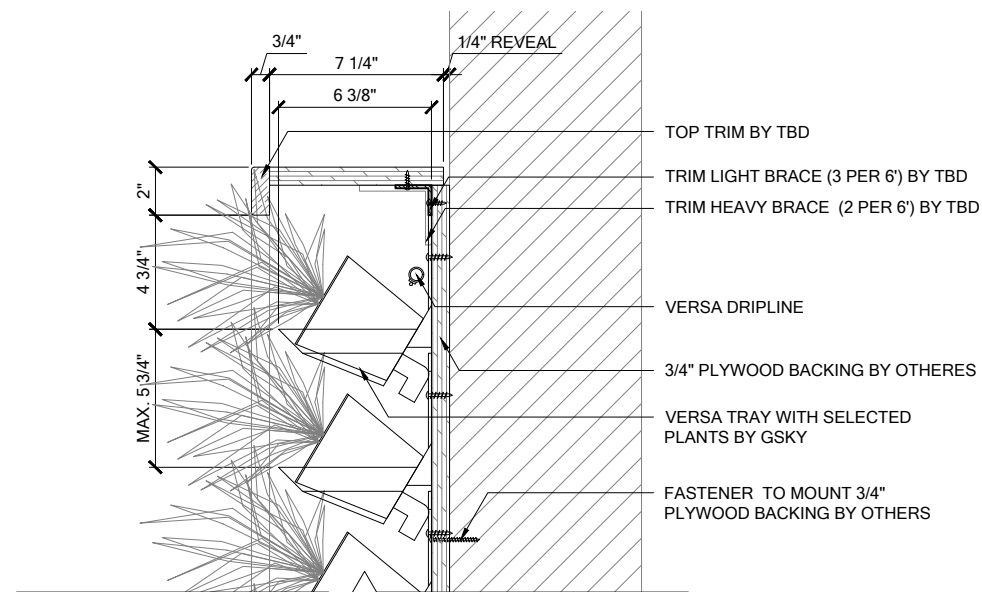

2 SECTION
SCALE 1 1/2" = 1'-0"



VERSA WALL®

VTM-72 DETAILS

VER. 1.1

11x17" (A3)

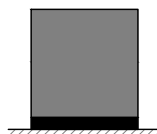

TO FLOOR
Weight is 10lbs/ft² 50kg/m²

2"	SIDE/TOP
8 1/2"	BOTTOM

TRIM
Pre-finished or unfinished
See gsky.com for details.



HOSE WATER
For 50 - 220 ft² / 5 - 20 m²
Min width 11 1/8" / 29cm

SERVICE			
MANUAL	In Building	Not Req'd	Optional
AUTOMATED	N/A	N/A	N/A

IRRIGATION
It is recommended to install a drain whenever possible. Requires 2.0GPM with min. 30psi.



LIGHTING
LED or Metal Halide Lights recommended

Duration	10-12 hrs/day
Color Temp	4000-4500K
Intensity	150fc / 1500 lux (Even Flood)

< 8'	OK		
< 13'	OK	OK	
> 13'			

MAINT. ACCESS
Wall height should not exceed 13'.
See Gsky maintenance manual.

GV3.1