

VERSA TRAY

BOTTOM TRIM BY TBD

REMOVABLE FRONT COVER BY TBD

MAGNET BREACE FOR REMOVABLE FRONT COVER BY TBD



VERSA WALL®
TO THE FLOOR / HAND WATER
VTH-7N

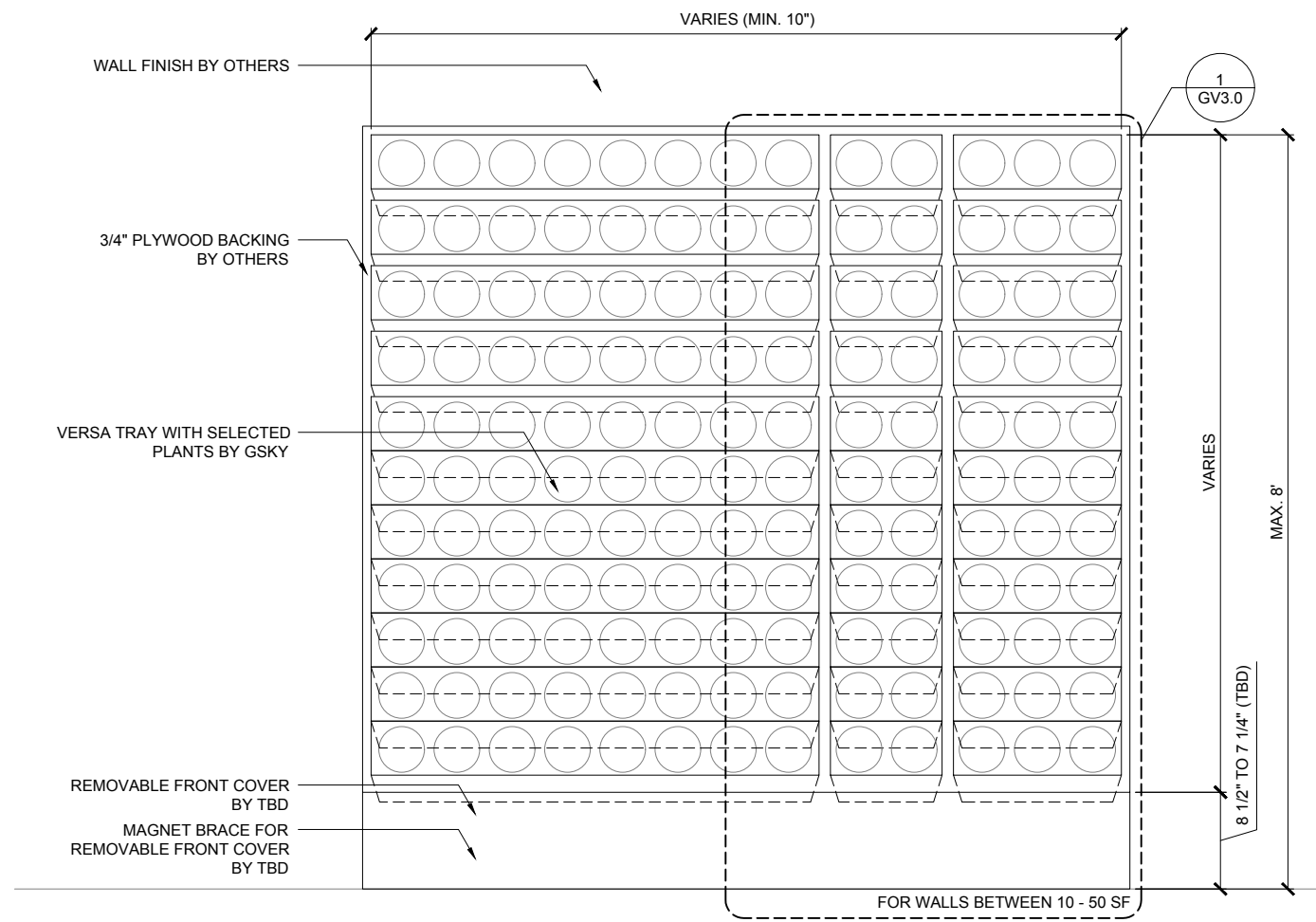

1 ELEVATION
SCALE 3/4" = 1'-0"

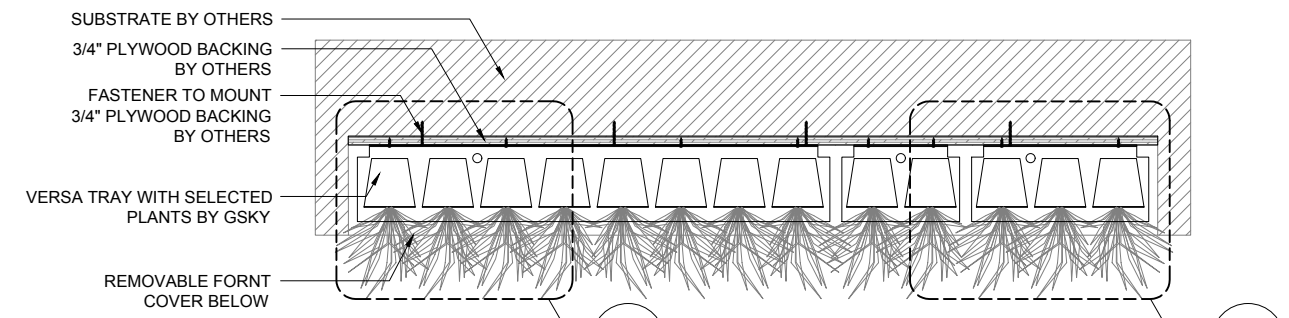

2 PLAN
SCALE 3/4" = 1'-0"

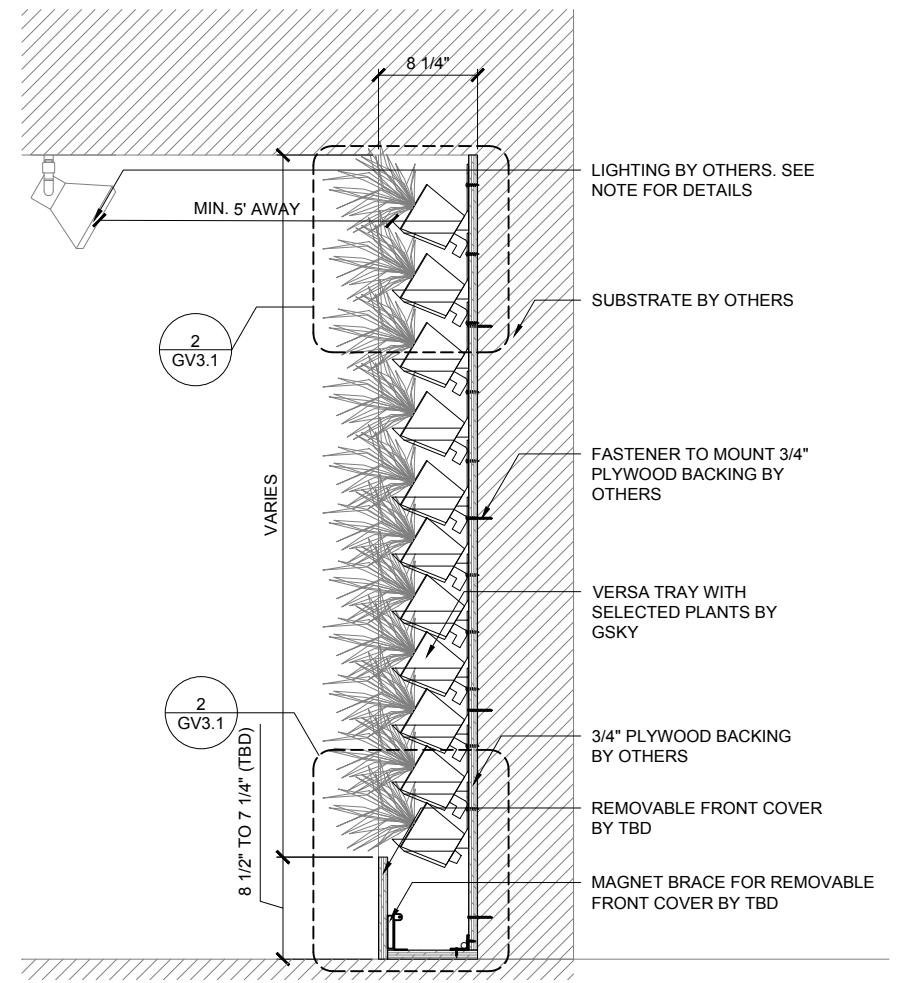

3 SECTION
SCALE 3/4" = 1'-0"



VERSA WALL[®]
VTH-7N GENERAL OVERVIEW
VER. 1.1 11x17" (A3)

TO FLOOR
Weight is 10lbs/ft² 50kg/m²

TRIM
NOTE: edges of trays will be exposed unless recessed or covered.

HAND WATER
For 10 - 50 ft² / 1 - 5 m²
Min width 10" / 25cm

SERVICE			
MANUAL	Not Req'd	Not Req'd	Not Req'd
AUTOMATED	N/A	N/A	N/A

LIGHTING
LED or Metal Halide Lights recommended
Duration: 10-12 hrs/day
Color Temp: 4000-4500K
Intensity: 150fc / 1500 lux (Even Flood)

< 8'	OK			
< 13'				
> 13'				

MAINT. ACCESS
Wall height should not exceed 8'. See GSKy maintenance manual.

GV1.0

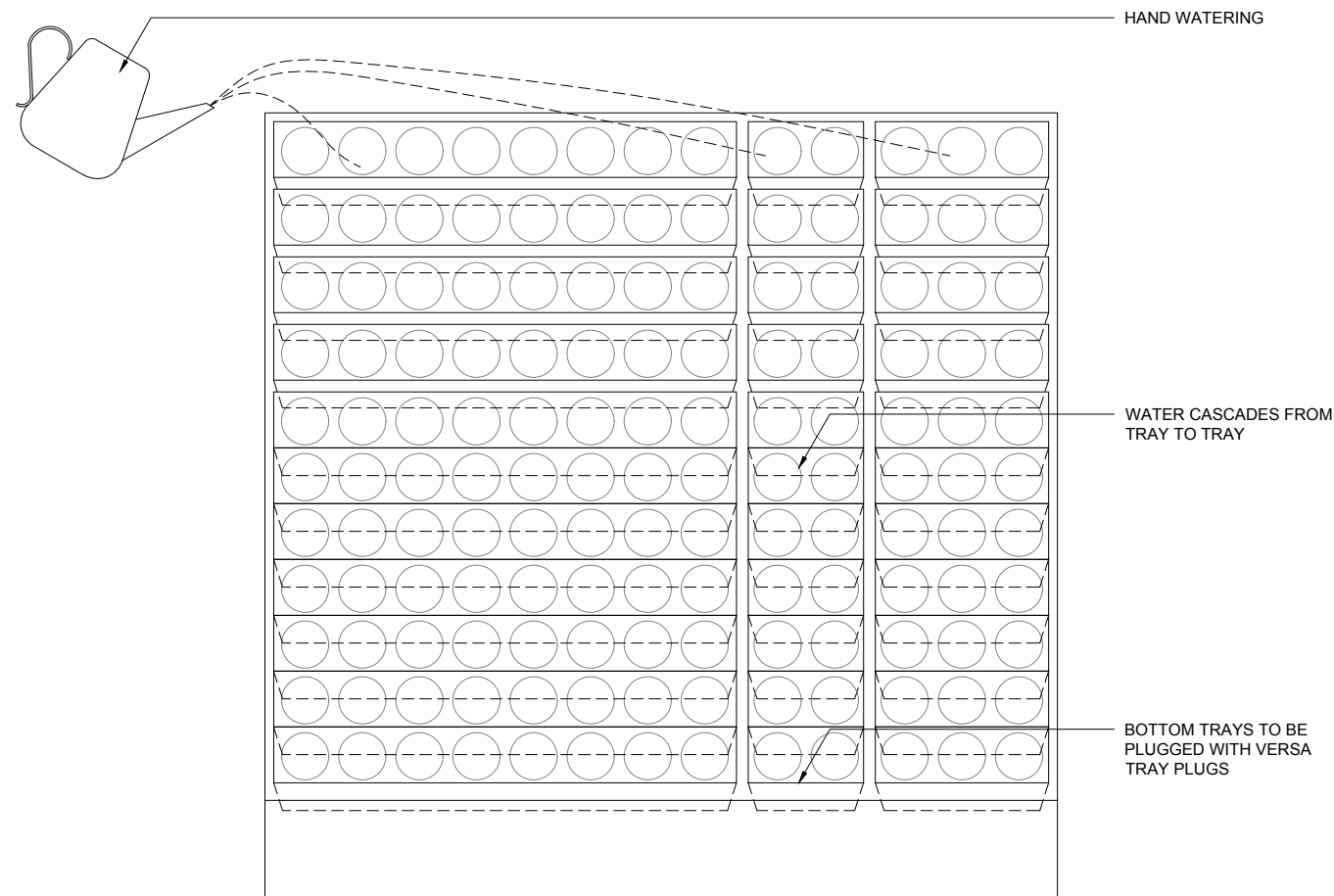

WARNING! BE CAREFUL NOT TO ADD TOO MUCH WATER AS IT MAY CAUSE OVERFLOW.

1 ELEVATION
SCALE 3/4" = 1'-0"

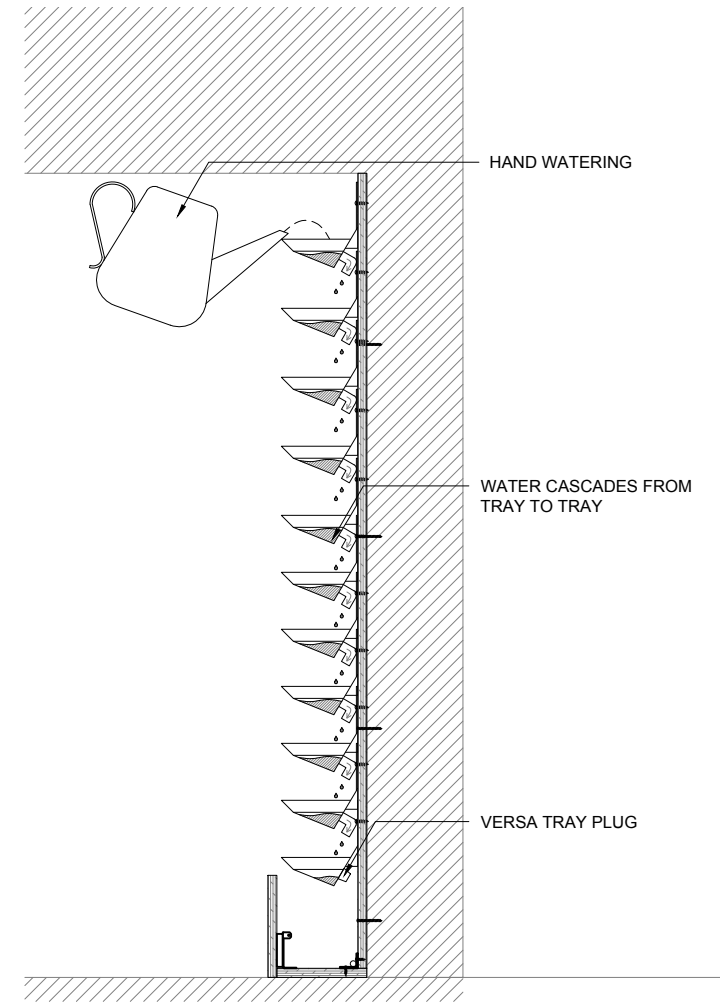

2 SECTION
SCALE 3/4" = 1'-0"



VERSA WALL[®]
VTH-7N IRRIGATION OVERVIEW
VER. 1.1 11x17" (A3)

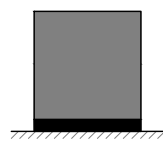

TO FLOOR
Weight is 10lbs/ft² / 50kg/m²

-	SIDE/TOP
8 1/2"	BOTTOM

TRIM
NOTE: edges of trays will be exposed unless recessed or covered.

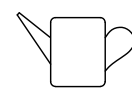

HAND WATER
For 10 - 50 ft² / 1 - 5 m²
Min width 10" / 25cm

SERVICE			
MANUAL	Not Req'd	Not Req'd	Not Req'd
AUTOMATED	N/A	N/A	N/A

IRRIGATION
It is recommended to install a drain whenever possible

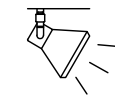

LIGHTING
LED or Metal Halide Lights recommended

Duration
10-12 hrs/day
Color Temp
4000-4500K
Intensity
150fc / 1500 lux (Even Flood)

< 8'	OK			
< 13'				
> 13'				

MAINT. ACCESS
Wall height should not exceed 8'. See GSky maintenance manual.

GV2.0

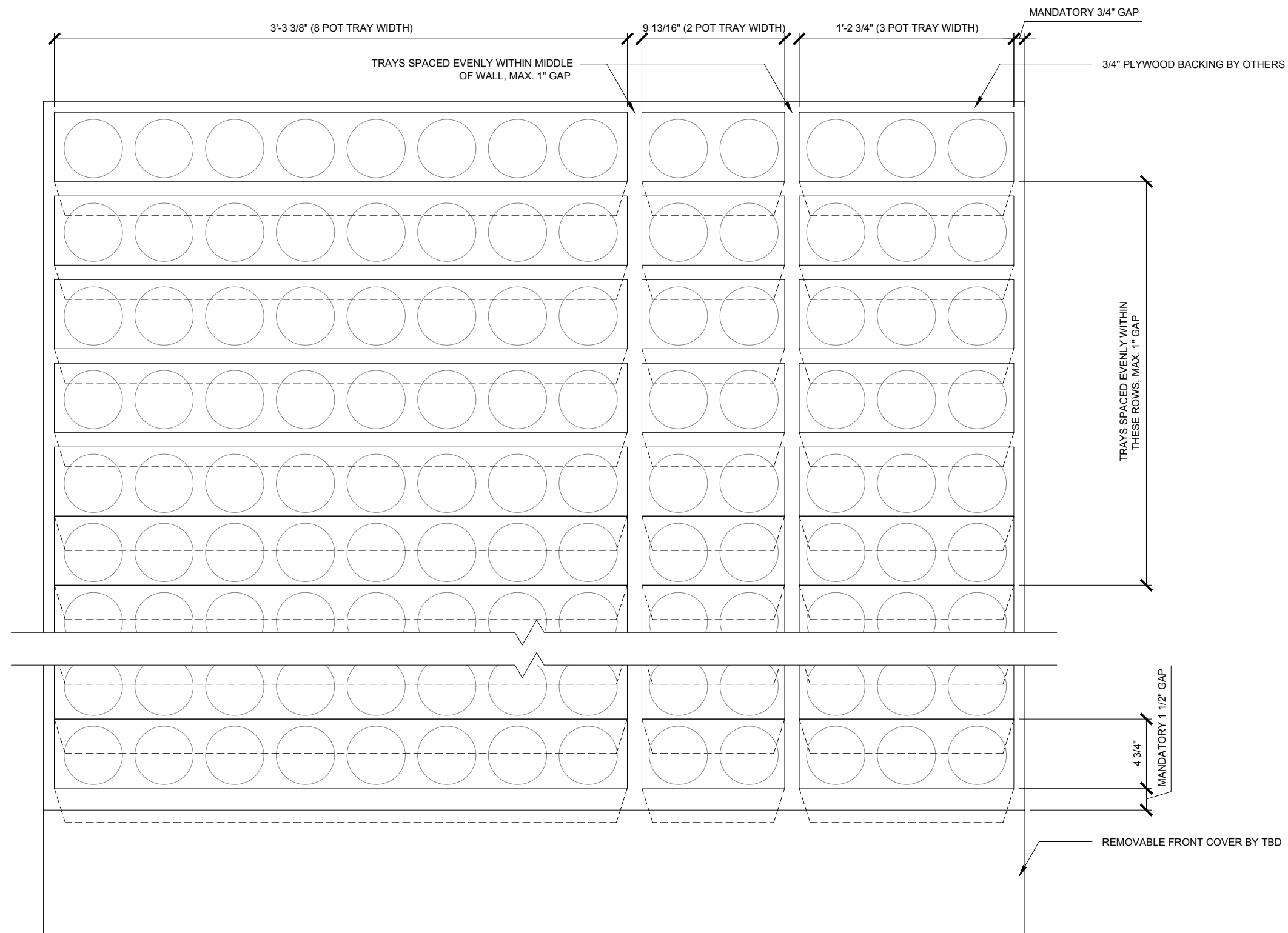

1 TRAY LAYOUT
SCALE 1 1/2" = 1'-0"



VERSA WALL®

VTH-7N TRAY LAYOUT

VER. 1.1

11x17" (A3)

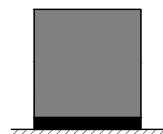

TO FLOOR

Weight is 10lbs/ft² 50kg/m²

-	SIDE/TOP
8 1/2"	BOTTOM

TRIM

NOTE: edges of trays will be exposed unless recessed or covered.

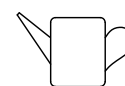

HAND WATER

For 10 - 50 ft² / 1 - 5 m²
Min width 10" / 25cm

SERVICE			
MANUAL	Not Req'd	Not Req'd	Not Req'd
AUTOMATED	N/A	N/A	N/A

IRRIGATION

It is recommended to install a drain whenever possible

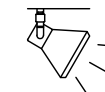

LIGHTING

LED or Metal Halide Lights recommended

Duration
10-12 hrs/day
Color Temp
4000-4500K
Intensity
150fc / 1500 lux
(Even Flood)

< 8'	OK		
< 13'			
> 13'			

MAINT. ACCESS

Wall height should not exceed 8'.
See GSky maintenance manual.

GV3.0

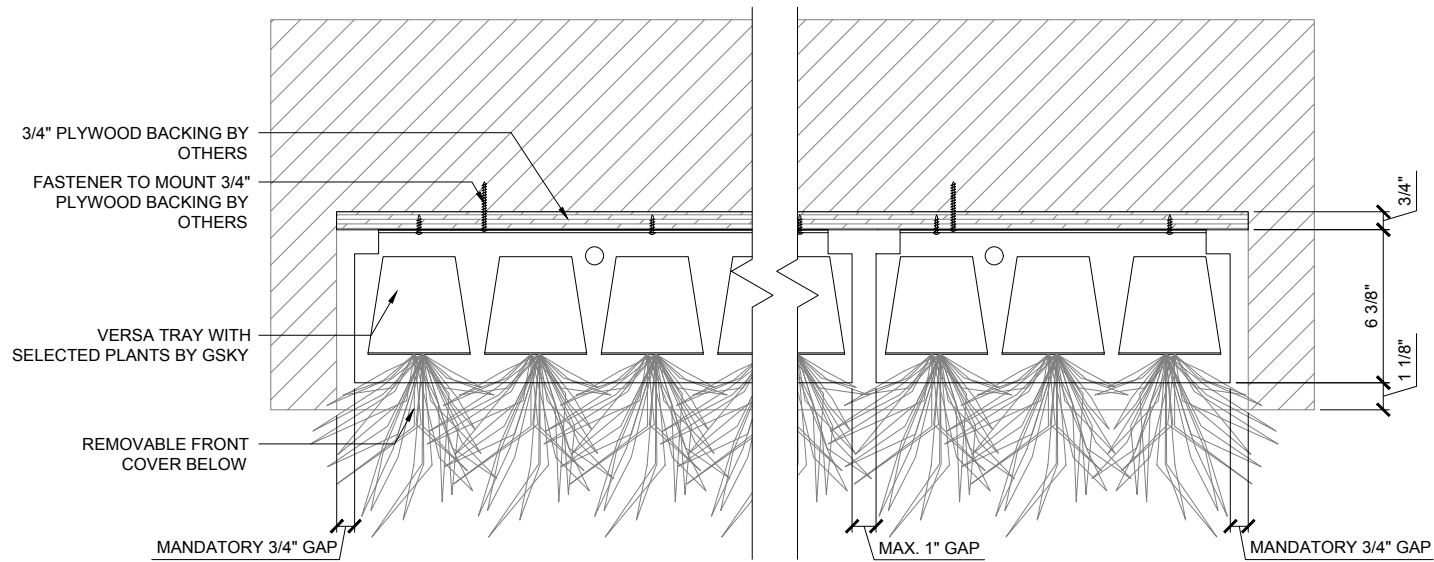

1 ELEVATION
SCALE 1 1/2" = 1'-0"

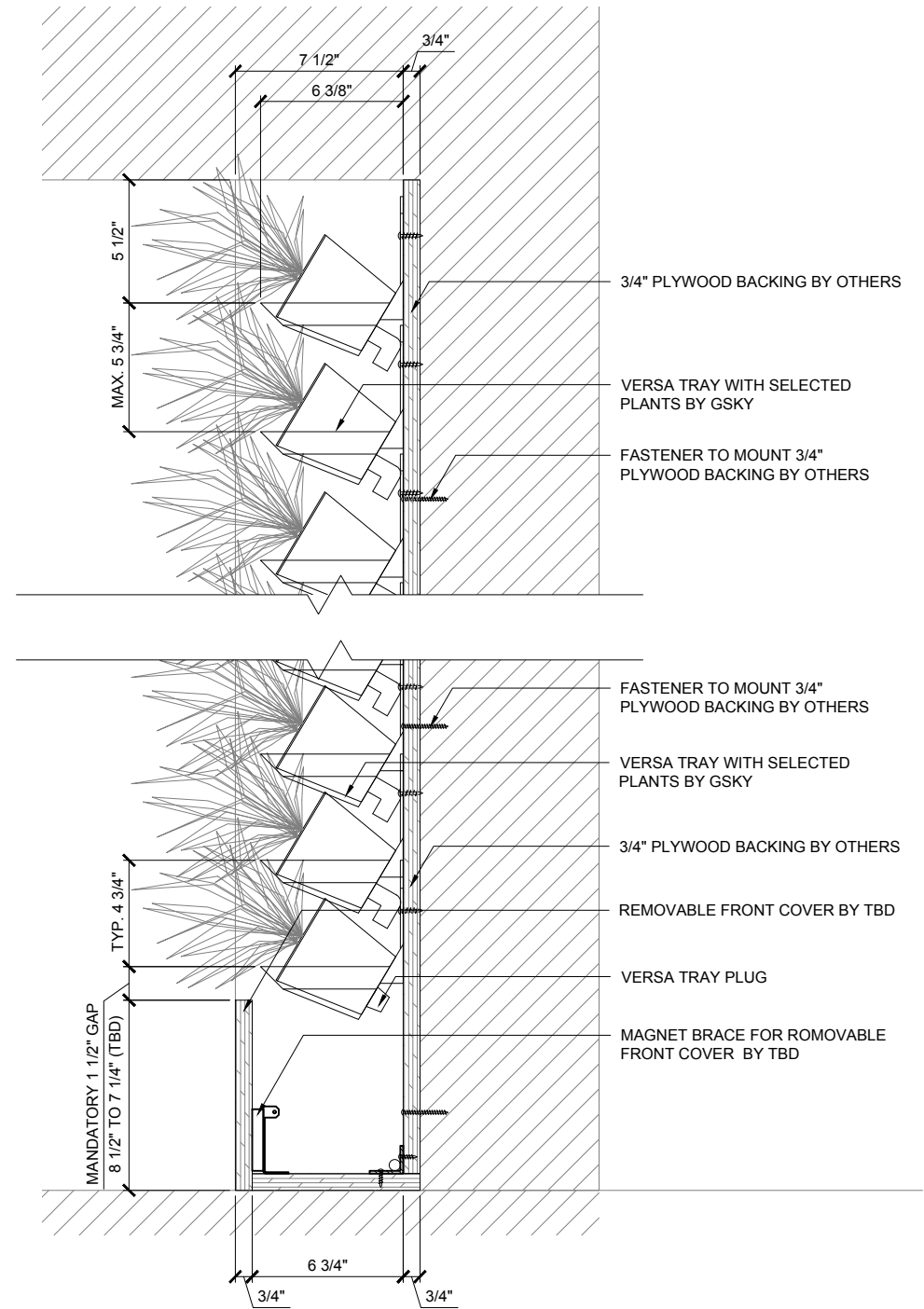

2 SECTION
SCALE 1 1/2" = 1'-0"



VERSA WALL®

VTH-7N DETAILS

VER. 1.1

11x17" (A3)

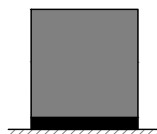

TO FLOOR

Weight is 10lbs/ft² 50kg/m²



TRIM

NOTE: edges of trays will be exposed unless recessed or covered.

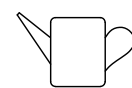

HAND WATER

For 10 - 50 ft² / 1 - 5 m²
Min width 10" / 25cm

SERVICE			
MANUAL	Not Req'd	Not Req'd	Not Req'd
AUTOMATED	N/A	N/A	N/A

IRRIGATION

It is recommended to install a drain whenever possible

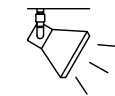

LIGHTING

LED or Metal Halide Lights recommended

Duration	10-12 hrs/day
Color Temp	4000-4500K
Intensity	150fc / 1500 lux (Even Flood)

< 8'	OK		
< 13'			
> 13'			

MAINT. ACCESS

Wall height should not exceed 8'. See Gsky maintenance manual.

GV3.1