

VERSA WALL®

TO THE FLOOR / HAND WATER
VTH-72

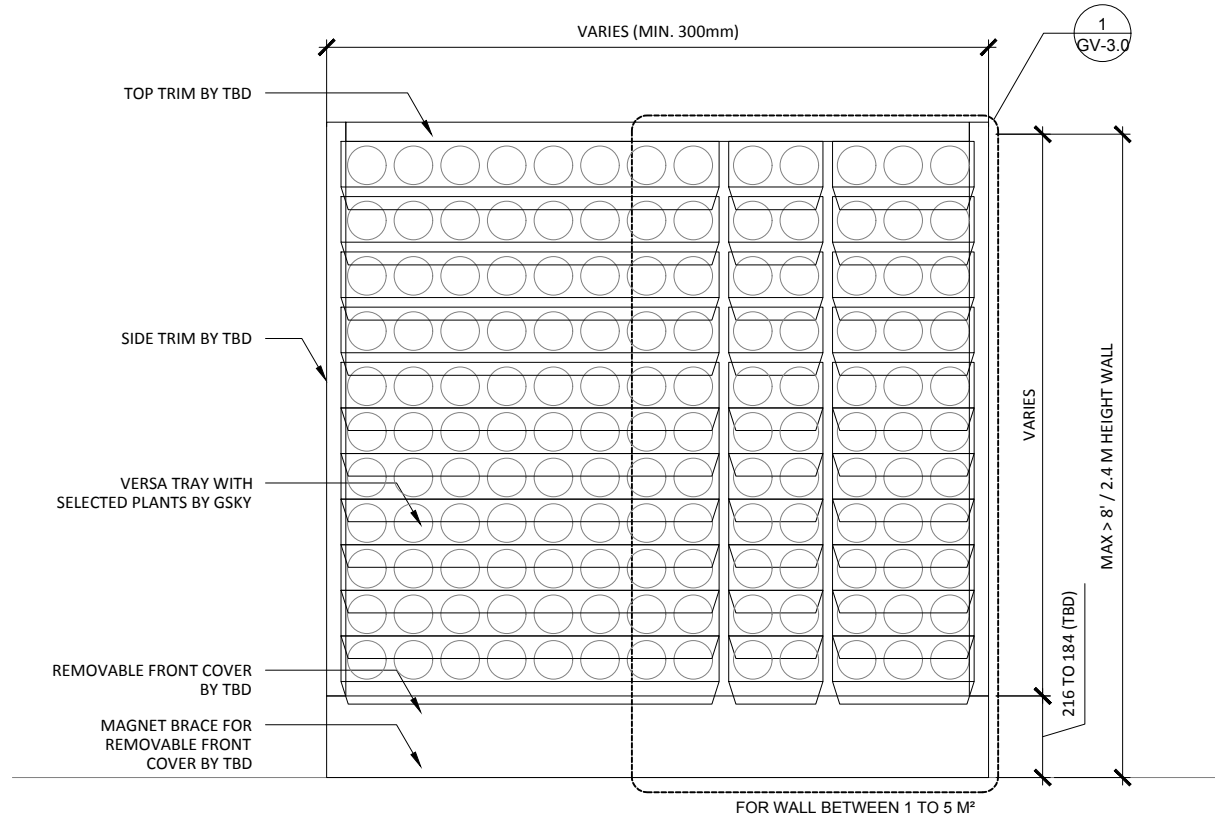

1 ELEVATION
SCALE: 1:20

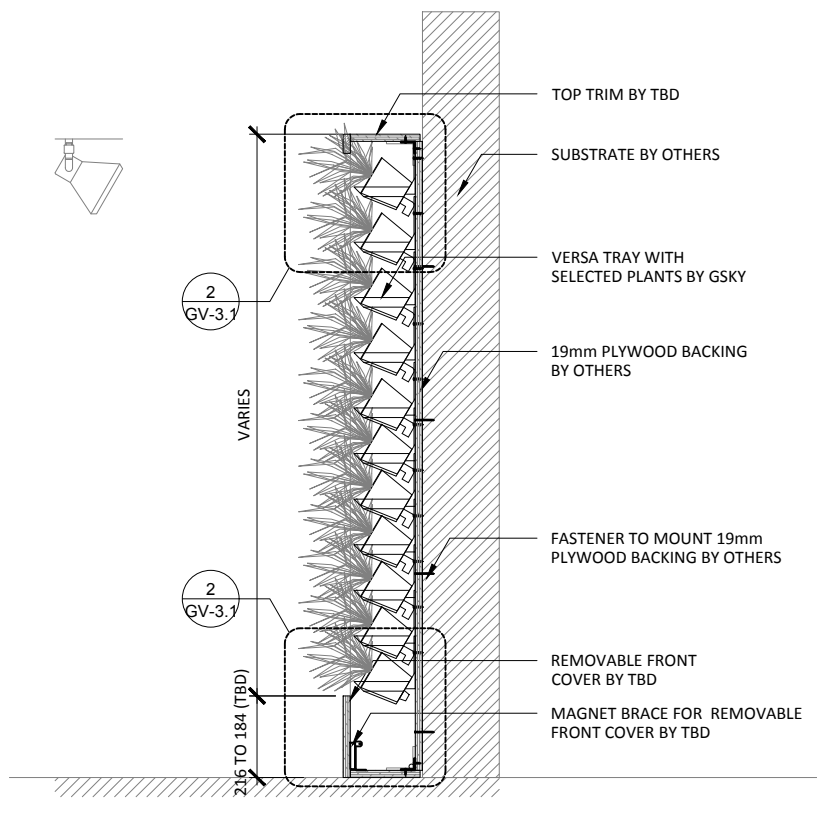

3 SECTION
SCALE: 1:20

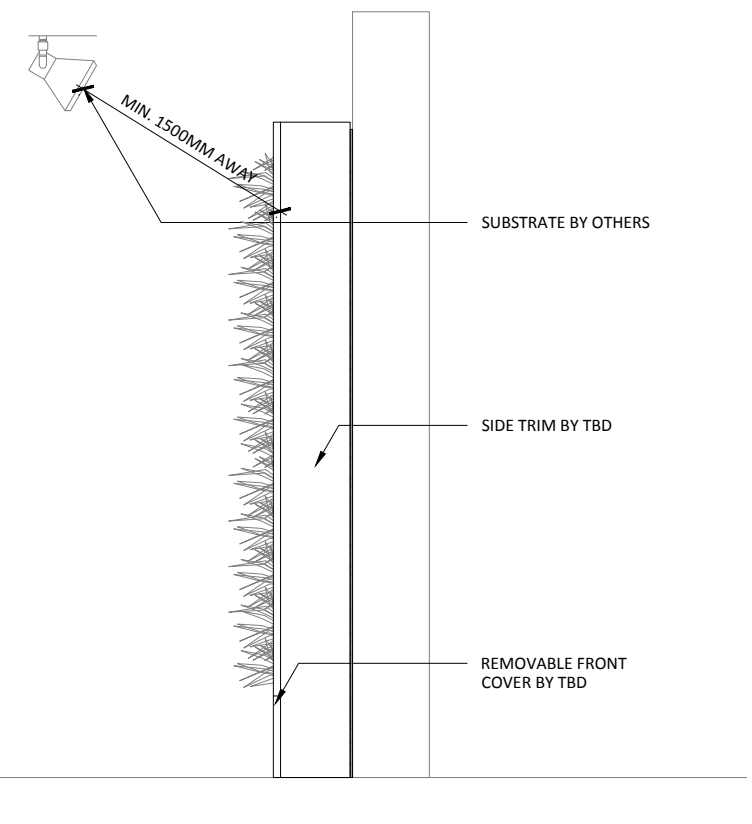

4 SIDE
SCALE: 1:20

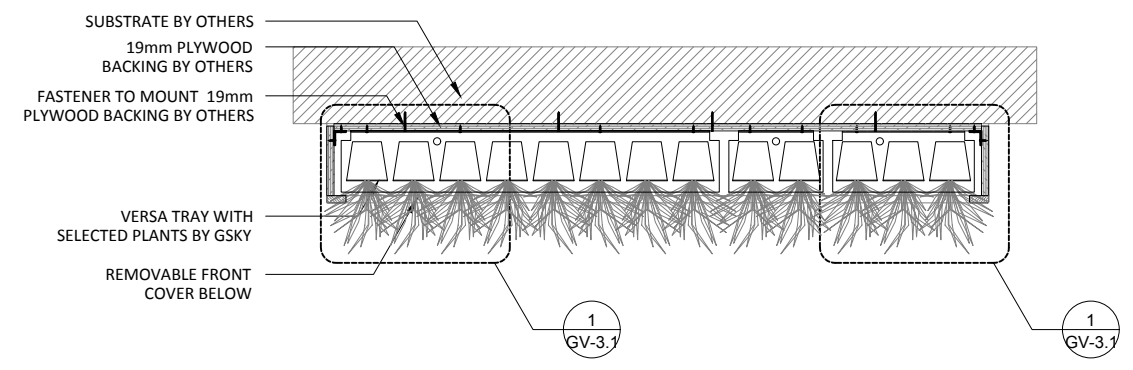

2 PLAN
SCALE: 1:20



VERSA WALL[®]
VTH-72 GENERAL OVER VIEW
VER. 1.1 297x420 mm (A3)

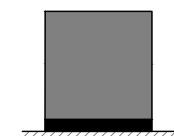

TO FLOOR
Weight is 10lbs/ft² 50kg/m²

51mm	SIDE/TOP
216mm	BOTTOM

TRIM
NOTE: pipes and edges of trays will be exposed unless recessed or covered

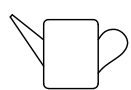

HAND WATER
For 10 - 50 ft² / 1 - 5 m²
Min width 10" / 25cm

SERVICE			
MANUAL	N/A	N/A	N/A
AUTOMATED	At Wall	At Wall	At Wall

IRRIGATION
It is recommended to install a drain whenever possible. Require GSKy's consultation for > 35' / 10.5 m height wall.

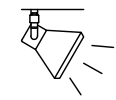

LIGHTING
LED or Metal Halide Lights recommended

Duration	10-12 hrs/day
Color Temp	4000-4500K
Intensity	150fc / 1500 lux (Even Flood)

< 2400	OK			
< 4000	OK	OK		
> 4000		OK	OK	OK

MAINT. ACCESS
Walls over 40' / 12m need additional considerations. See GSKy maintenance manual.

GV1.0

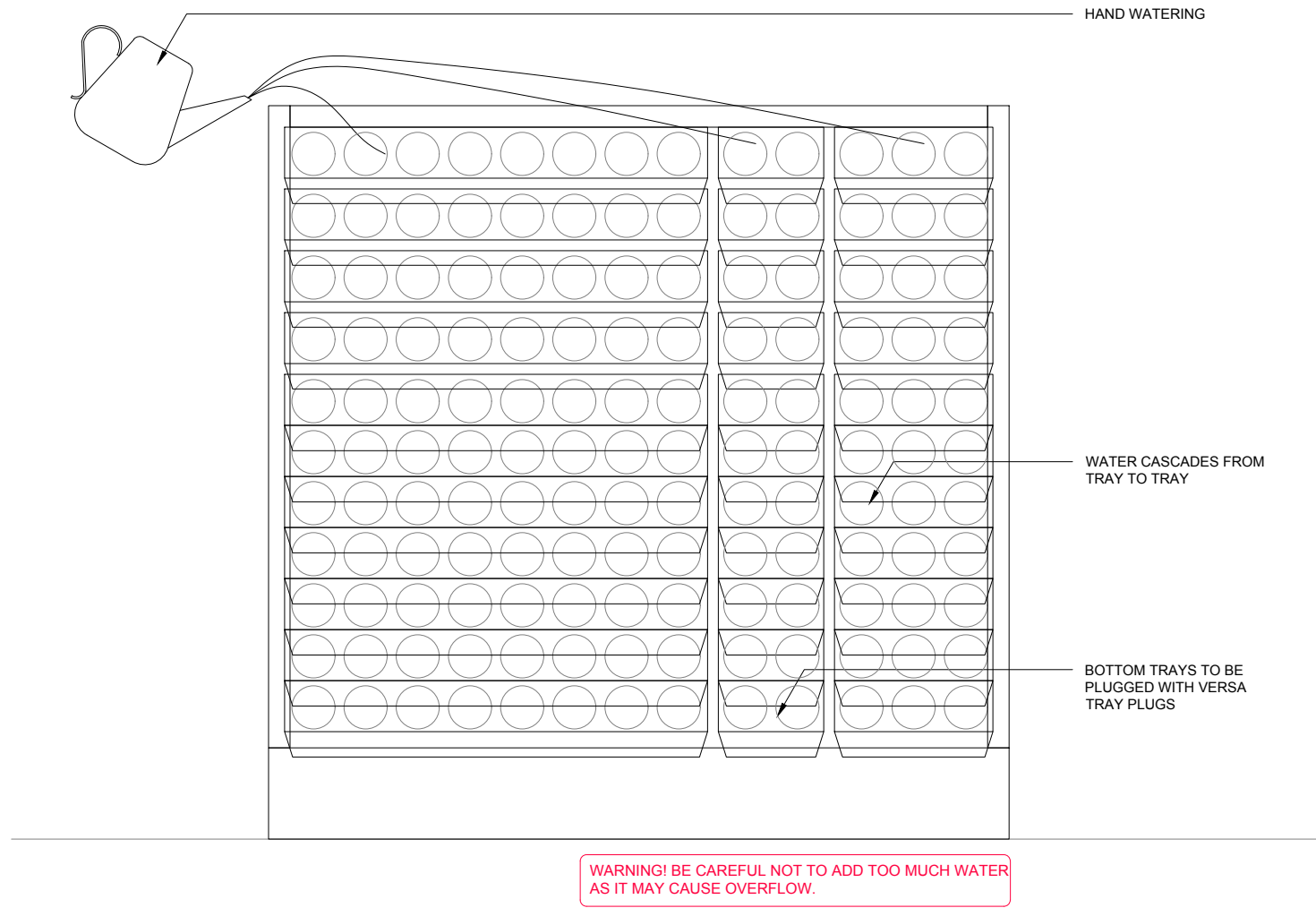

1 ELEVATION
SCALE: 1:16

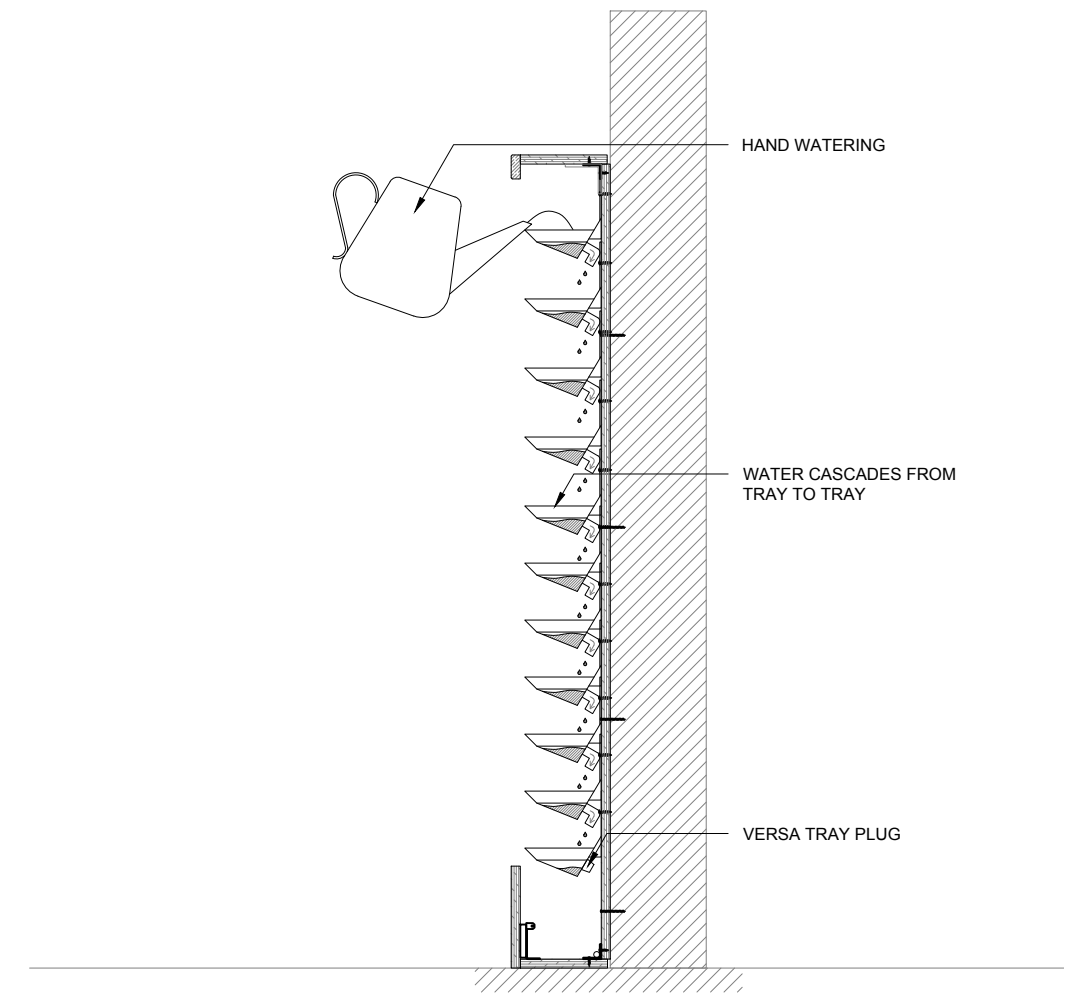

2 SECTION
SCALE: 1:16



VERSA WALL[®]
VTH-72 IRRIGATION OVERVIEW
VER. 1.1 297x420 mm (A3)

TO FLOOR
Weight is 10lbs/ft² / 50kg/m²

51mm	SIDE/TOP
216mm	BOTTOM

TRIM
NOTE: pipes and edges of trays will be exposed unless recessed or covered

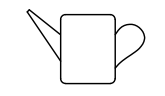

HAND WATER
For 10 - 50 ft² / 1 - 5 m²
Min width 10" / 25cm

SERVICE			
MANUAL	N/A	N/A	N/A
AUTOMATED	At Wall	At Wall	At Wall

IRRIGATION
It is recommended to install a drain whenever possible. Require GSky's consultation for > 35' / 10.5 m height wall.

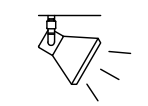

LIGHTING
LED or Metal Halide Lights recommended

Duration	10-12 hrs/day
Color Temp	4000-4500K
Intensity	150fc / 1500 lux (Even Flood)

< 2400	OK			
< 4000	OK	OK		
> 4000		OK	OK	OK

MAINT. ACCESS
Walls over 40' / 12m need additional considerations. See GSky maintenance manual.

GV2.0

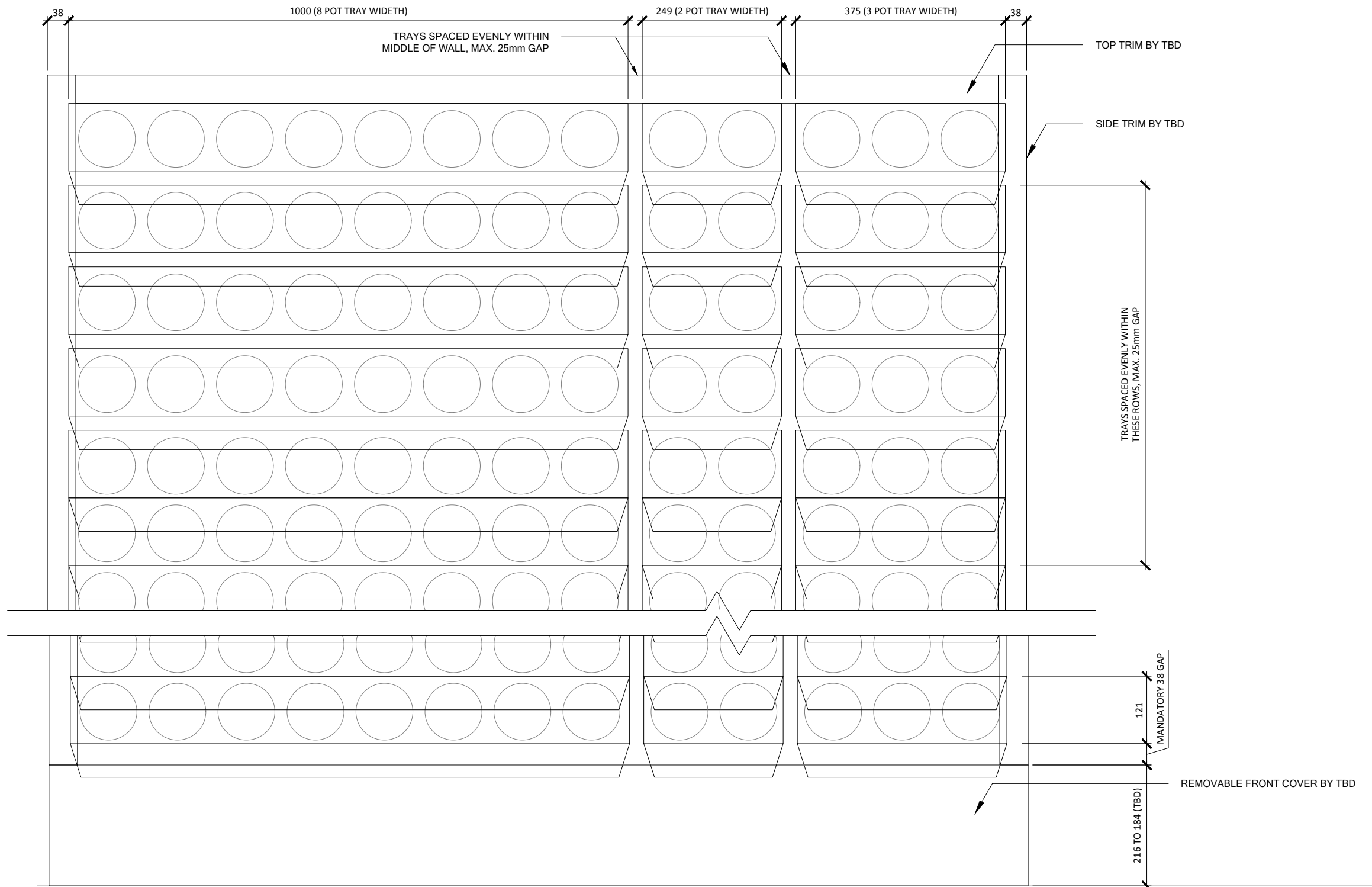

1 TRAY LAYOUT
SCALE: 1:8



VERSA WALL®

VTH-72 TRAY LAYOUT

VER. 1.1

297x420 mm (A3)

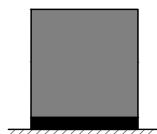

TO FLOOR

Weight is 10lbs/ft² 50kg/m²

51mm	SIDE/TOP
216mm	BOTTOM

TRIM

NOTE: pipes and edges of trays will be exposed unless recessed or covered

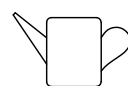

HAND WATER

For 10 - 50 ft² / 1 - 5 m²
Min width 10" / 25cm

SERVICE			
MANUAL	N/A	N/A	N/A
AUTOMATED	At Wall	At Wall	At Wall

IRRIGATION

It is recommended to install a drain whenever possible. Require GSKy's consultation for > 35' / 10.5 m height wall.



LIGHTING

LED or Metal Halide Lights recommended

	Duration
	10-12 hrs/day
	Color Temp
	4000-4500K
	Intensity
	150fc / 1500 lux (Even Flood)



MAINT. ACCESS

Walls over 40' / 12m need additional considerations. See GSKy maintenance manual.

GV3.0

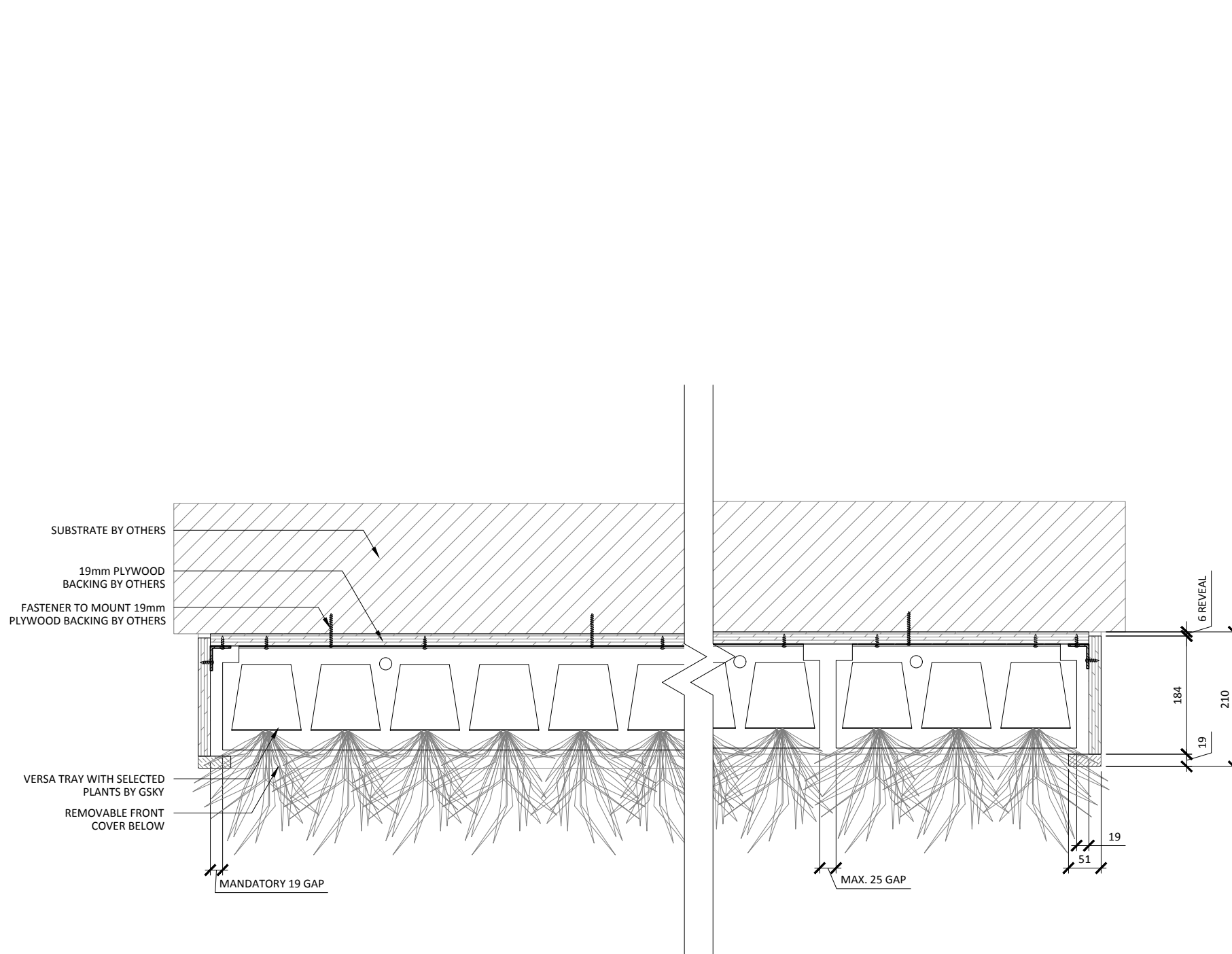

1 PLAN DETAIL
SCALE: 1:8

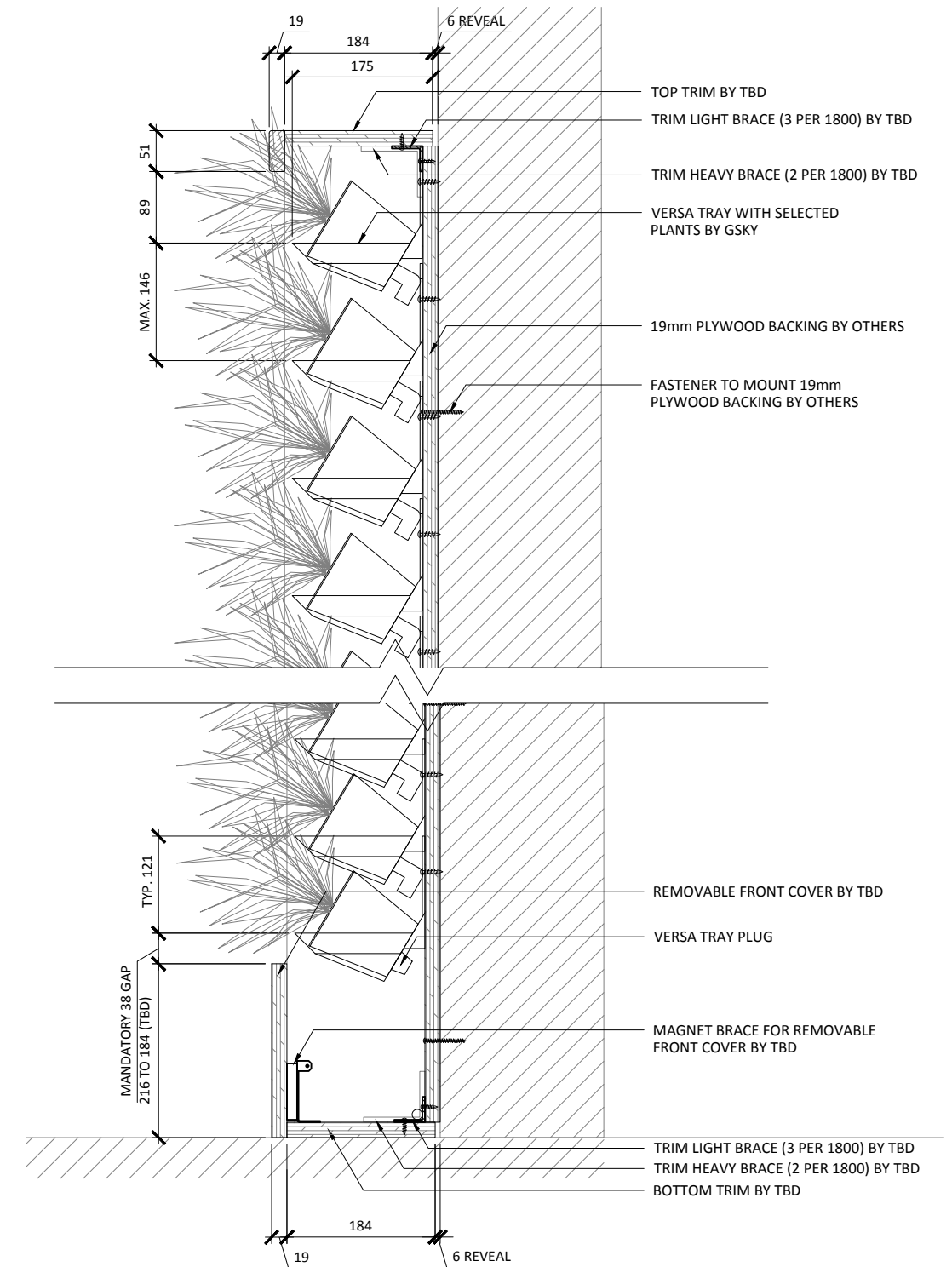

2 SECTION DETAIL
SCALE: 1:8



VERSA WALL®

VTH-72 DETAILS

VER. 1.1 297x420 mm (A3)

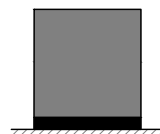

TO FLOOR

Weight is 10lbs/ft² 50kg/m²

51mm	SIDE/TOP
216mm	BOTTOM

TRIM

NOTE: pipes and edges of trays will be exposed unless recessed or covered

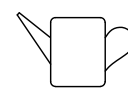

HAND WATER

For 10 - 50 ft² / 1 - 5 m²
Min width 10" / 25cm

SERVICE			
MANUAL	N/A	N/A	N/A
AUTOMATED	At Wall	At Wall	At Wall

IRRIGATION

It is recommended to install a drain whenever possible. Require GSKY's consultation for > 35' / 10.5 m height wall.



LIGHTING

LED or Metal Halide Lights recommended

Duration	10-12 hrs/day
Color Temp	4000-4500K
Intensity	150fc / 1500 lux (Even Flood)

< 2400	OK			
< 4000	OK	OK		
> 4000		OK	OK	OK

MAINT. ACCESS

Walls over 40' / 12m need additional considerations. See GSKY maintenance manual.

GV3.1