

VERSA DRIPLINE

MAGNET BRACE FOR REMOVABLE FRONT COVER BY TBD

BOTTOM TRIM BY TBD

REMOVABLE FRONT COVER BY TBD

GSKY NUTRIENT INJECTOR



**VERSA** WALL<sup>®</sup>

ABOVE THE FLOOR / REMOTE ICU  
VAR-4N

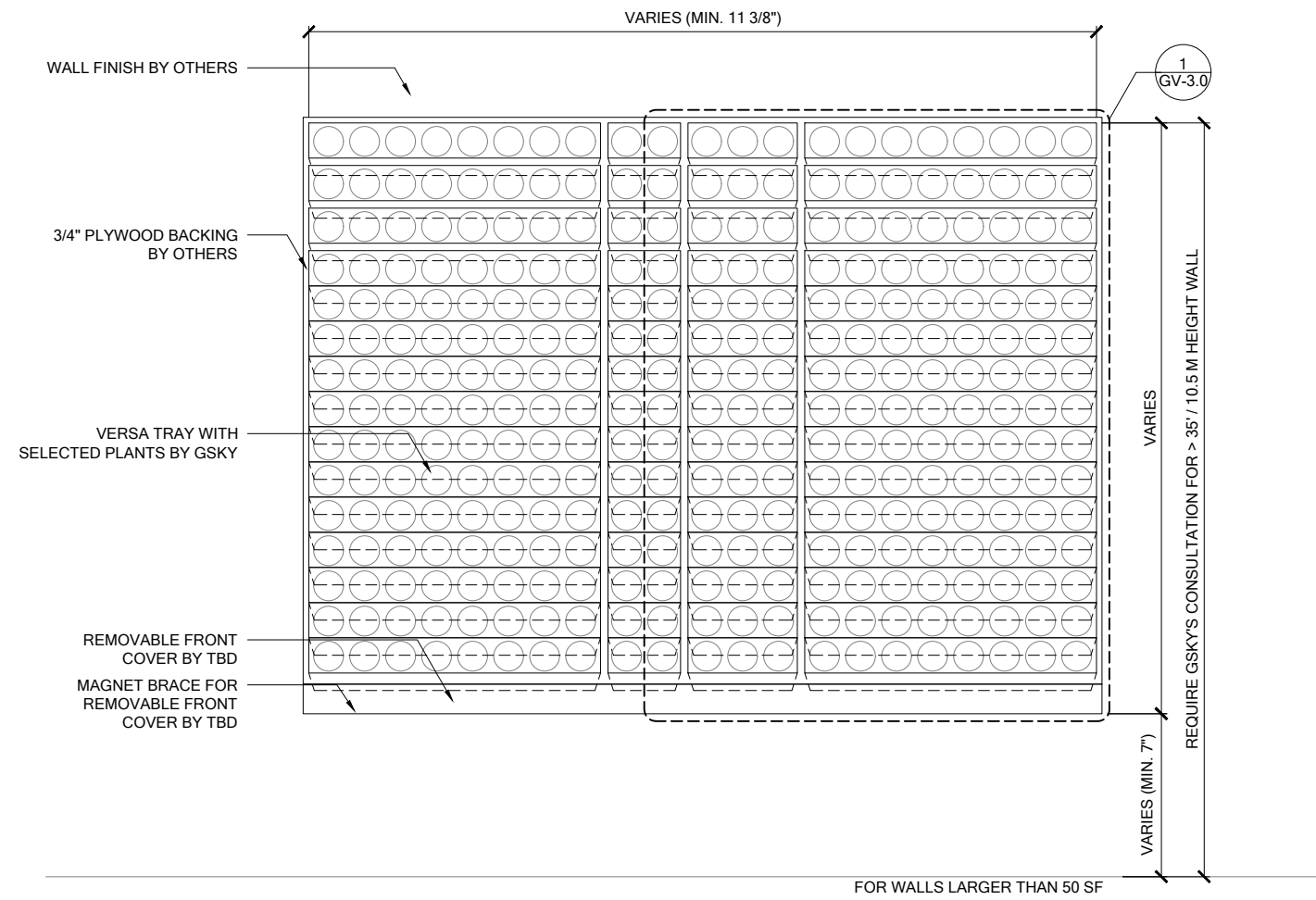

**1 ELEVATION**  
SCALE 1/2" = 1'-0"

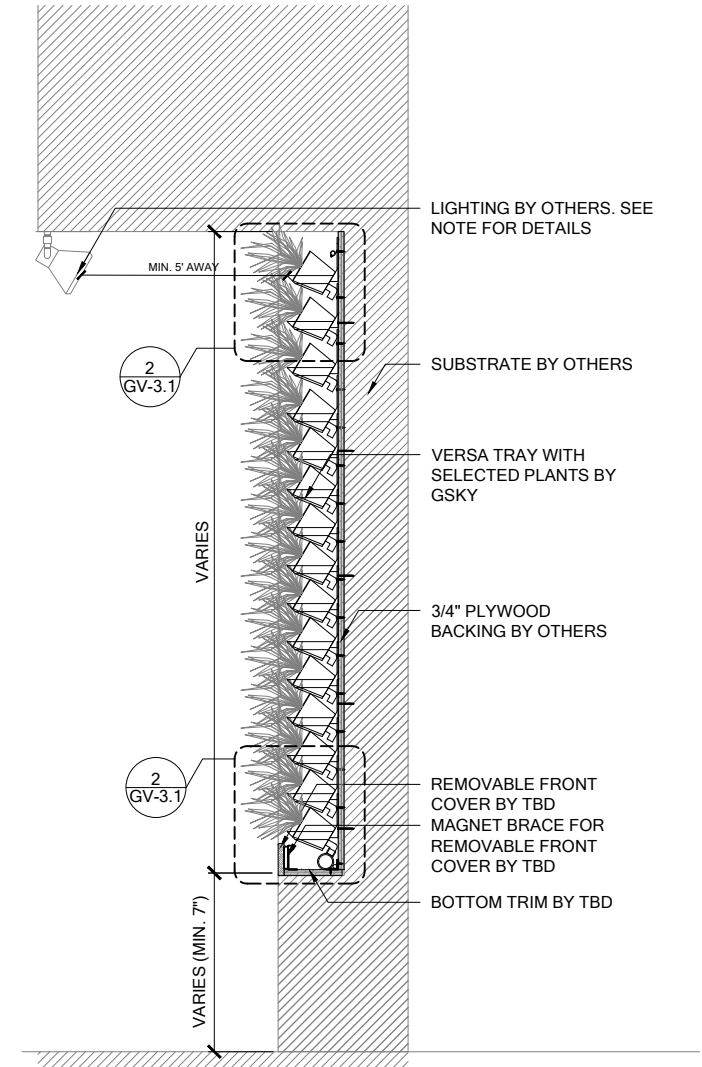

**3 SECTION**  
SCALE 1/2" = 1'-0"

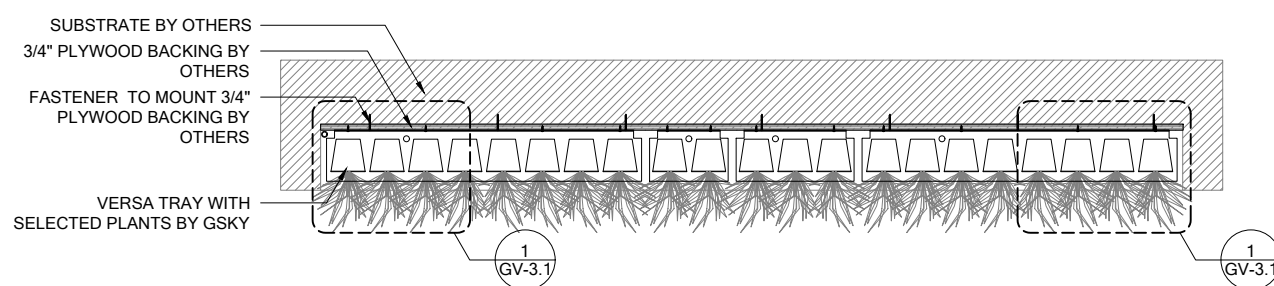

**2 PLAN**  
SCALE 1/2" = 1'-0"



**VERSA WALL**<sup>®</sup>  
VAR-4N GENERAL OVERVIEW  
VER. 1.1      11x17" (A3)

**ABOVE FLOOR**  
Weight is 10lbs/ft<sup>2</sup> 50kg/m<sup>2</sup>

**TRIM**  
4"  
NOTE: pipes and edges of trays will be exposed unless recessed or covered.

**REMOTE ICU**  
For 50 ft<sup>2</sup> / 5 m<sup>2</sup> to any size  
Min width 11 3/8" / 29cm

SERVICE			
MANUAL	N/A	N/A	N/A
AUTOMATED	At ICU	At ICU	At Wall

**IRRIGATION**  
It is recommended to install a drain whenever possible. Require GSKy's consultation for > 35' / 10.5 m height wall.

**LIGHTING**  
LED or Metal Halide Lights recommended

Duration  
10-12 hrs/day  
Color Temp  
4000-4500K  
Intensity  
150fc / 1500 lux (Even Flood)

< 8'	OK		
< 13'	OK	OK	
> 13'		OK	OK

**MAINT. ACCESS**  
Walls over 40' / 12m need additional considerations. See GSKy maintenance manual.

**GV1.0**

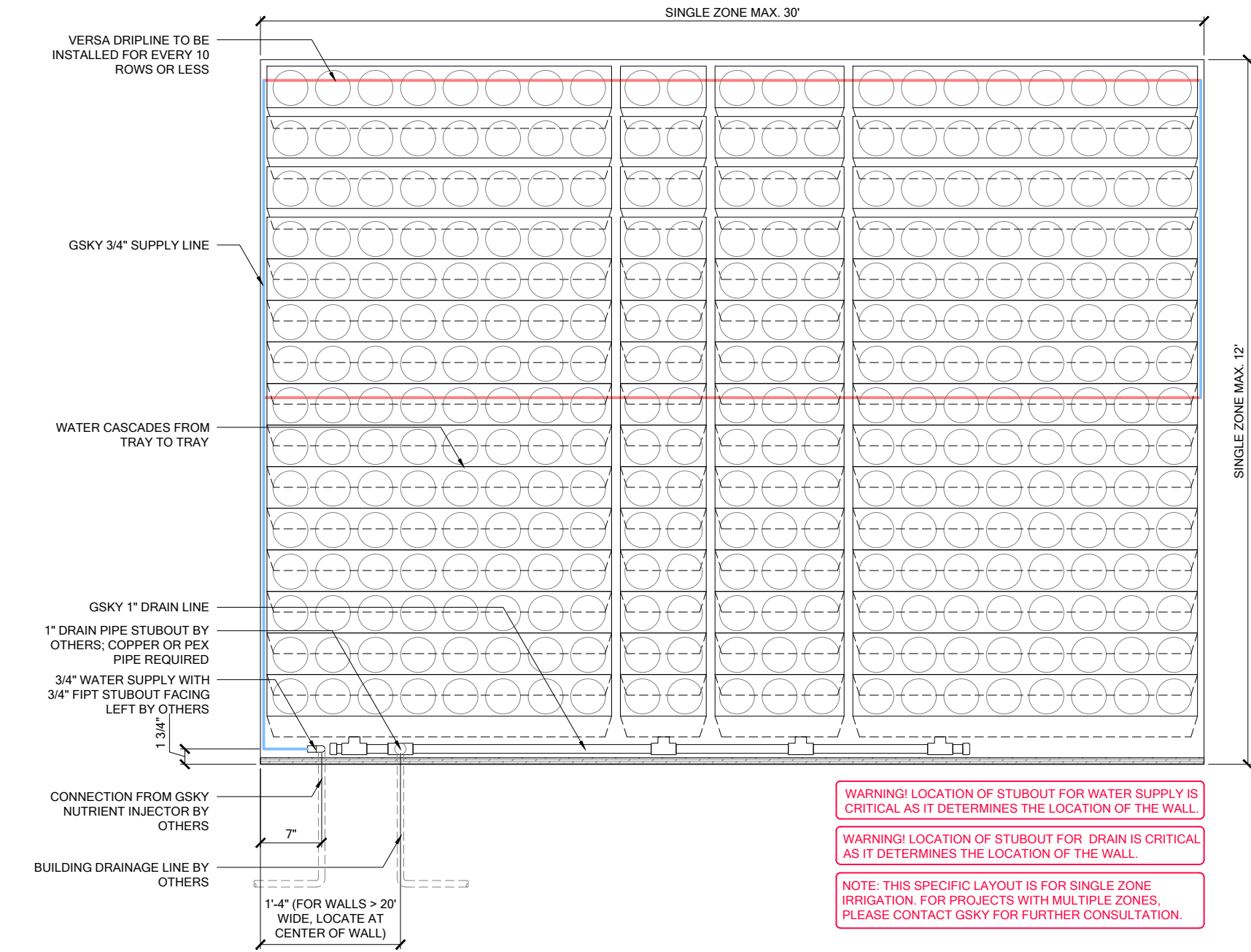

1 ELEVATION  
SCALE 3/4" = 1'-0"

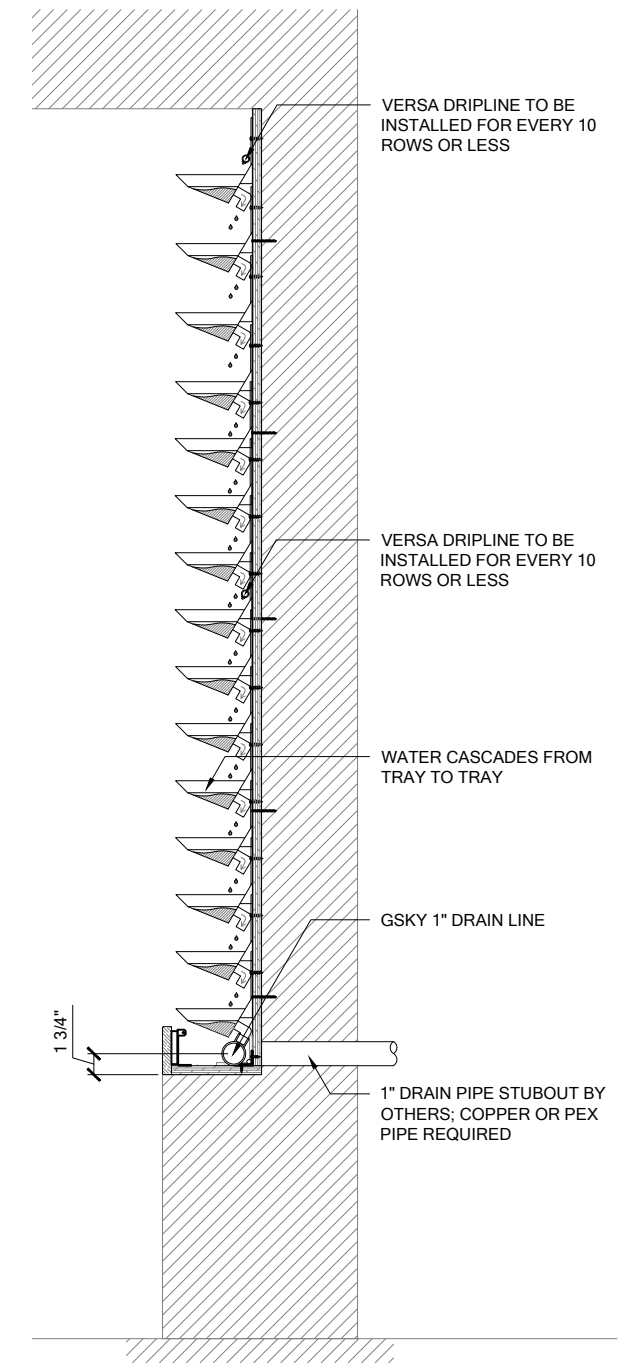

2 SECTION  
SCALE 3/4" = 1'-0"



**VERSA WALL**<sup>®</sup>  
VAR-4N IRRIGATION OVERVIEW  
VER. 1.1      11x17" (A3)

**ABOVE FLOOR**  
Weight is 10lbs/ft<sup>2</sup> 50kg/m<sup>2</sup>

4" TRIM  
NOTE: pipes and edges of trays will be exposed unless recessed or covered.

REMOTE ICU  
For 50 ft<sup>2</sup> / 5 m<sup>2</sup> to any size  
Min width 11 1/8" / 29cm

SERVICE			
MANUAL	N/A	N/A	N/A
AUTOMATED	At ICU	At ICU	At Wall

**IRRIGATION**  
It is recommended to install a drain whenever possible. Require Gsky's consultation for > 35' / 10.5 m height wall.

**LIGHTING**  
LED or Metal Halide Lights recommended

Duration  
10-12 hrs/day  
Color Temp  
4000-4500K  
Intensity  
150fc / 1500 lux (Even Flood)

< 8'	OK			
< 13'	OK	OK		
> 13'		OK	OK	OK

**MAINT. ACCESS**  
Walls over 40' / 12m need additional considerations. See Gsky maintenance manual.

**GV2.0**

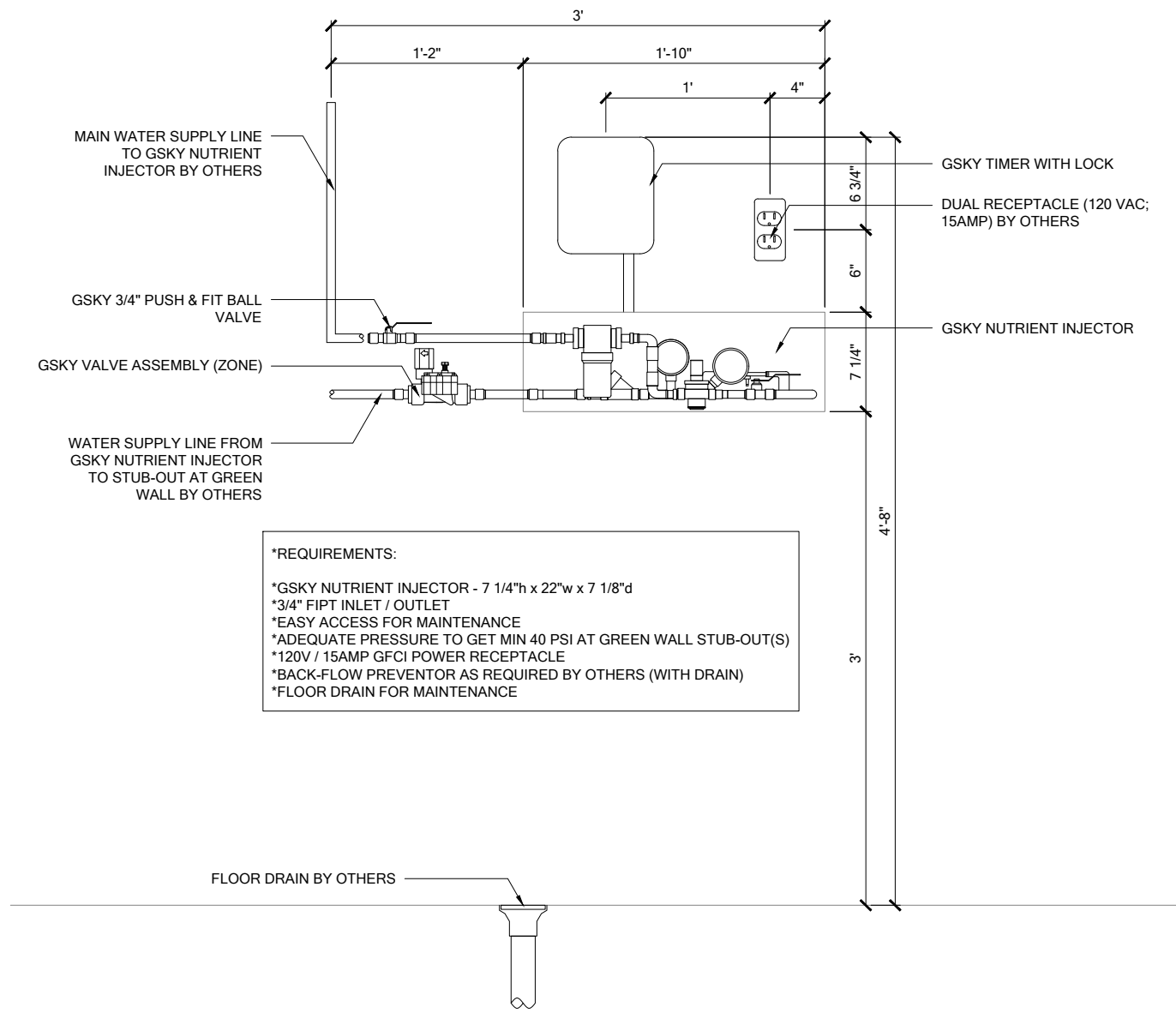

**\*REQUIREMENTS:**  
 \*GSKY NUTRIENT INJECTOR - 7 1/4"h x 22"w x 7 1/8"d  
 \*3/4" FIPT INLET / OUTLET  
 \*EASY ACCESS FOR MAINTENANCE  
 \*ADEQUATE PRESSURE TO GET MIN 40 PSI AT GREEN WALL STUB-OUT(S)  
 \*120V / 15AMP GFCI POWER RECEPTACLE  
 \*BACK-FLOW PREVENTOR AS REQUIRED BY OTHERS (WITH DRAIN)  
 \*FLOOR DRAIN FOR MAINTENANCE

**1 SINGLE ZONE - ELEVATION**  
 SCALE 1 1/2" = 1'-0"

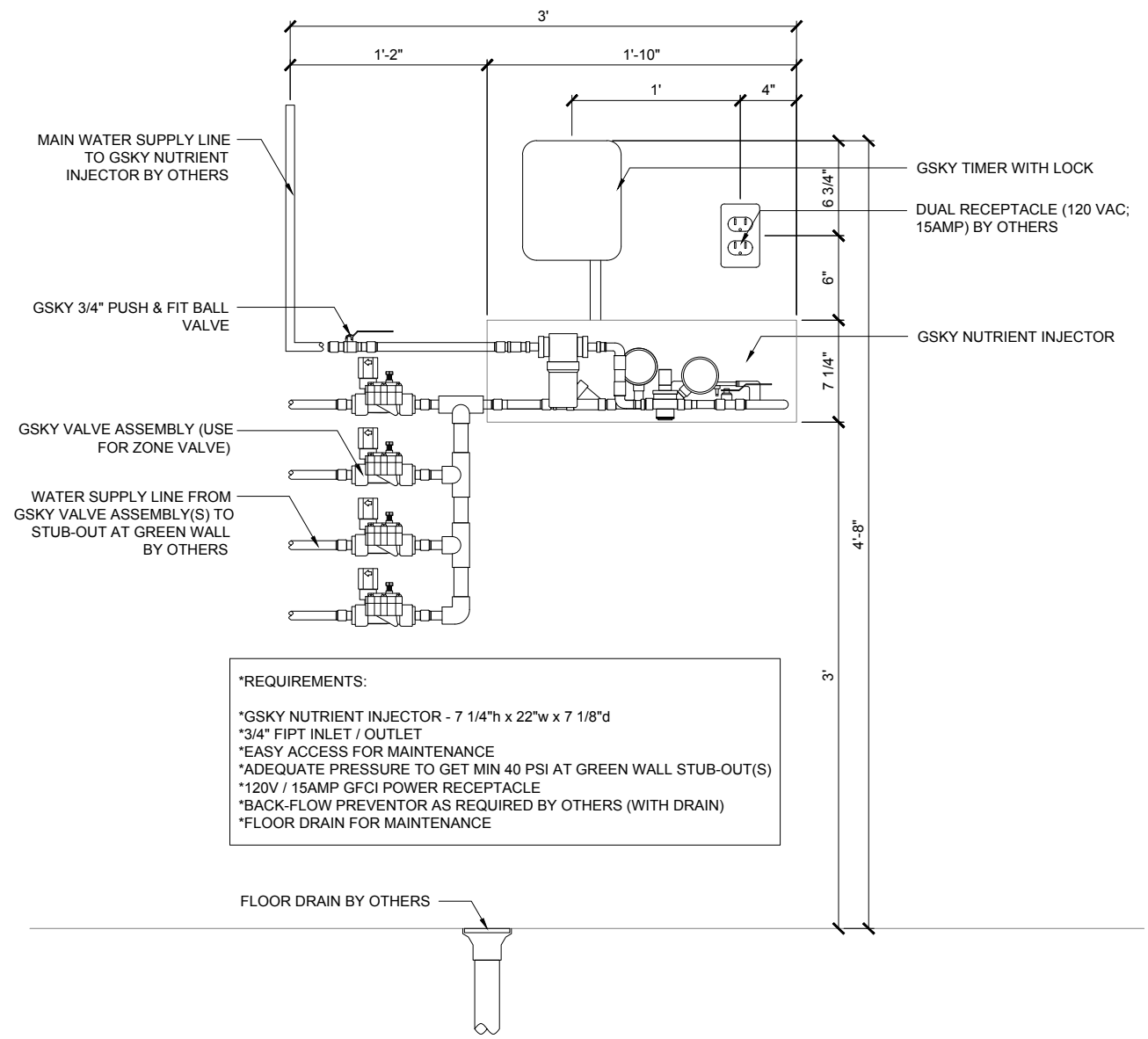

**\*REQUIREMENTS:**  
 \*GSKY NUTRIENT INJECTOR - 7 1/4"h x 22"w x 7 1/8"d  
 \*3/4" FIPT INLET / OUTLET  
 \*EASY ACCESS FOR MAINTENANCE  
 \*ADEQUATE PRESSURE TO GET MIN 40 PSI AT GREEN WALL STUB-OUT(S)  
 \*120V / 15AMP GFCI POWER RECEPTACLE  
 \*BACK-FLOW PREVENTOR AS REQUIRED BY OTHERS (WITH DRAIN)  
 \*FLOOR DRAIN FOR MAINTENANCE

**2 MULTI-ZONE - ELEVATION**  
 SCALE 1 1/2" = 1'-0"



**VERSA WALL**<sup>®</sup>  
 VAR-4N IRRIGATION SYSTEM  
 VER. 1.1      11x17" (A3)

**ABOVE FLOOR**  
 Weight is 10lbs/ft² 50kg/m²

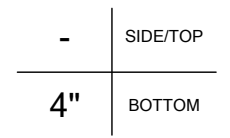

**TRIM**  
 NOTE: pipes and edges of trays will be exposed unless recessed or covered.

**REMOTE ICU**  
 For 50 ft² / 5 m² to any size  
 Min width 11 1/8" / 29cm

SERVICE			
MANUAL	N/A	N/A	N/A
AUTOMATED	At ICU	At ICU	At Wall

**IRRIGATION**  
 It is recommended to install a drain whenever possible. Require Gsky's consultation for > 35' / 10.5 m height wall.

**LIGHTING**  
 LED or Metal Halide Lights recommended  
 Duration 10-12 hrs/day  
 Color Temp 4000-4500K  
 Intensity 150fc / 1500 lux (Even Flood)

< 8'	OK		
< 13'	OK	OK	
> 13'		OK	OK

**MAINT. ACCESS**  
 Walls over 40' / 12m need additional considerations. See Gsky maintenance manual.

**GV2.1**

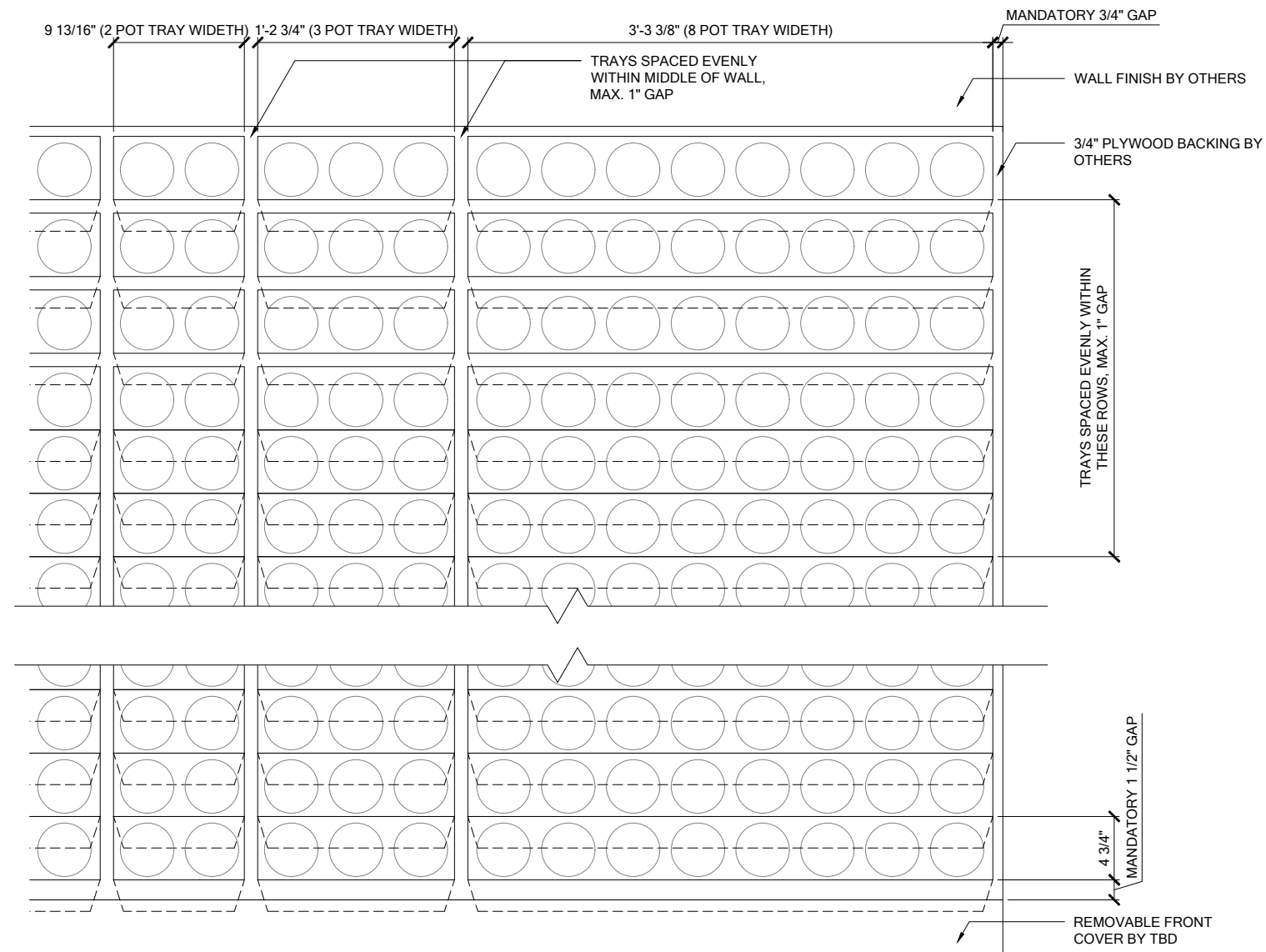

**1 TRAY LAYOUT**  
SCALE 1" = 1'-0"



**VERSA WALL<sup>®</sup>**

VAR-4N TRAY LAYOUT

VER. 1.1

11x17" (A3)



**ABOVE FLOOR**

Weight is 10lbs/ft<sup>2</sup> 50kg/m<sup>2</sup>

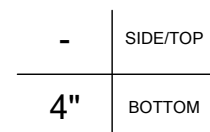

**TRIM**

NOTE: pipes and edges of trays will be exposed unless recessed or covered.



**REMOTE ICU**

For 50 ft<sup>2</sup> / 5 m<sup>2</sup> to any size  
Min width 11 1/4" / 29cm

SERVICE			
MANUAL	N/A	N/A	N/A
AUTOMATED	At ICU	At ICU	At Wall

**IRRIGATION**

It is recommended to install a drain whenever possible. Require GSky's consultation for > 35' / 10.5 m height wall.

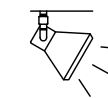

**LIGHTING**

LED or Metal Halide Lights recommended

Duration  
10-12 hrs/day  
Color Temp  
4000-4500K  
Intensity  
150fc / 1500 lux  
(Even Flood)

< 8'	OK			
< 13'	OK	OK		
> 13'		OK	OK	OK

**MAINT. ACCESS**

Walls over 40' / 12m need additional considerations. See GSky maintenance manual.

**GV3.0**

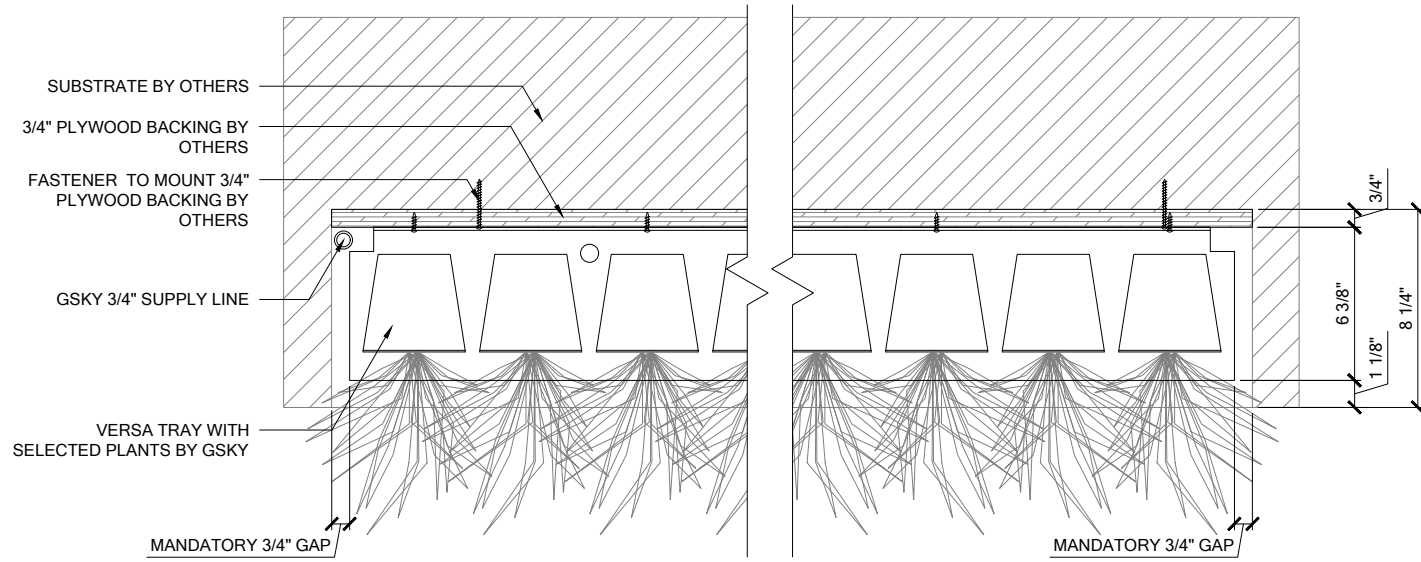

**1 PLAN**  
SCALE 1 1/2" = 1'-0"

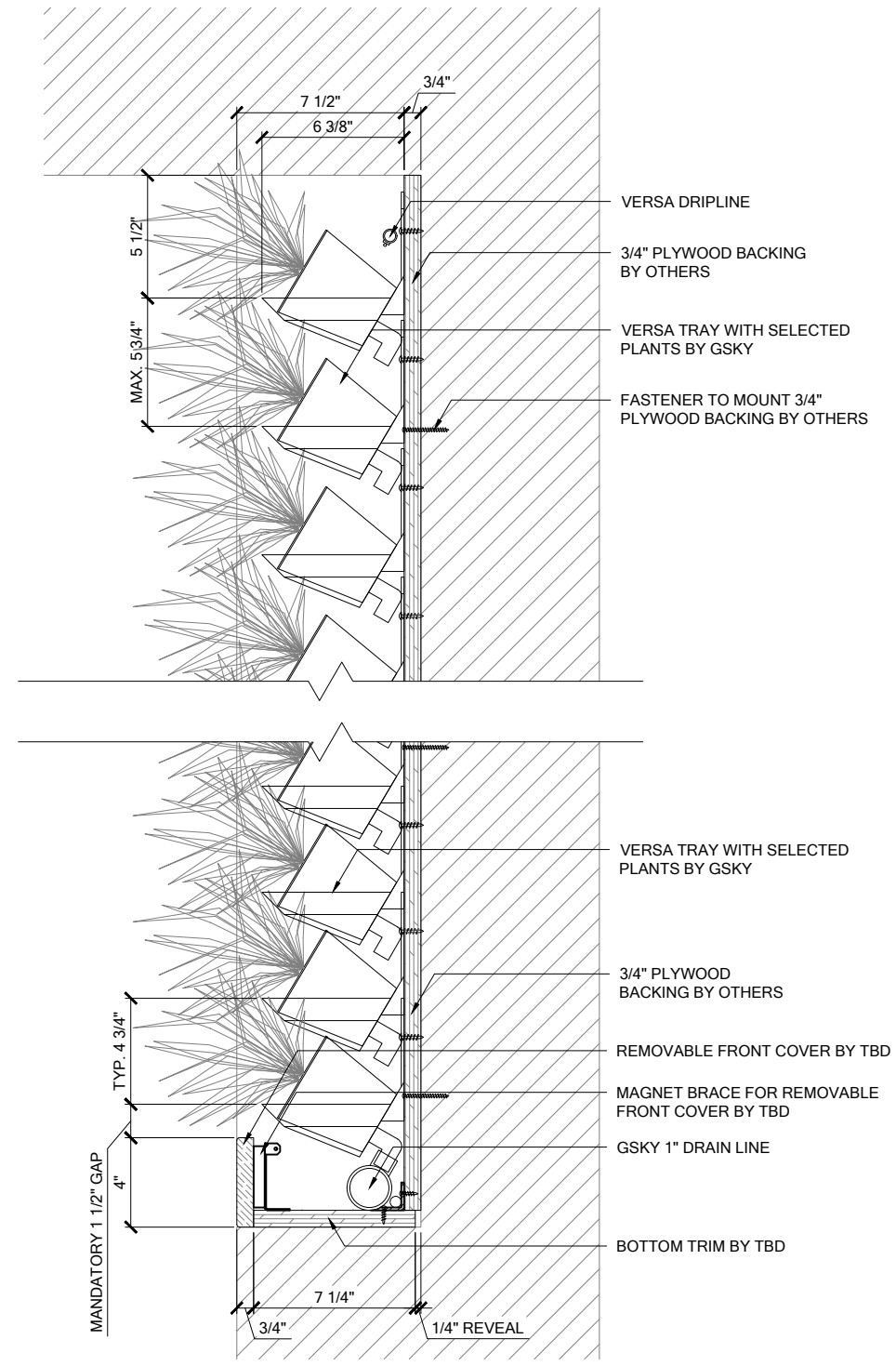

**2 SECTION**  
SCALE 1 1/2" = 1'-0"



# VERSA WALL®

## VAR-4N DETAILS

VER. 1.1      11x17" (A3)

**ABOVE FLOOR**  
Weight is 10lbs/ft² 50kg/m²

-      SIDE/TOP  
4"      BOTTOM

**TRIM**  
NOTE: pipes and edges of trays will be exposed unless recessed or covered.

**REMOTE ICU**  
For 50 ft² / 5 m² to any size  
Min width 11 3/4" / 29cm

SERVICE			
MANUAL	N/A	N/A	N/A
AUTOMATED	At ICU	At ICU	At Wall

**IRRIGATION**  
It is recommended to install a drain whenever possible. Require GSKy's consultation for > 35' / 10.5 m height wall.

**LIGHTING**  
LED or Metal Halide Lights recommended

Duration  
10-12 hrs/day  
Color Temp  
4000-4500K  
Intensity  
150fc / 1500 lux (Even Flood)

< 8'	OK			
< 13'	OK	OK		
> 13'		OK	OK	OK

**MAINT. ACCESS**  
Walls over 40' / 12m need additional considerations. See GSKy maintenance manual.

# GV3.1