

VERSA WALL®

ABOVE THE FLOOR / REMOTE ICU
VAR-42

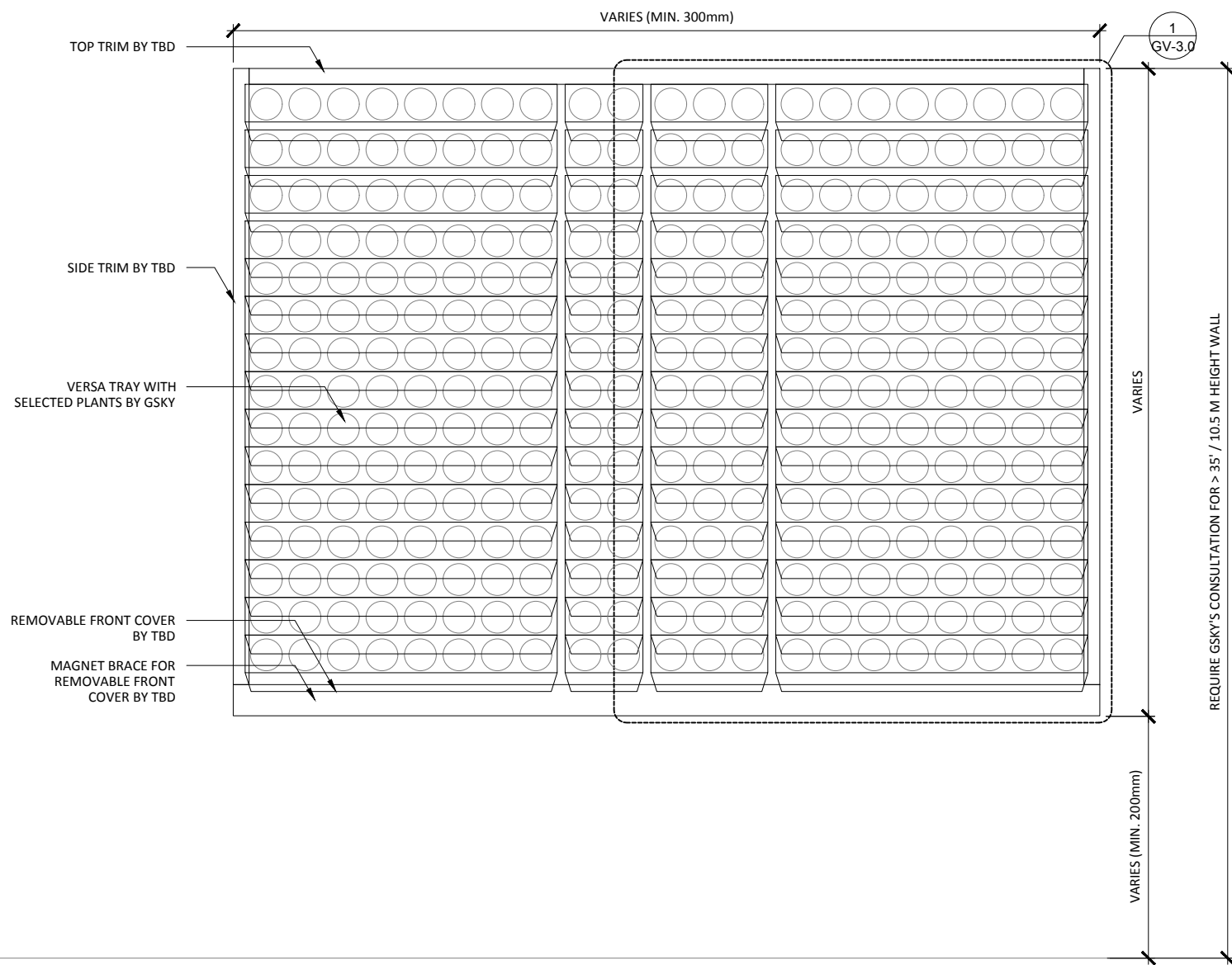

1 ELEVATION
SCALE: 1:20

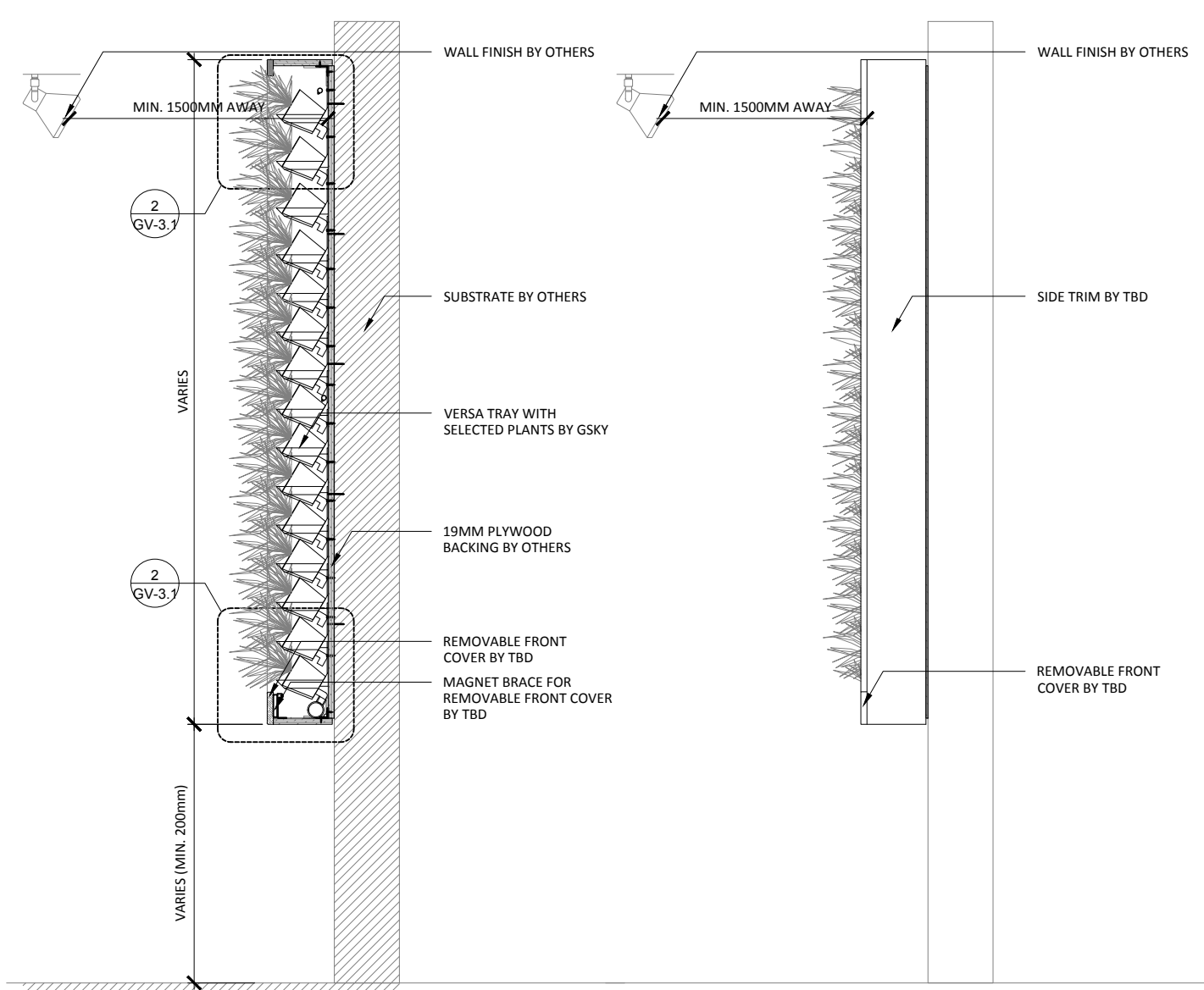

3 SECTION
SCALE: 1:20

4 SIDE ELEVATION
SCALE: 1:20

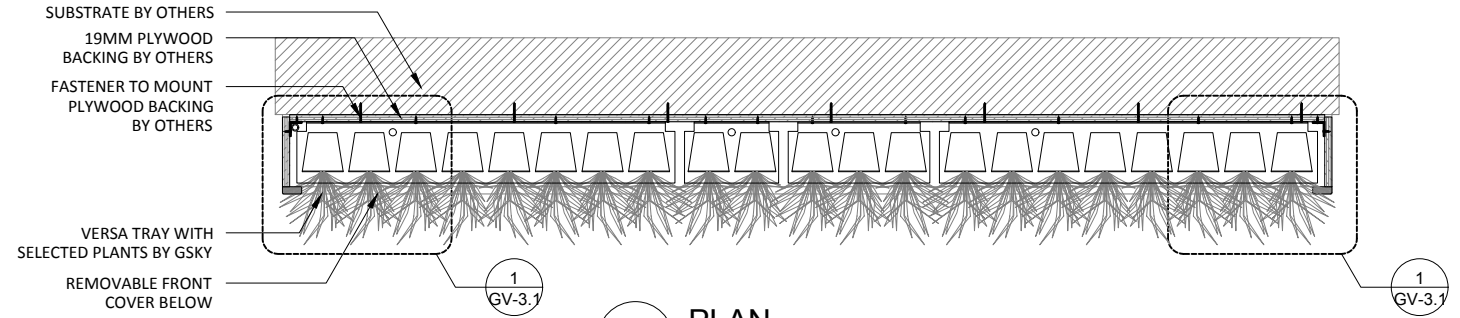

2 PLAN
SCALE: 1:20



VERSA WALL[®]
VAR-42 GENERAL OVER VIEW
VER. 1.1 297x420 mm (A3)

ABOVE FLOOR
Weight is 10lbs/ft² 50kg/m²

51mm	SIDE/TOP
100mm	BOTTOM

TRIM
NOTE: pipes and edges of trays will be exposed unless recessed or covered

ICU BELOW WALL
For 50 ft² / 5 m² to 5000 ft² / 500 m²
Min width 50 3/4" / 129cm

SERVICE			
MANUAL	N/A	N/A	N/A
AUTOMATED	At Wall	At Wall	At Wall

IRRIGATION
It is recommended to install a drain whenever possible. Require GSKY's consultation for > 35' / 10.5 m height wall.

LIGHTING
LED or Metal Halide Lights recommended

Duration	10-12 hrs/day
Color Temp	4000-4500K
Intensity	150fc / 1500 lux (Even Flood)

MAINT. ACCESS
Walls over 40' / 12m need additional considerations. See GSKY maintenance manual.

< 2400	OK		
< 4000	OK	OK	
> 4000		OK	OK

GV1.0

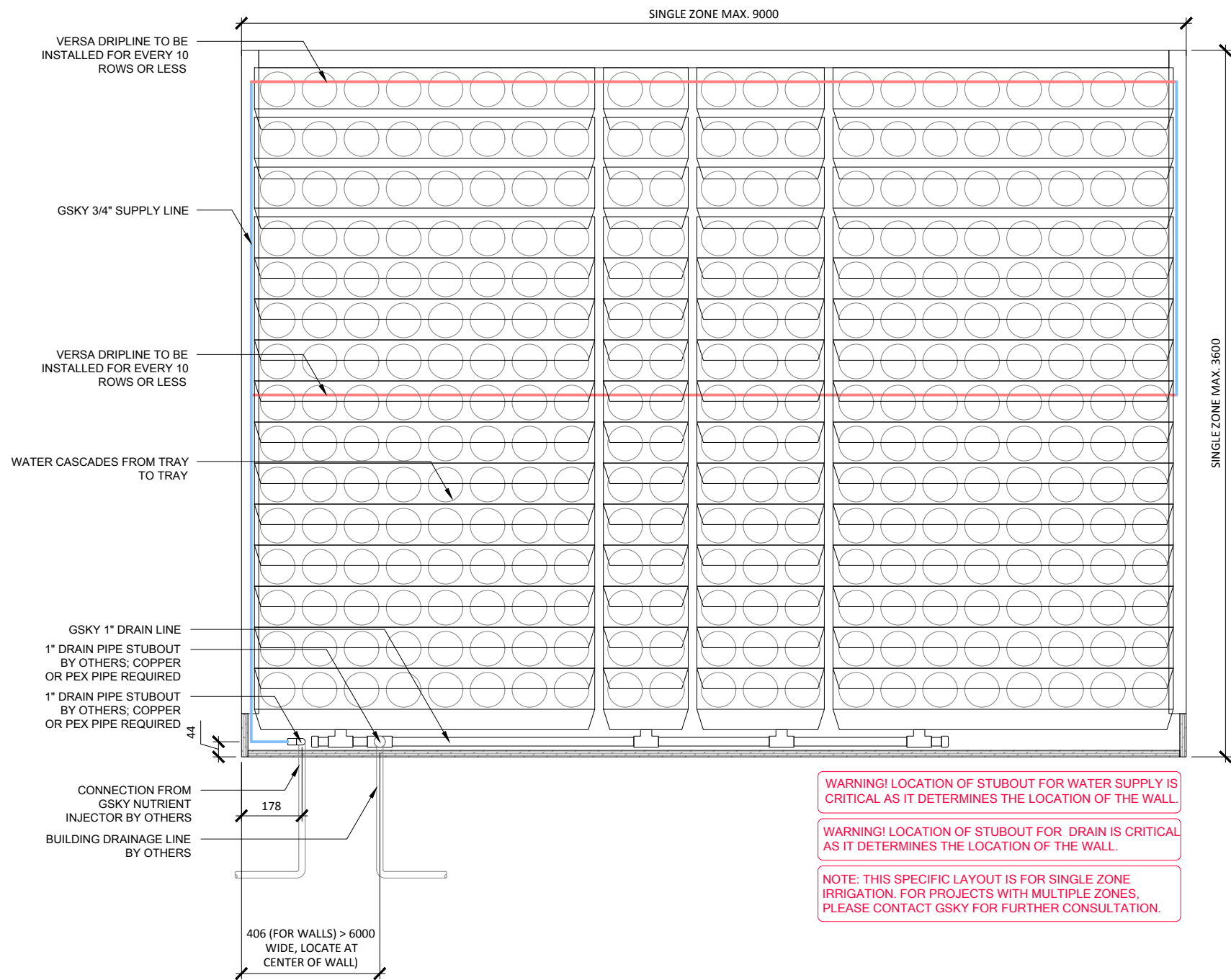

1 ELEVATION
SCALE: 1:16

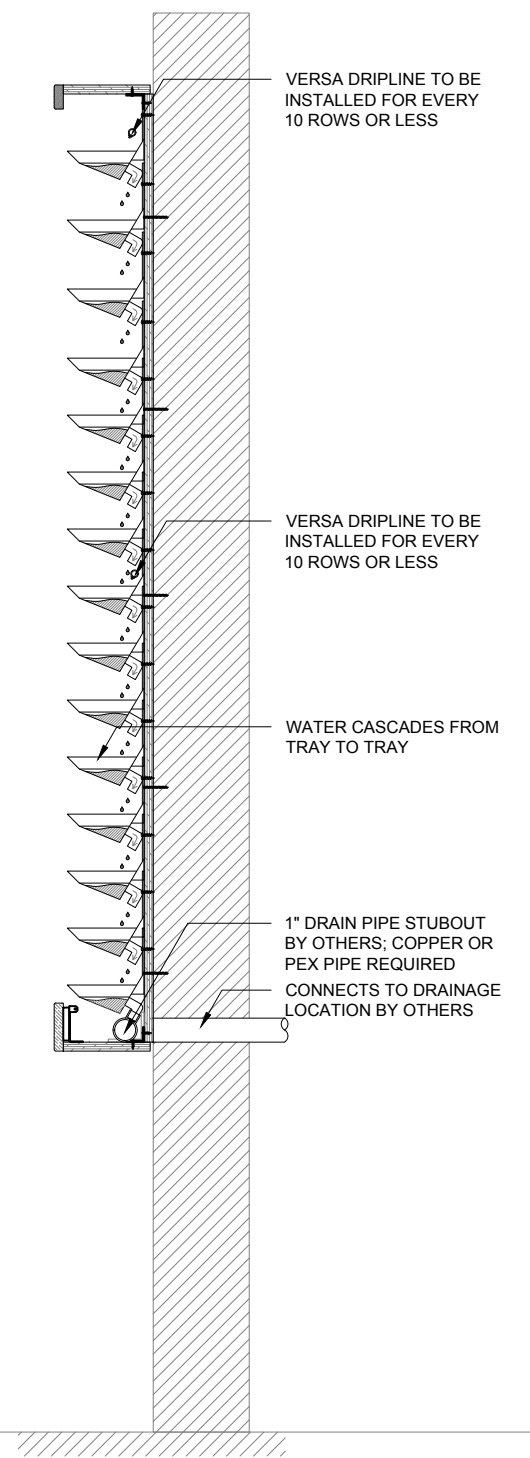

2 SECTION
SCALE: 1:16



VERSA WALL[®]
VAR-42 IRRIGATION OVERVIEW
VER. 1.1 297x420 mm (A3)

ABOVE FLOOR
Weight is 10lbs/ft² 50kg/m²

51mm SIDE/TOP
100mm BOTTOM

TRIM
NOTE: pipes and edges of trays will be exposed unless recessed or covered

ICU BELOW WALL
For 50 ft² / 5 m² to 5000 ft² / 500 m²
Min width 50 3/4" / 129cm

SERVICE			
MANUAL	N/A	N/A	N/A
AUTOMATED	At Wall	At Wall	At Wall

IRRIGATION
It is recommended to install a drain whenever possible. Require GSKy's consultation for > 35' / 10.5 m height wall.

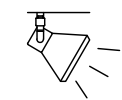

LIGHTING
LED or Metal Halide Lights recommended

Duration
10-12 hrs/day
Color Temp
4000-4500K
Intensity
150fc / 1500 lux (Even Flood)

< 2400	OK			
< 4000	OK	OK		
> 4000		OK	OK	OK

MAINT. ACCESS
Walls over 40' / 12m need additional considerations. See GSKy maintenance manual.

GV2.0

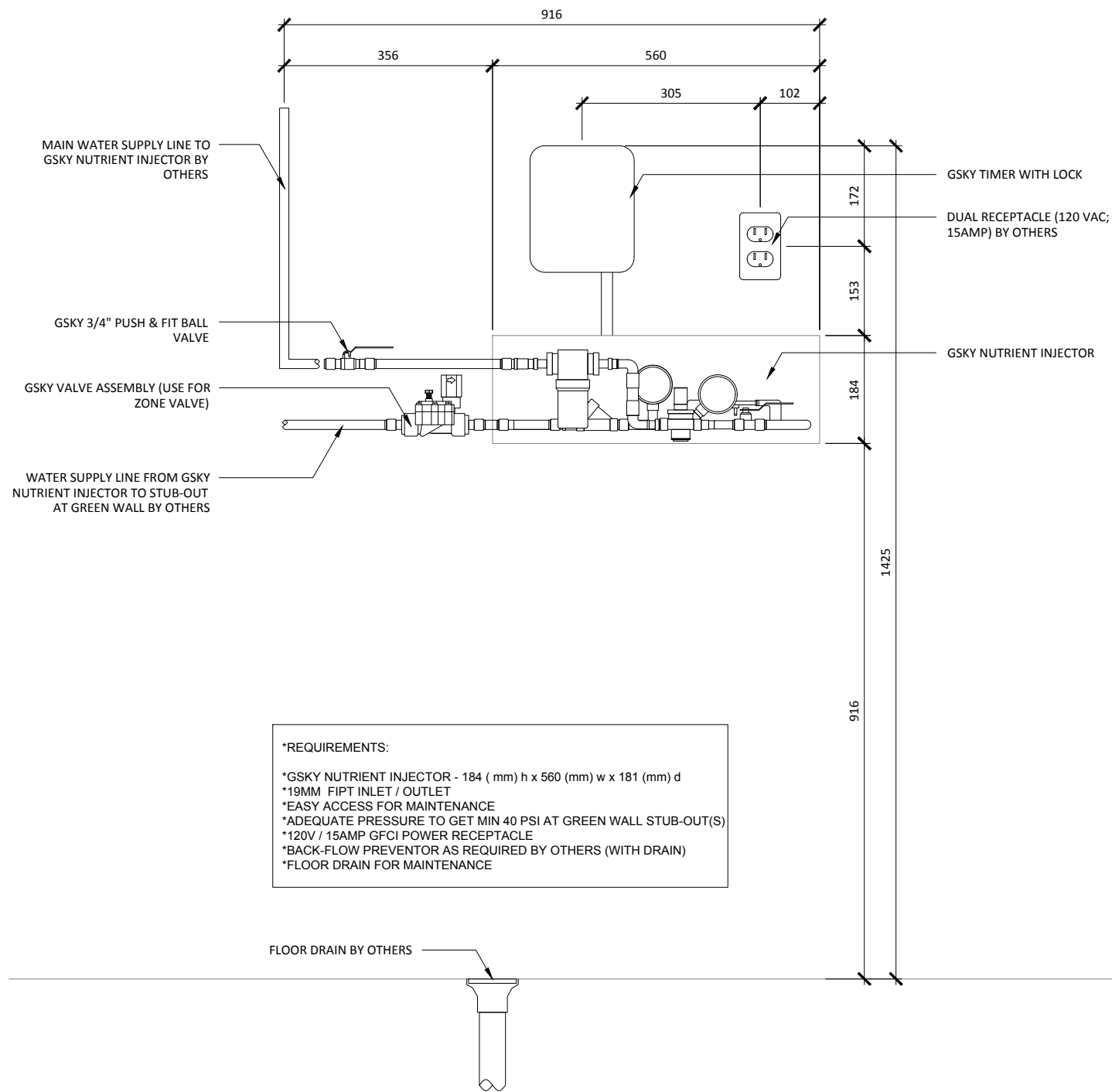

***REQUIREMENTS:**
 *GSKY NUTRIENT INJECTOR - 184 (mm) h x 560 (mm) w x 181 (mm) d
 *19MM FIPT INLET / OUTLET
 *EASY ACCESS FOR MAINTENANCE
 *ADEQUATE PRESSURE TO GET MIN 40 PSI AT GREEN WALL STUB-OUT(S)
 *120V / 15AMP GFCI POWER RECEPTACLE
 *BACK-FLOW PREVENTOR AS REQUIRED BY OTHERS (WITH DRAIN)
 *FLOOR DRAIN FOR MAINTENANCE

1 SINGLE ZONE ELEVATION
 SCALE 1:10

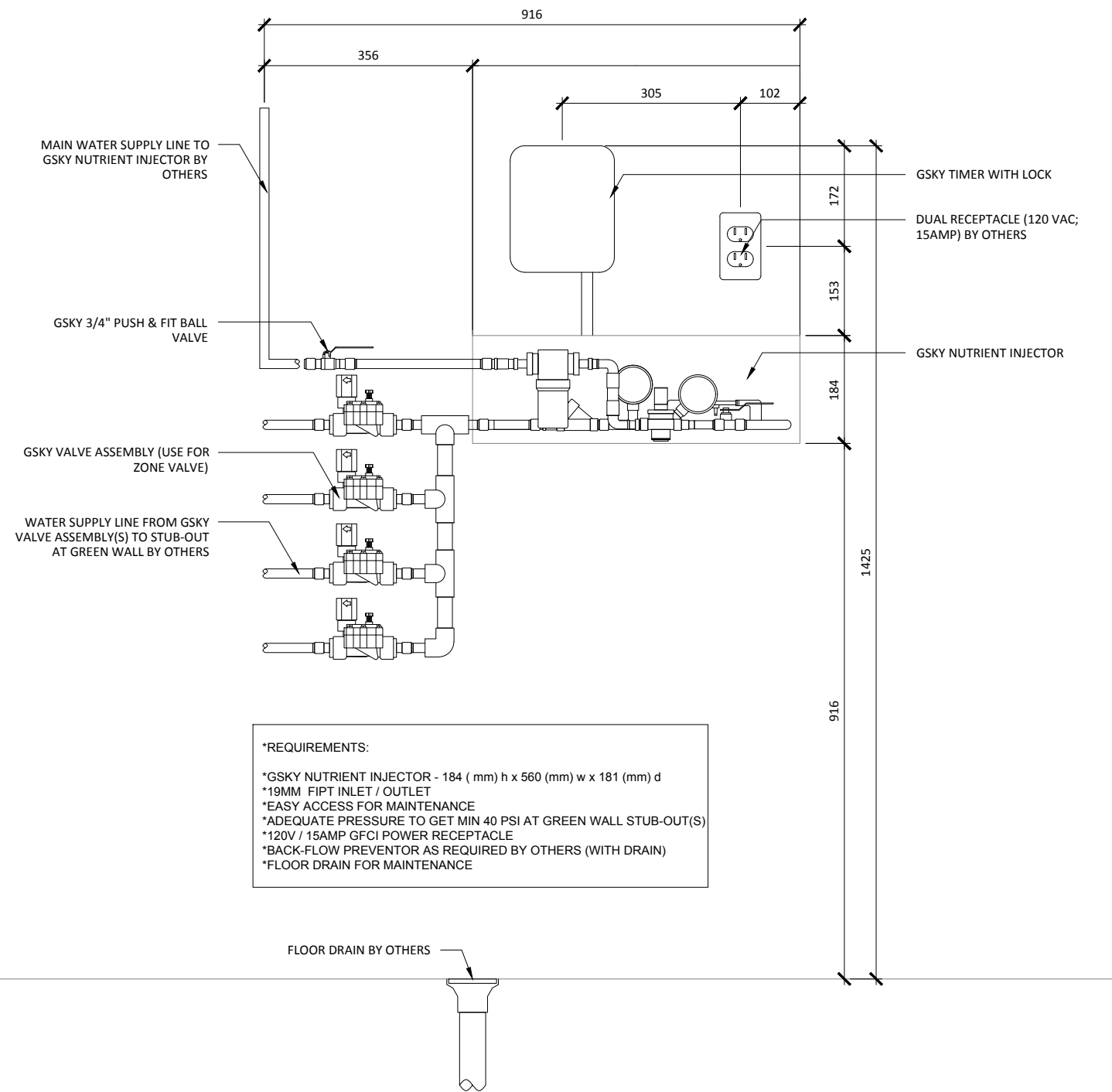

***REQUIREMENTS:**
 *GSKY NUTRIENT INJECTOR - 184 (mm) h x 560 (mm) w x 181 (mm) d
 *19MM FIPT INLET / OUTLET
 *EASY ACCESS FOR MAINTENANCE
 *ADEQUATE PRESSURE TO GET MIN 40 PSI AT GREEN WALL STUB-OUT(S)
 *120V / 15AMP GFCI POWER RECEPTACLE
 *BACK-FLOW PREVENTOR AS REQUIRED BY OTHERS (WITH DRAIN)
 *FLOOR DRAIN FOR MAINTENANCE

2 MULTI-ZONE ELEVATION
 SCALE 1:10



VERSA WALL®

VAR-42 IRRIGATION SYSTEM

VER. 1.1 297x420 mm (A3)



ABOVE FLOOR

Weight is 10lbs/ft² 50kg/m²

51mm	SIDE/TOP
100mm	BOTTOM

TRIM

NOTE: pipes and edges of trays will be exposed unless recessed or covered



ICU BELOW WALL

For 50 ft² / 5 m² to 5000 ft² / 500 m²
 Min width 50 3/4" / 129cm

SERVICE			
MANUAL	N/A	N/A	N/A
AUTOMATED	At Wall	At Wall	At Wall

IRRIGATION

It is recommended to install a drain whenever possible. Require GSKY's consultation for > 35' / 10.5 m height wall.



LIGHTING

LED or Metal Halide Lights recommended

Duration	10-12 hrs/day
Color Temp	4000-4500K
Intensity	150fc / 1500 lux (Even Flood)

< 2400	OK		
< 4000	OK	OK	
> 4000		OK	OK

MAINT. ACCESS

Walls over 40' / 12m need additional considerations. See GSKY maintenance manual.

GV2.1

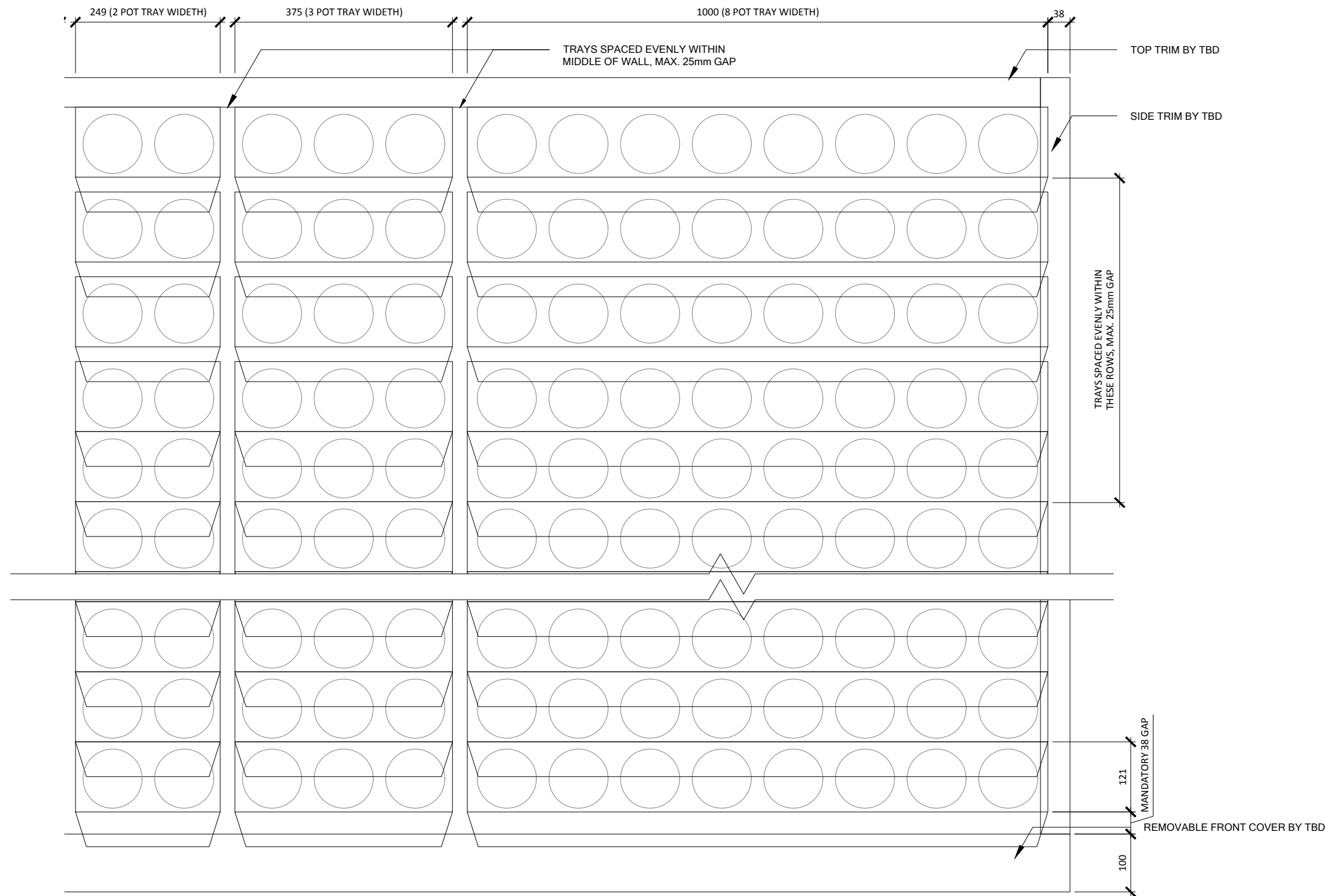

1 TRAY LAYOUT
SCALE: 1:8



VERSA WALL®

VAR-42 TRAY LAYOUT

VER. 1.1

297x420 mm (A3)

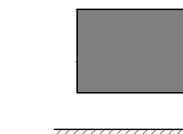

ABOVE FLOOR

Weight is 10lbs/ft² 50kg/m²

51mm	SIDE/TOP
100mm	BOTTOM

TRIM

NOTE: pipes and edges of trays will be exposed unless recessed or covered



ICU BELOW WALL

For 50 ft² / 5 m² to 5000 ft² / 500 m²
Min width 50 3/4" / 129cm

SERVICE			
MANUAL	N/A	N/A	N/A
AUTOMATED	At Wall	At Wall	At Wall

IRRIGATION

It is recommended to install a drain whenever possible. Require GSKy's consultation for > 35' / 10.5 m height wall.



LIGHTING

LED or Metal Halide Lights recommended

Duration	10-12 hrs/day
Color Temp	4000-4500K
Intensity	150fc / 1500 lux (Even Flood)

< 2400	OK			
< 4000	OK	OK		
> 4000		OK	OK	OK

MAINT. ACCESS

Walls over 40' / 12m need additional considerations. See GSKy maintenance manual.

GV3.0

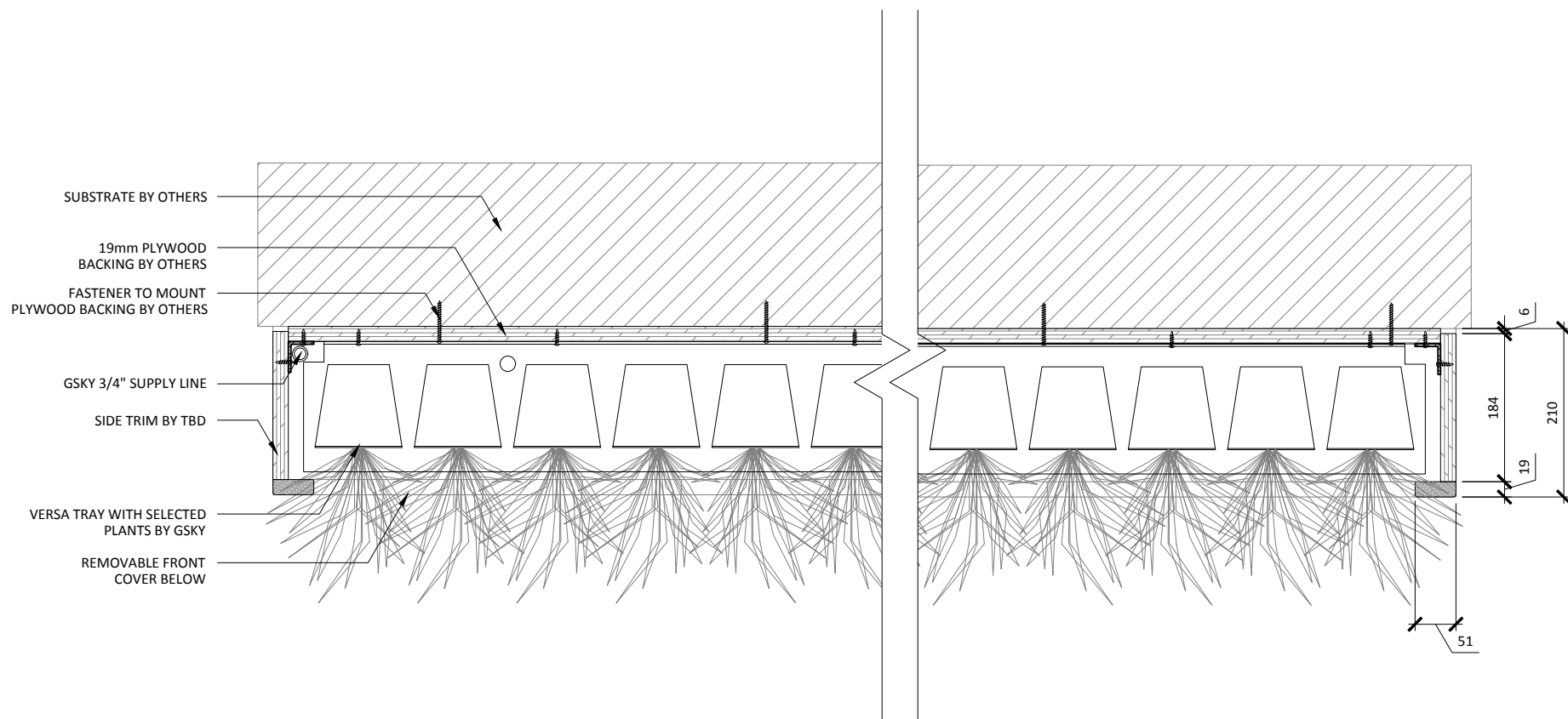

1 PLAN DETAIL
SCALE: 1:8

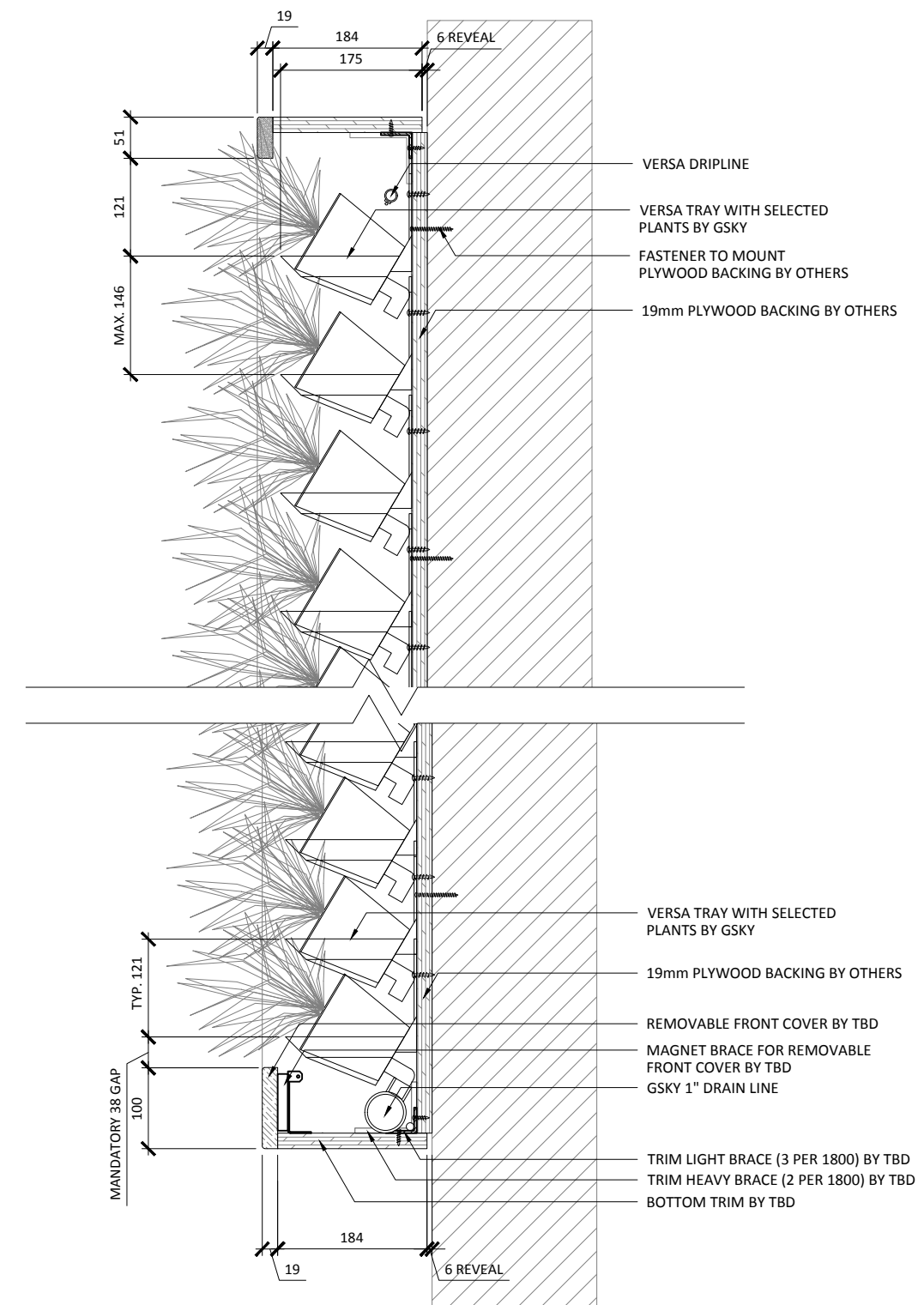

2 SECTION DETAIL
SCALE: 1:8



VERSA WALL®

VAR-42 DETAILS

VER. 1.1

297x420 mm (A3)

ABOVE FLOOR

Weight is 10lbs/ft² 50kg/m²



51mm	SIDE/TOP
100mm	BOTTOM

TRIM

NOTE: pipes and edges of trays will be exposed unless recessed or covered



ICU BELOW WALL

For 50 ft² / 5 m² to 5000 ft² / 500 m²
Min width 50 3/4" / 129cm

SERVICE			
MANUAL	N/A	N/A	N/A
AUTOMATED	At Wall	At Wall	At Wall

IRRIGATION

It is recommended to install a drain whenever possible. Require GSKY's consultation for > 35' / 10.5 m height wall.



LIGHTING

LED or Metal Halide Lights recommended

Duration	10-12 hrs/day
Color Temp	4000-4500K
Intensity	150fc / 1500 lux (Even Flood)

< 2400	OK			
< 4000	OK	OK		
> 4000		OK	OK	OK

MAINT. ACCESS

Walls over 40' / 12m need additional considerations. See GSKY maintenance manual.

GV3.1