

VERSA TRAYS

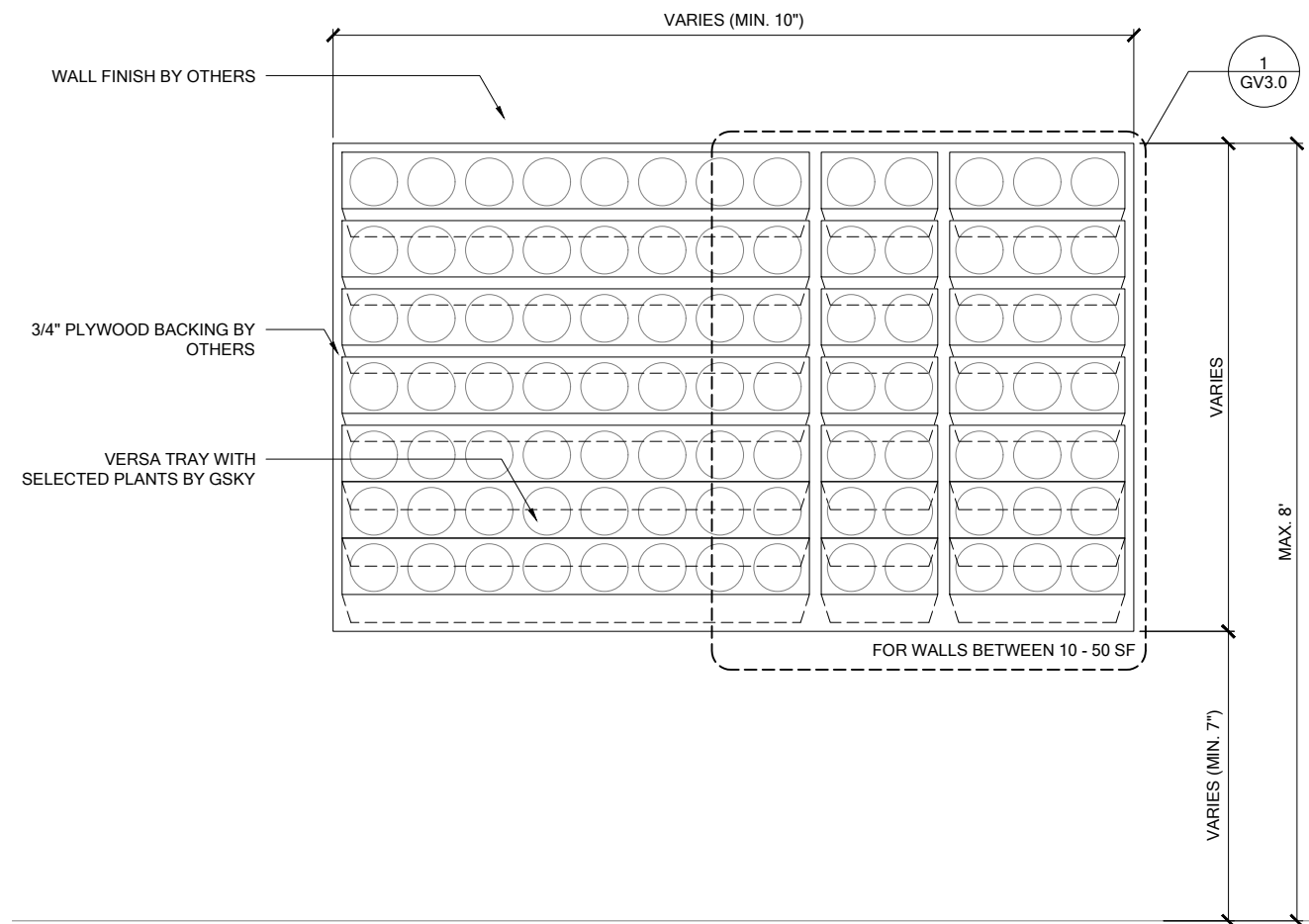

**VERSA WALL**®

ABOVE THE FLOOR / HAND WATER  
VAH-NN



**1 ELEVATION**  
SCALE 3/4" = 1'-0"

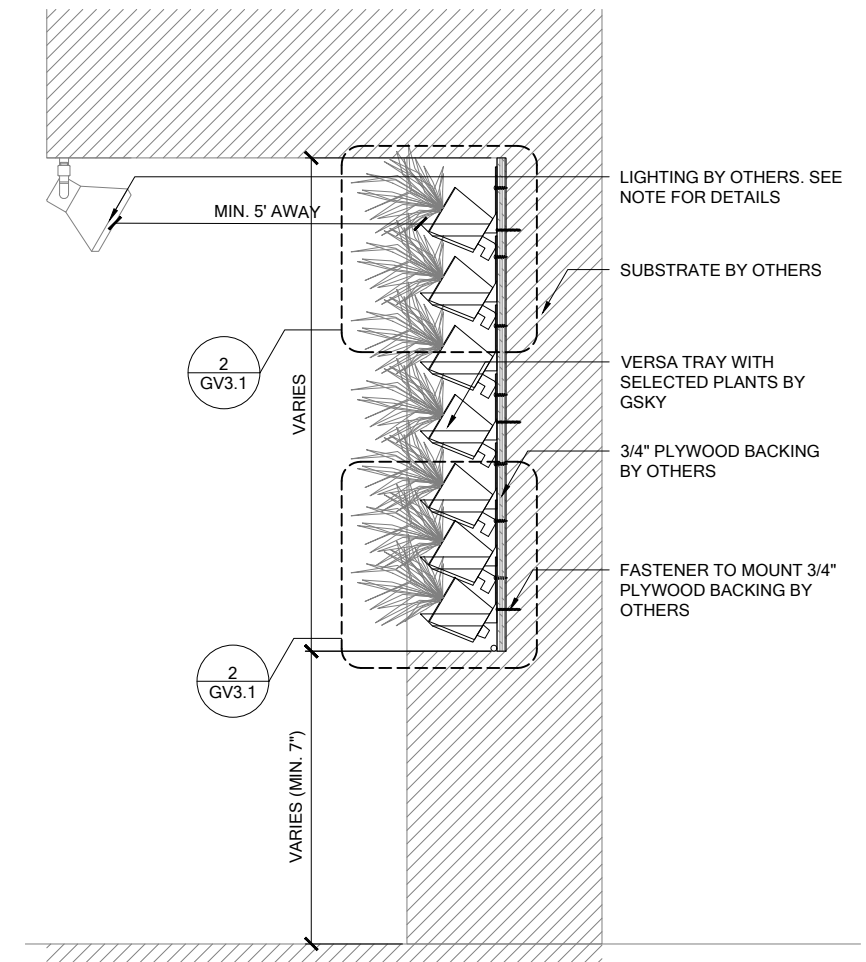

**3 SECTION**  
SCALE 3/4" = 1'-0"

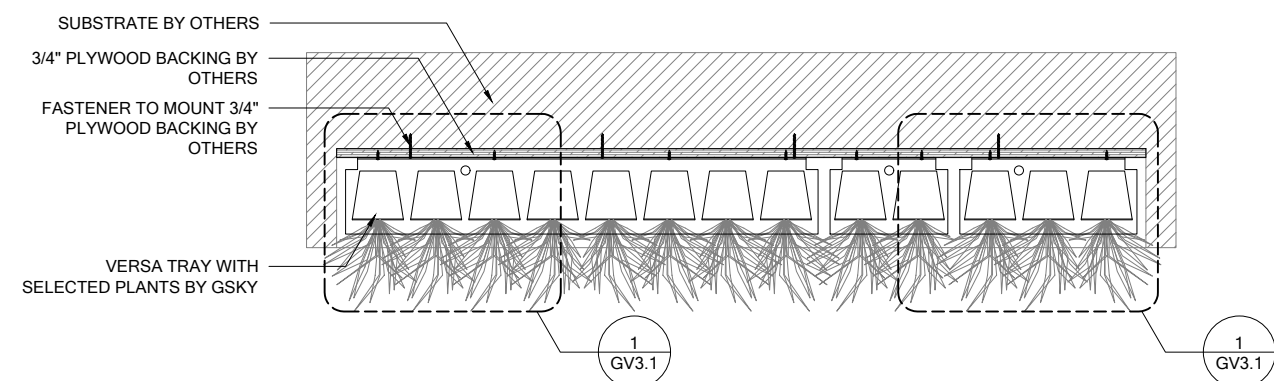

**2 PLAN**  
SCALE 3/4" = 1'-0"



**VERSA WALL**<sup>®</sup>  
VAH-NN GENERAL OVERVIEW  
VER. 1.1      11x17" (A3)

**ABOVE FLOOR**  
Weight is 10lbs/ft<sup>2</sup> 50kg/m<sup>2</sup>

- SIDE/TOP  
- BOTTOM  
**NO TRIM**  
NOTE: edges of trays will be exposed unless recessed or covered.

**HAND WATER**  
For 10 - 50 ft<sup>2</sup> / 1 - 5 m<sup>2</sup>  
Min width 10" / 25cm

SERVICE			
MANUAL	Not Req'd	Not Req'd	Not Req'd
AUTOMATED	N/A	N/A	N/A

**LIGHTING**  
LED or Metal Halide Lights recommended  
Duration: 10-12 hrs/day  
Color Temp: 4000-4500K  
Intensity: 150fc / 1500 lux (Even Flood)

< 8'	OK			
< 13'				
> 13'				

**MAINT. ACCESS**  
Wall height should not exceed 8'.  
See GSky maintenance manual.

**GV1.0**

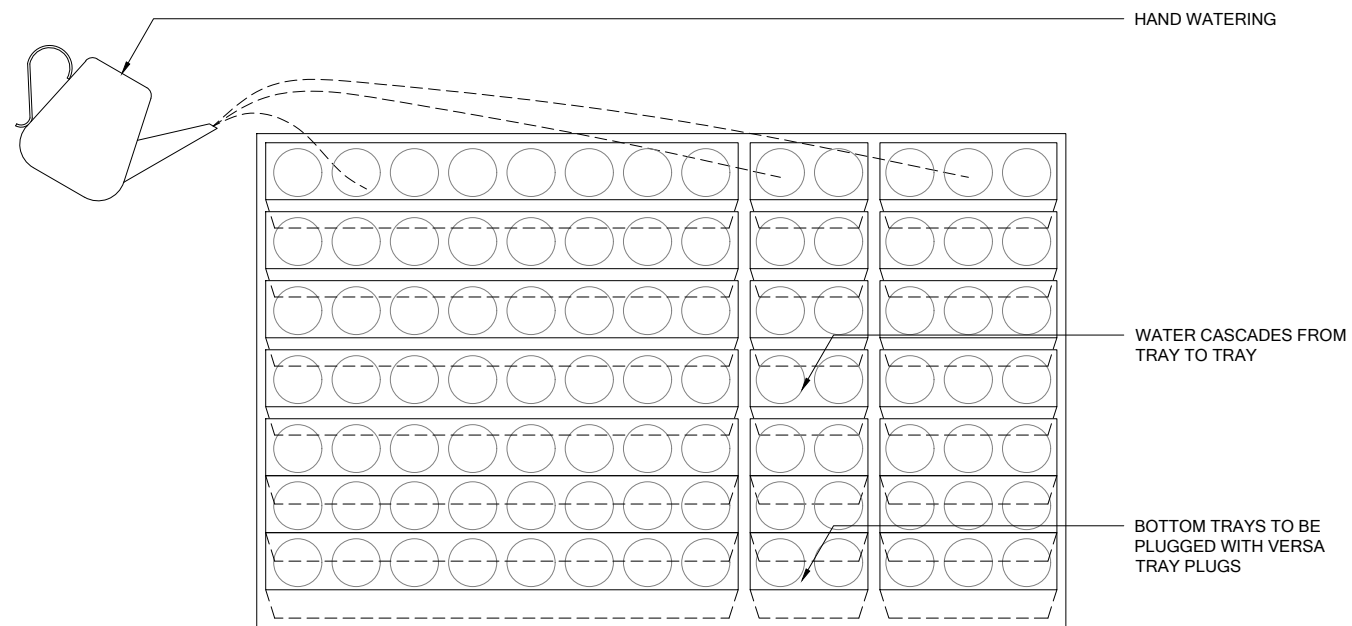

WARNING! BE CAREFUL NOT TO ADD TOO MUCH WATER AS IT MAY CAUSE OVERFLOW.

1 ELEVATION  
SCALE 3/4" = 1'-0"

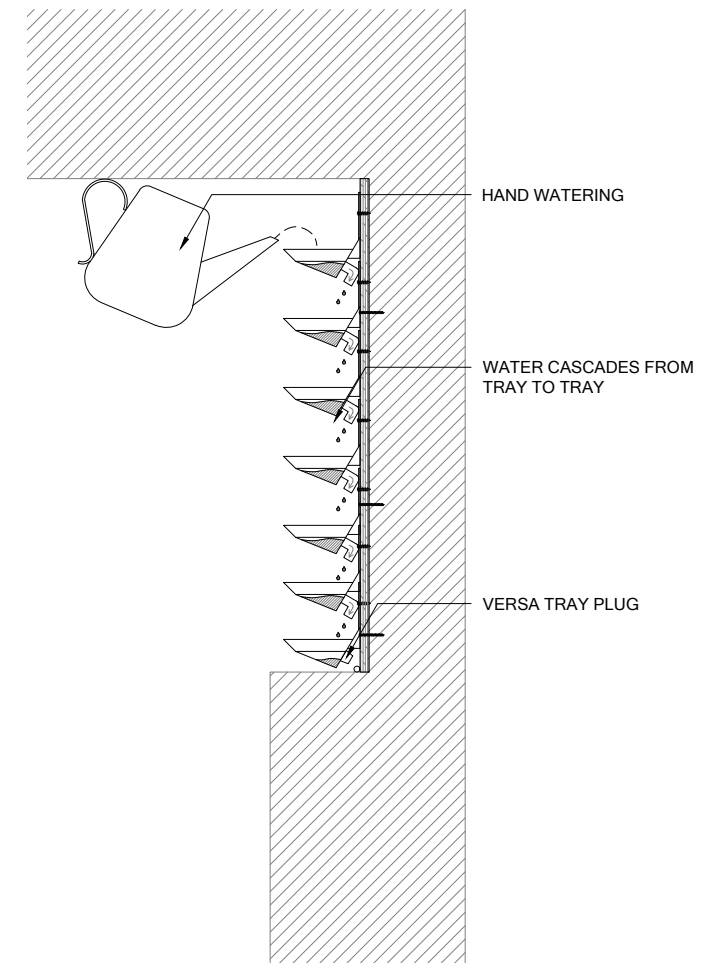

2 SECTION  
SCALE 3/4" = 1'-0"





**VERSA WALL**<sup>®</sup>  
VAH-NN IRRIGATION OVERVIEW  
VER. 1.1      11x17" (A3)

**ABOVE FLOOR**  
Weight is 10lbs/ft<sup>2</sup> 50kg/m<sup>2</sup>

- SIDE/TOP  
- BOTTOM  
**NO TRIM**  
NOTE: edges of trays will be exposed unless recessed or covered.

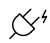
  
**HAND WATER**  
For 10 - 50 ft<sup>2</sup> / 1 - 5 m<sup>2</sup>  
Min width 10" / 25cm

SERVICE			
MANUAL	Not Req'd	Not Req'd	Not Req'd
AUTOMATED	N/A	N/A	N/A

**IRRIGATION**  
It is recommended to install a drain whenever possible

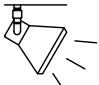
  
**LIGHTING**  
LED or Metal Halide Lights recommended

Duration	Color Temp
10-12 hrs/day	4000-4500K
Intensity	
150fc / 1500 lux (Even Flood)	

**MAINT. ACCESS**  
Wall height should not exceed 8'. See GSky maintenance manual.

Height	Access
< 8'	OK
< 13'	
> 13'	

**GV2.0**

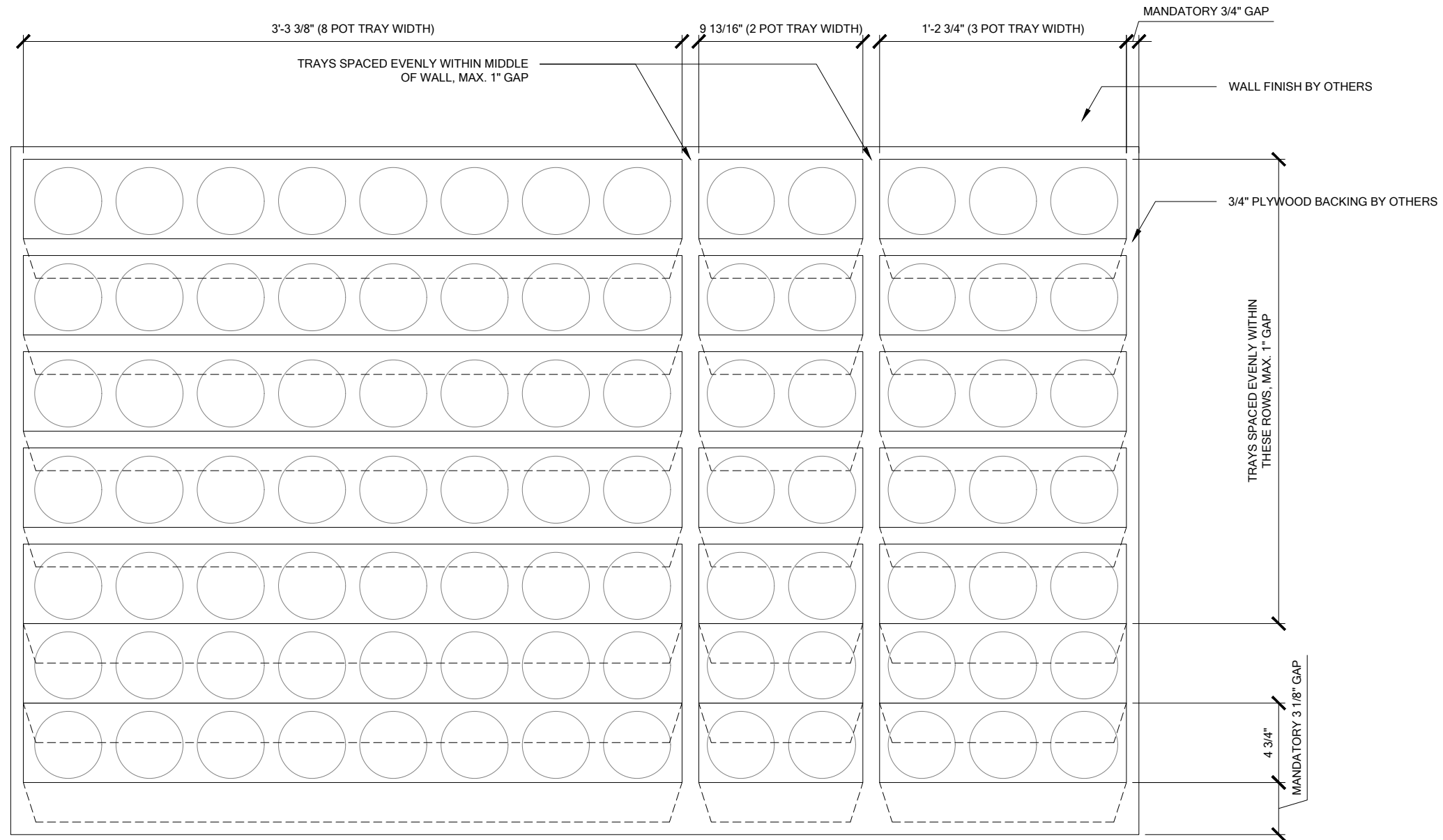

**1 TRAY LAYOUT**  
SCALE 1 1/2" = 1'-0"



**VERSA WALL®**

VAH-NN TRAY LAYOUT

VER. 1.1

11x17" (A3)



**ABOVE FLOOR**

Weight is 10lbs/ft² 50kg/m²

-	SIDE/TOP
-	BOTTOM

**NO TRIM**

NOTE: edges of trays will be exposed unless recessed or covered.

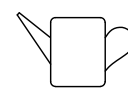

**HAND WATER**

For 10 - 50 ft² / 1 - 5 m²  
Min width 10" / 25cm

SERVICE			
MANUAL	Not Req'd	Not Req'd	Not Req'd
AUTOMATED	N/A	N/A	N/A

**IRRIGATION**

It is recommended to install a drain whenever possible



**LIGHTING**

LED or Metal Halide Lights recommended

Duration  
10-12 hrs/day  
Color Temp  
4000-4500K  
Intensity  
150fc / 1500 lux  
(Even Flood)

< 8'	OK		
< 13'			
> 13'			

**MAINT. ACCESS**

Wall height should not exceed 8'. See GSKY maintenance manual.

**GV3.0**

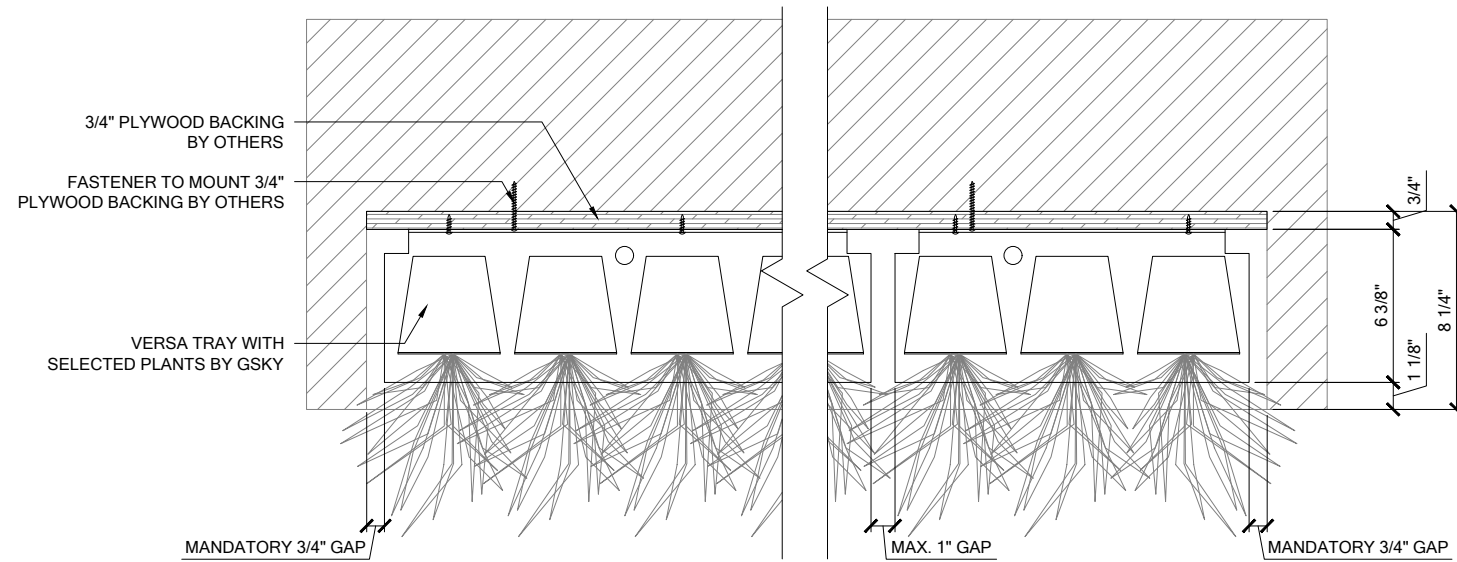

**1 PLAN**  
SCALE 1 1/2" = 1'-0"

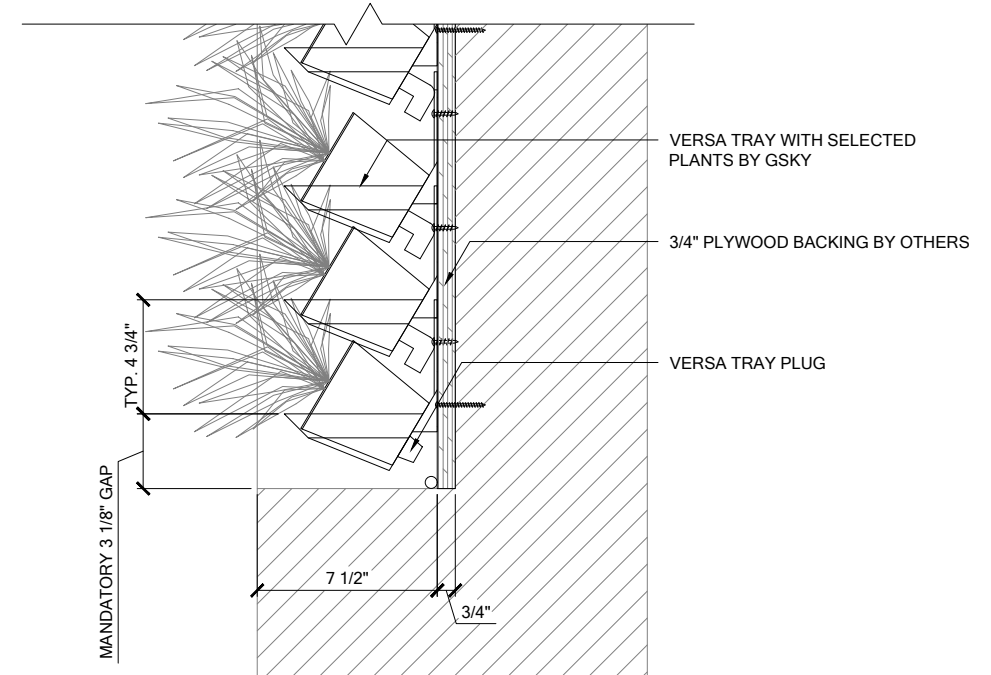
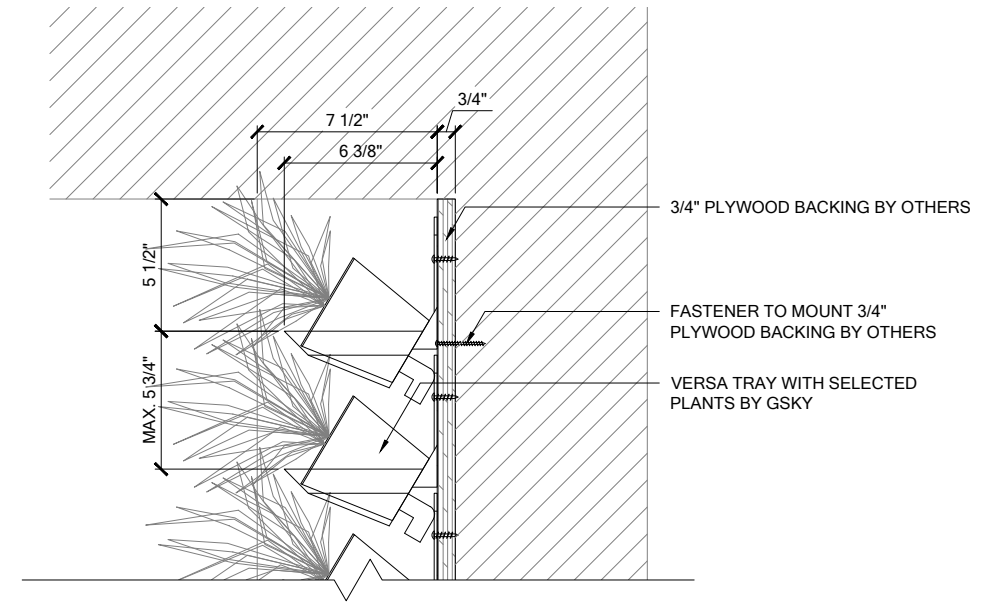

**2 SECTION**  
SCALE 1 1/2" = 1'-0"



# VERSA WALL®

VAH-NN DETAILS

VER. 1.1

11x17" (A3)



**ABOVE FLOOR**

Weight is 10lbs/ft² 50kg/m²

-	SIDE/TOP
-	BOTTOM

**NO TRIM**

NOTE: edges of trays will be exposed unless recessed or covered.

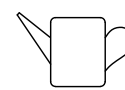

**HAND WATER**

For 10 - 50 ft² / 1 - 5 m²  
Min width 10" / 25cm

SERVICE			
MANUAL	Not Req'd	Not Req'd	Not Req'd
AUTOMATED	N/A	N/A	N/A

**IRRIGATION**

It is recommended to install a drain whenever possible



**LIGHTING**

LED or Metal Halide Lights recommended

Duration  
10-12 hrs/day  
Color Temp  
4000-4500K  
Intensity  
150fc / 1500 lux  
(Even Flood)

< 8'	OK		
< 13'			
> 13'			

**MAINT. ACCESS**

Wall height should not exceed 8'.  
See GSky maintenance manual.

**GV3.1**